

Thank you for purchasing this Factory Service Manual CD/DVD from servicemanuals4u.com.

Please check out our eBay auctions for more great deals on Factory Service Manuals:

[servicemanuals4u](http://servicemanuals4u.com)

maintenance & service guide

Presario 1200 Series

Models: XL101-XL113, XL115, XL118-XL127

Illustrated Parts Catalog

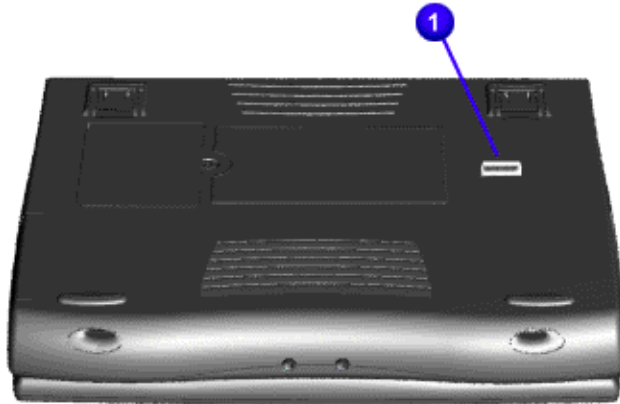

This section provides an illustrated parts breakdown and a reference for spare parts for the Presario 1200XL Series Notebook Computer.

The computer serial number should be provided to Compaq whenever requesting information or ordering spare parts. The serial number ① is located underneath the unit.

1.800.AT.COMPAQ

maintenance & service guide

Presario 1200 Series
Models: XL101-XL113, XL115, XL118-XL127

System Units



#	Description	Models XL-xxx	Spare Part Numbers		
❶	Keyboards	141706-xxx: Intl -002	US -001		
		UK -031	LA -161		
		Arab -041	JP -291		
		NL -331	TW -AB3		
		Fr Can -123	Greek -041		
		Denmark -081	Sweden -101		
		Norway -091	Swiss/Ger -AF1		
		171003-xxx: US -001	UK -031		
		IT -061	JP -291		
		NL -331	TW -AB3		
❷	Palmrest w/Touchpad & Button Bd	102, 111, 115, 119, 120-122	142653-001		
		107, 110, 118, 123-127	142654-001		
		103-106, 109	161416-001		
❸	Upper CPU Cover w/ Power Switch	all	158799-001		
		❹	Speakers w/Enclosure and Cables	all	148108-001
				❺	Chassis/ Enclosure Base
❻	Battery Pack	102, 104-108, 110	388647-001		
		102, 104-108, 110, 115, 118, 120-124	388648-001		
		111, 119, 125-127	138184-001		

maintenance & service guide

Presario 1200 Series
Models: XL101-XL113, XL115, XL118-XL127

System Boards

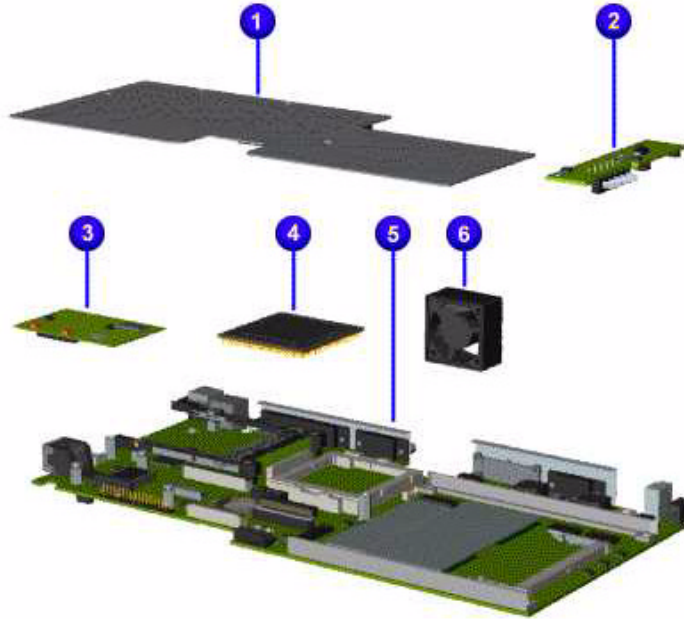

#	Description	Models XL-xxx	Spare Part Number
❶	Heatspreader	all	158802-001
❷	Voltage Converter Board (3C)	all	352891-001
❸	56K Data/Fax Modems w/o SRAM	102, 104-108, 110-111, 115, 118, 125-127	400445-001
	56K Data/Fax Modems w/o SRAM -Intl	119-124	143848-001
❹	450MHz AMD K6II Processor	102-105, 109	159548-001
	475MHz AMD 2V K6II Processor	104, 106-108, 110, 115, 119, 122	161064-001
	500MHz 2.1V K6II Processor	111, 118, 120-121, 123-124	173534-001
	533MHz K6II Processor	125-127	201542-001

maintenance & service guide

Presario 1200 Series
Models: XL101-XL113, XL115, XL118-XL127

#	Description	Models XL-xxx	Spare Part Number	
⑤	System I/O Bd 512K Cache 32MB	102, 104-106	158793-001	
	System I/O BD 512K Cache 32MB HPA WL	120	212217-001	
	System I/O BD 512K Cache 64MB	102, 104, 105	158794-001	
	System I/O BD 512K Cache 64MB HPA NB		212200-001	
	System I/O BD 512K Cache 64MB HPA WL	121-124	212218-001	
	System I/O BD 1.0M Cache 32MB	108, 110	169606-001	
	System I/O BD 1.0M Cache 64MB	108, 110	169607-001	
	System I/O BD 1.0M Cache 64MB LVDS, TFT	108, 110-111, 119	169608-001	
	System I/O BD 1.0M Cache 64MB LVDS		173539-001	
	System I/O BD 64MB LVDS	125	202071-001	
	System I/O BD 64MB HPA	126-127	202072-001	
	⑥	Fan Assembly A	all	158800-001
		Fan Assembly B	all	158801-001

maintenance & service guide

Presario 1200 Series
Models: XL101-XL113, XL115, XL118-XL127

Display Panel Assembly

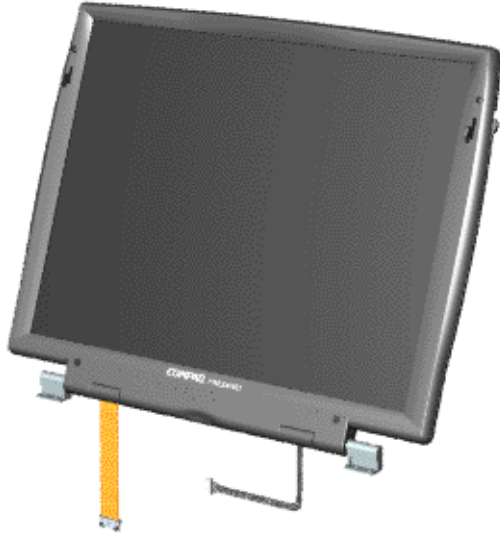

Description	Spare Part Number
Display Panel Assemblies	
12.1" HPA Models: XL102, 104, 115, 120-122	158795-001
12.1" TFT/LVDS Models: XL108, 110, 119	159038-001
12.1" TFT Models: XL119	173540-001
13.0" HPA Models: XL105-107, 118, 123-124, 126-127	158796-001
13.3" TFT/LVDS Models: XL111	173665-001

maintenance & service guide

Presario 1200 Series
Models: XL101-XL113, XL115, XL118-XL127

Mass Storage Devices

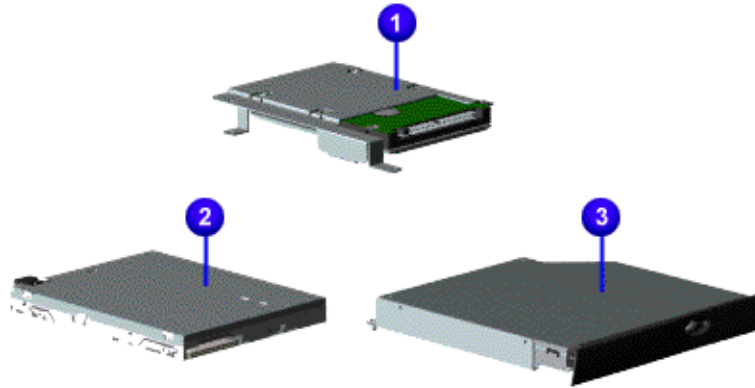

#	Description	Models XL-xxx	Spare Part Number
①	5.0GB Hard Drive	101-106, 112-113, 115, 120-122	169609-001
	6.0GB Hard Drive	107-111, 118-120, 123-127	170087-001
②	1.44MB Diskette Drive	all	141847-001
③	24X CD ROM Drive	102, 104-106, 108, 110, 115, 118-119, 120-124, 126-127	142307-001
④	6X DVD Drive (Not Shown)	108, 111, 125	169799-001

maintenance & service guide

Presario 1200 Series
Models: XL101-XL113, XL115, XL118-XL127

Miscellaneous Cables

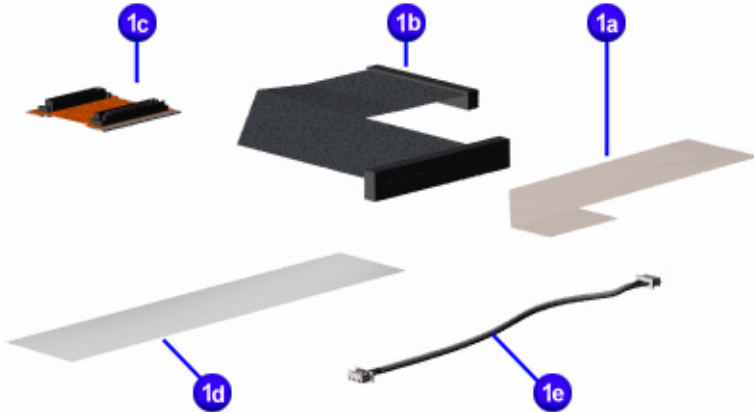

#	Description	Spare Part Number
	Miscellaneous Cable Kit*	330946-001
1a.	Diskette Drive Cable	
1b.	Hard Drive Cable	
1c.	CD Drive Cable	
1d.	TouchPad Cable	
1e.	Modem Cable	

**Kit includes one each of the above items unless quantity specified.*

maintenance & service guide

Presario 1200 Series
Models: XL101-XL113, XL115, XL118-XL127

Miscellaneous Hardware

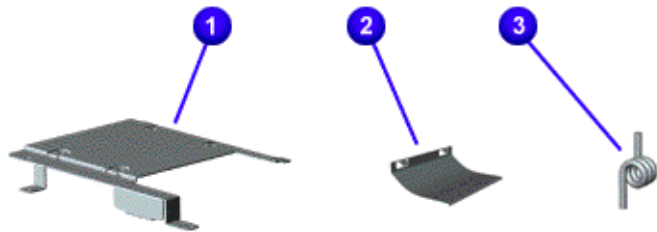

#	Description	Spare Part Number
	Miscellaneous Hardware Kit*	346853-001
①	1. Hard Drive Mounting Bracket	
②	2. LCD Guide FPC	
③	3. PCMCIA Torsion Spring (qty. 4)	

**Kit includes one each of the above items unless quantity specified.*

Miscellaneous Plastics

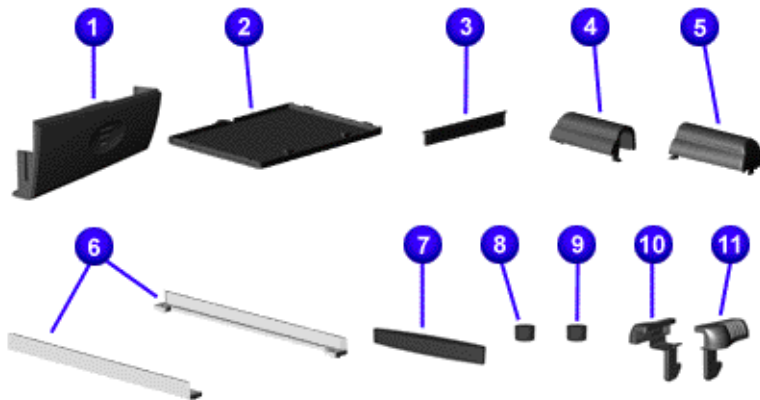

#	Description	Spare Part Number
	Miscellaneous Plastics Kit*	142657-001
①	Battery Compartment Door	
②	Memory Module Cover	
③	PCMCIA Door	
④	Display Hinge Cover (L)	
⑤	Display Hinge Cover (R)	
⑥	CD Drive Guides	
⑦	Rubber Plug (A) (qty. 4)	
⑧	Rubber Plug (B) (qty. 4)	
⑨	Rubber Foot (qty. 8)	
⑩	Latch (R) (qty. 3)	
⑪	Latch (L) (qty. 3)	
⑫	Stand Foot (not shown) (qty. 2)	

**Kit includes one each of the above items unless quantity specified.*

maintenance & service guide

Presario 1200 Series
Models: XL101-XL113, XL115, XL118-XL127

Miscellaneous Plastics



#	Description	Models XL-xxx	Spare Part Number
❶	AC Adapter 60W Slim 3-Wire	120-122	180675-001
	AC Adapter 60W Slim 2-Wire	123-127	180676-001
	AC Adapter 60W, 19V, 3.16Amp	102, 104-108, 111, 115, 118-119	298239-001
❷	AC Power Cord 3-Wire (Not Shown)		170513-xxx
	-US	110, 120-121	US -001
	-Intl	122	Intl -002
	-AU	121	AU -011
	-IT		IT -061
	-Swiss/German		S/G -115
	-UK	122	UK -031
	AC Power Cord NA (Not Shown)	104-108, 110-111, 115, 118, 125-127	293831-001
	AC Power Cord LA/Intl (Not Shown)	102, 104-108, 110	293831-002
	AC Power Cord JP (Not Shown)	123-124	293831-291

maintenance & service guide

Presario 1200 Series
Models: XL101-XL113, XL115, XL118-XL127

Spare Parts Not Shown

Parts Description	Models XL-xxx	Spare Part Number
32MB PC100 S.O. DIMM Memory	126-127	122699-001
FPC Cable Connector to Interface Board	102, 104-108, 110-111, 119, 125	152186-001
Battery Calibration Card	120-127	401512-003
Miscellaneous Screw Kit	all	330959-001
Logo Kit	all	169610-001
Logo Plate	104-106	166183-001
Return Kit	all	293799-001

Documentation and Software

Description		Spare Part Numbers
Quick Restore CD	153115-xx1	
Arab Emirates -171	Belgium AK1/-KK1	Denmark -081
France -051	Italy -061	Neatherlands -331
Norway -091	Portugal -131	Spain -071
Sweden -101	UK -031	
Reference Guide	117894-xx2	
Arab Emirates -032	Belgium -052/-332	Canada -002
Denmark -082	France -052	Fr-Canada -122
Italy -062	Japan -292	Mexico -162
Neatherlands -332	Norway -092	Portugal -202
Puerto Rico/Caribbean -002		Spain -162
Sweden -102	UK -032	US -002
Feature Guide		153325-xx1