

PCG-F340/F350/F360

SERVICE MANUAL

*US Model
Canadian Model*

Ver 2-2001G

All the supplementary information are attached at the end of data files.

[Update List](#)

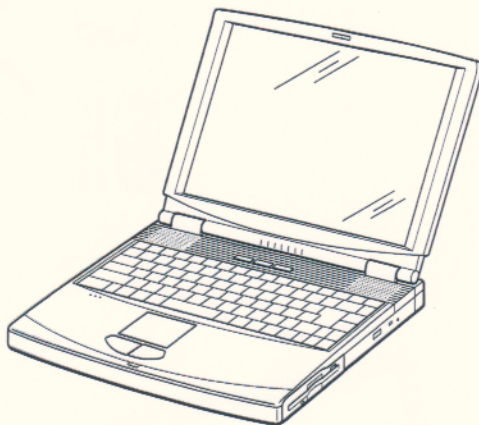

ILLUST : PCG-F350/F360



Information in this document is subject to change without notice.

Sony and VAIO are trademarks of Sony. Intel logo and Intel Inside logo are registered trademarks of Intel Corporation. Pentium MMX is a trademark of Intel Corporation. Microsoft, MS-DOS, Windows, the Windows 95 and Windows 98 logo are trademarks of Microsoft Corporation.

All other trademarks are trademarks or registered trademarks of their respective owners. Other trademarks and trade names may be used in this document to refer to the entities claiming the marks and names or their products. Sony Corporation disclaims any proprietary interest in trademarks and trade names other than its own.

Caution Markings for Lithium/Ion Battery - The following or similar texts shall be provided on battery pack of equipment or in both the operating and the service instructions.

CAUTION: Danger of explosion if battery is incorrectly replaced. Replace only with the same or equivalent type recommended by the manufacturer. Discard used batteries according to the manufacturer's instructions.

CAUTION: The battery pack used in this device may present a fire or chemical burn hazard if mistreated. Do not disassemble, heat above 100°C (212°F) or incinerate. Dispose of used battery promptly. Keep away from children.



Service and Inspection Precautions

1. Obey precautionary markings and instructions

Labels and stamps on the cabinet, chassis, and components identify areas requiring special precautions. Be sure to observe these precautions, as well as all precautions listed in the operating manual and other associated documents.

2. Use designated parts only

The set's components possess important safety characteristics, such as noncombustibility and the ability to tolerate large voltages. Be sure that replacement parts possess the same safety characteristics as the originals. Also remember that the Δ mark, which appears in circuit diagrams and parts lists, denotes components that have particularly important safety functions; be extra sure to use only the designated components.

3. Always follow the original design when mounting parts and routing wires

The original layout includes various safety features, such as inclusion of insulating materials (tubes and tape) and the mounting of parts above the printer board. In addition, internal wiring has been routed and clamped so as to keep it away from hot or high-voltage parts. When mounting parts or routing wires, therefore, be sure to duplicate the original layout.

4. Inspect after completing service

After servicing, inspect to make sure that all screws, components, and wiring have been returned to their original condition. Also check the area around the repair location to ensure that repair work has caused no damage, and confirm safety.

5. When replacing chip components...

Never reuse components. Also remember that the negative side of tantalum capacitors is easily damaged by heat.

6. When handling flexible print boards...

- The temperature of the soldering-iron tip should be about 270C.
- Do not apply the tip more than three times to the same pattern.
- Handle patterns with care; never apply force.

Caution: Remember that hard disk drives are easily damaged by vibration. Always handle with care.

ATTENTION AU COMPOSANT AYANT RAPPORT À LA SÉCURITÉ!

LES COMPOSANTS IDENTIFIÉS PAR UNE MARQUE Δ SUR LES DIAGRAMMES SCHÉMATIQUES ET LA LISTE DES PIÈCES SONT CRITIQUES POUR LA SÉCURITÉ DE FONCTIONNEMENT. NE REMPLACER CES COMPOSANTS QUE PAR DES PIÈCES SONY DONT LES NUMÉROS SONT DONNÉS DANS CE MANUEL OU DANS LES SUPPLÉMENTS PUBLIÉS PAR SONY.

TABLE OF CONTENTS

<u>Section</u>	<u>Title</u>	<u>Page</u>	<u>Section</u>	<u>Title</u>	<u>Page</u>
CHAPTER 1. REMOVAL			CHAPTER 2. SELF DIAGNOSTICS		
1-1.	Flowchart	1-1	2-1.	Required Tools and Peripheral Devices	2-1
1-2.	Main Electrical Parts Location Diagram	1-1	2-2.	Tools and Peripheral Device Connection	2-3
1-3.	Removal	1-2	2-3.	How to Start the Diagnostics	2-4
1.	Hinge Cover	1-2	2-4.	Test Items	2-4
2.	Keyboard Unit, Palm Rest Housing Assy, Assy Hood Keyboard	1-2	1.	Start Menu	2-4
3.	Display Assy, CD-ROM Drive	1-3	2.	PCG-F3 Series Diagnostics	2-4
4.	DC Fan, SWX-28 Board	1-3	3.	Short Descriptions of the Test Items	2-5
5.	HDD Assy, PWS-5 (-2) Board, Latch Detector Unit, SWX-30 (-2) Board	1-4	2-5.	About the PASSWORD Bypass	2-8 (to 2-8)
6.	PC Card Connector, IFX-56 Board, CNX-50 Board, MPM-12 Board, MBX-15 (-2) Board	1-4	CHAPTER 3. BLOCK DIAGRAM		
7.	Battery, Lithium	1-5	3-1 (to 3-2)		
8.	Speaker Unit, SWX-29 Board	1-5	CHAPTER 4. FRAME HARNESS DIAGRAM		
9.	LCD Section (F350/F360 MODEL) (Made by Samsung)	1-6	4-1 (to 4-2)		
1.	Bezel Housing Assy, LCD Unit (14 inch), Display Housing Assy, Inverter Assy	1-6	CHAPTER 5. EXPLODED VIEWS AND PARTS LIST		
2.	Hinge Left, Hinge Right, LCD Cable	1-7	5-1		
10.	LCD Section (F350/F360 MODEL) (Made by Hitachi)	1-8	5-1.	Main Section	5-2
1.	Bezel Housing Assy, LCD Unit (14 inch), Display Housing Assy, Inverter Assy	1-8	5-2.	LCD Section (F350/F360 MODEL)	5-5
2.	Hinge Left, Hinge Right, LCD Cable	1-9	1.	LCD Made by Samsung	5-5
11.	LCD Section (F340 MODEL)	1-10	2.	LCD Made by Hitachi	5-7
1.	Bezel Housing Assy, LCD Unit (13 inch), Display Housing Assy, Inverter Assy	1-10	5-3.	LCD Section (F340 MODEL)	5-9 (to 5-10)
2.	Hinge Left, Hinge Right, LCD Cable	1-11	• Abbreviations		
(to 1-11)			UC : US model / Canadian model		

CHAPTER 1.

REMOVAL

1-1. Flowchart

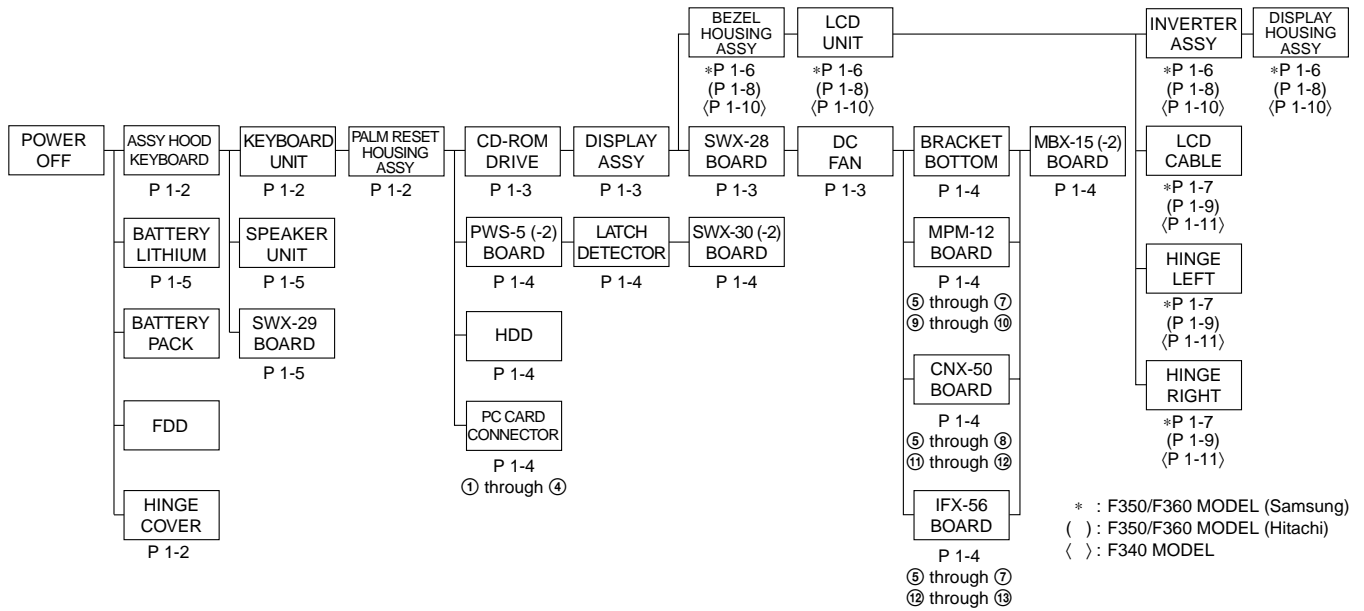

- P XX means pages that appears in this manual.
- Remember that hard disk drives are easily damaged by vibration. Always handle with care.

1-2. Main Electrical Parts Location Diagram

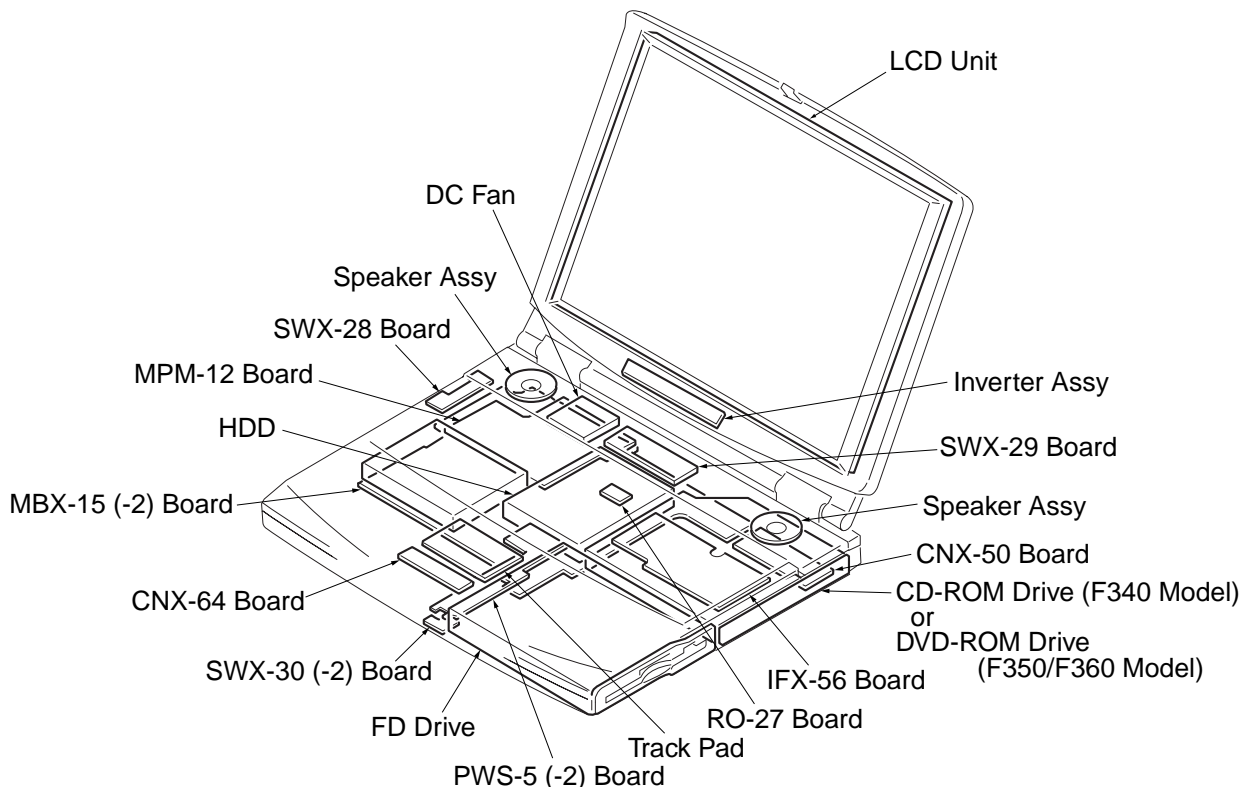

1-3. Removal

1. Hinge Cover

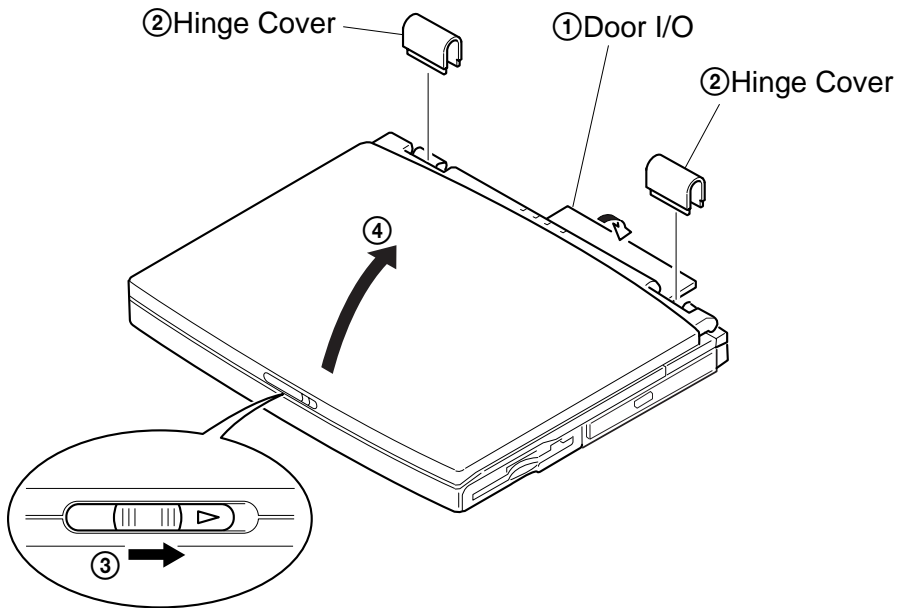

2. Keyboard Unit, Palm Rest Housing Assy, Assy Hood Keyboard

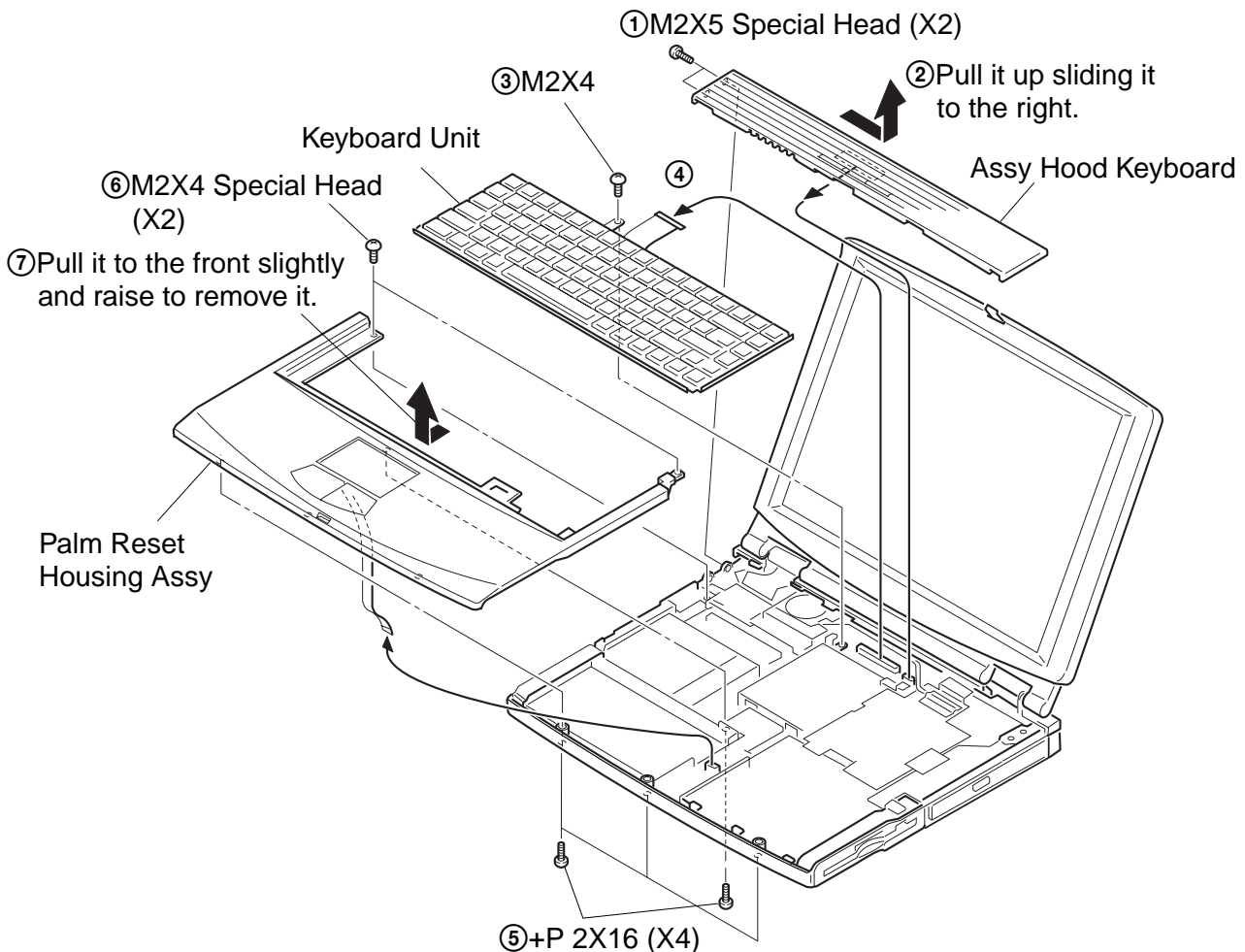

3. Display Assy, CD-ROM Drive

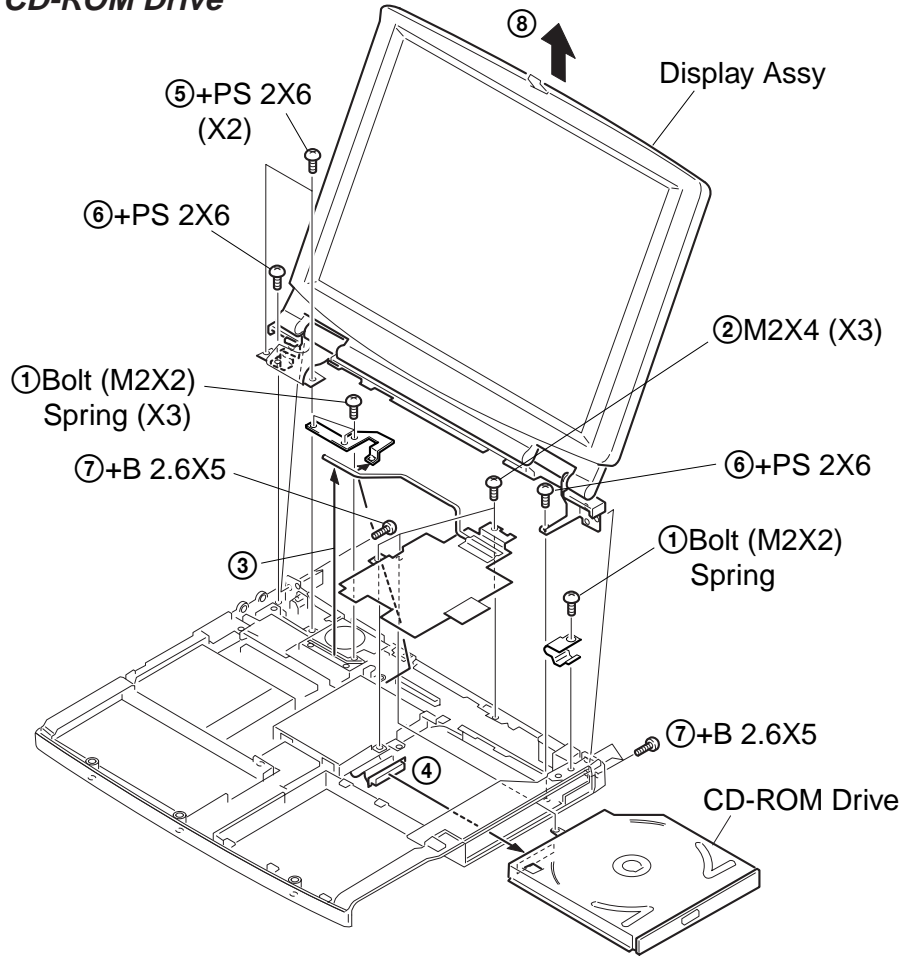

4. DC Fan, SWX-28 Board

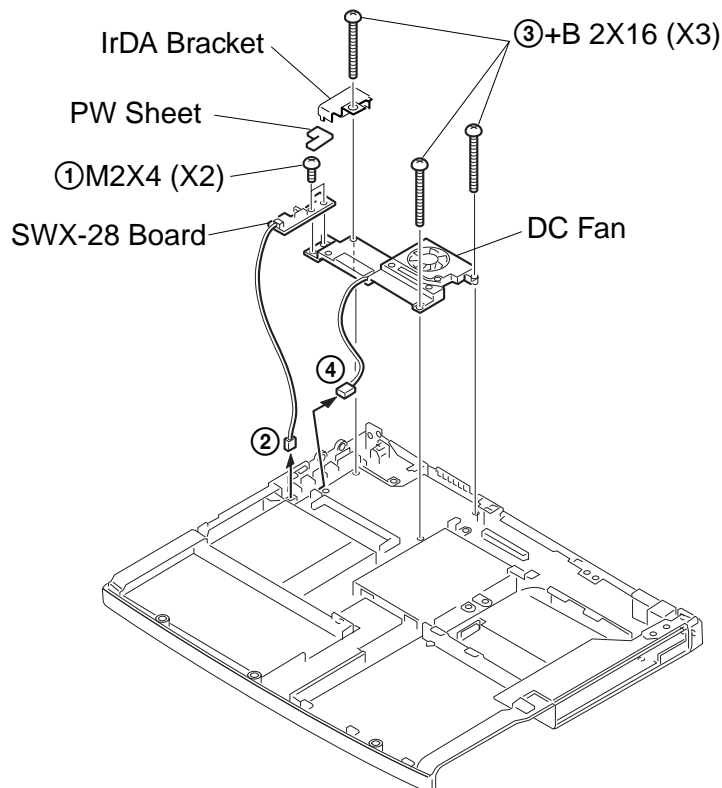

5. HDD Assy, PWS-5 (-2) Board, Latch Detector Unit, SWX-30 (-2) Board

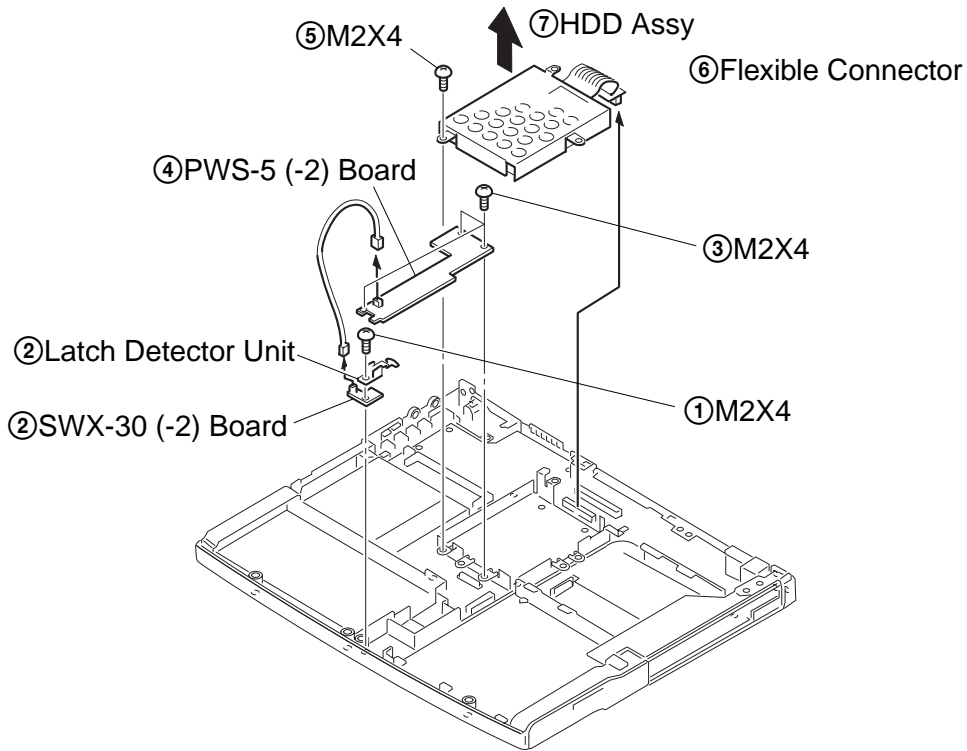

6. PC Card Connector, IFX-56 Board, CNX-50 Board, MPM-12 Board, MBX-15 (-2) Board

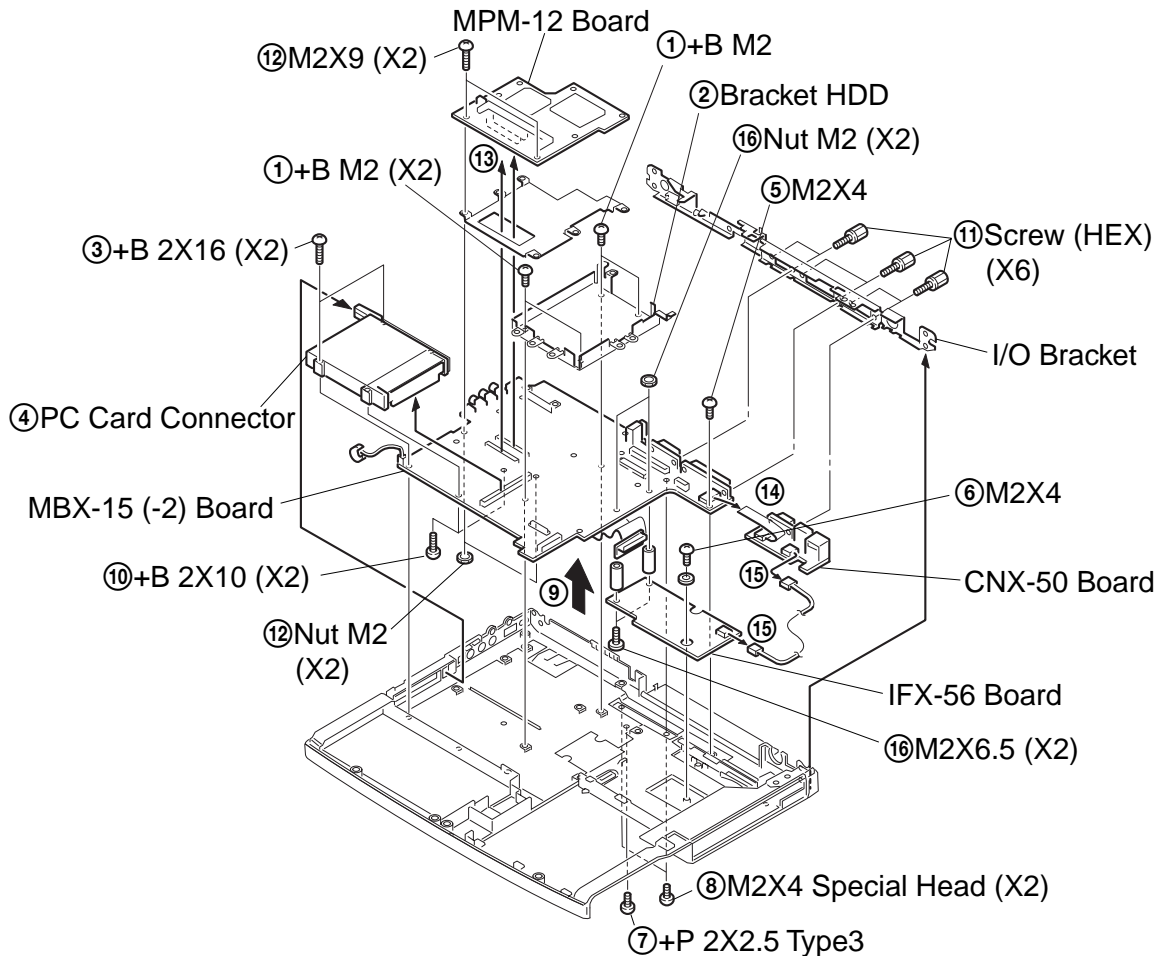

7. Battery, Lithium

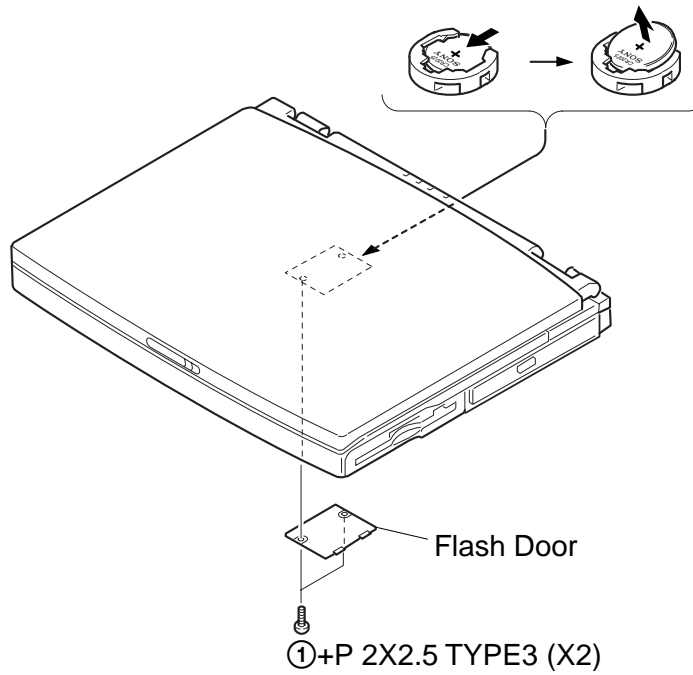

8. Speaker Unit, SWX-29 Board

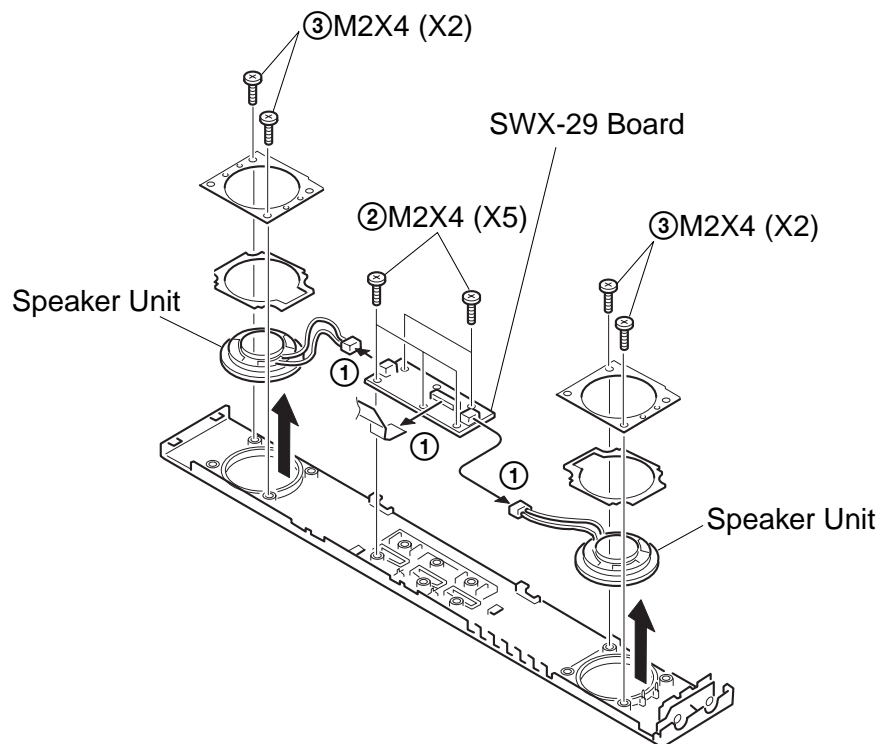

9. LCD Section (F350/F360 Model) (Made by Samsung)

1. Bezel Housing Assy, LCD Unit (14 inch), Display Housing Assy, Inverter Assy

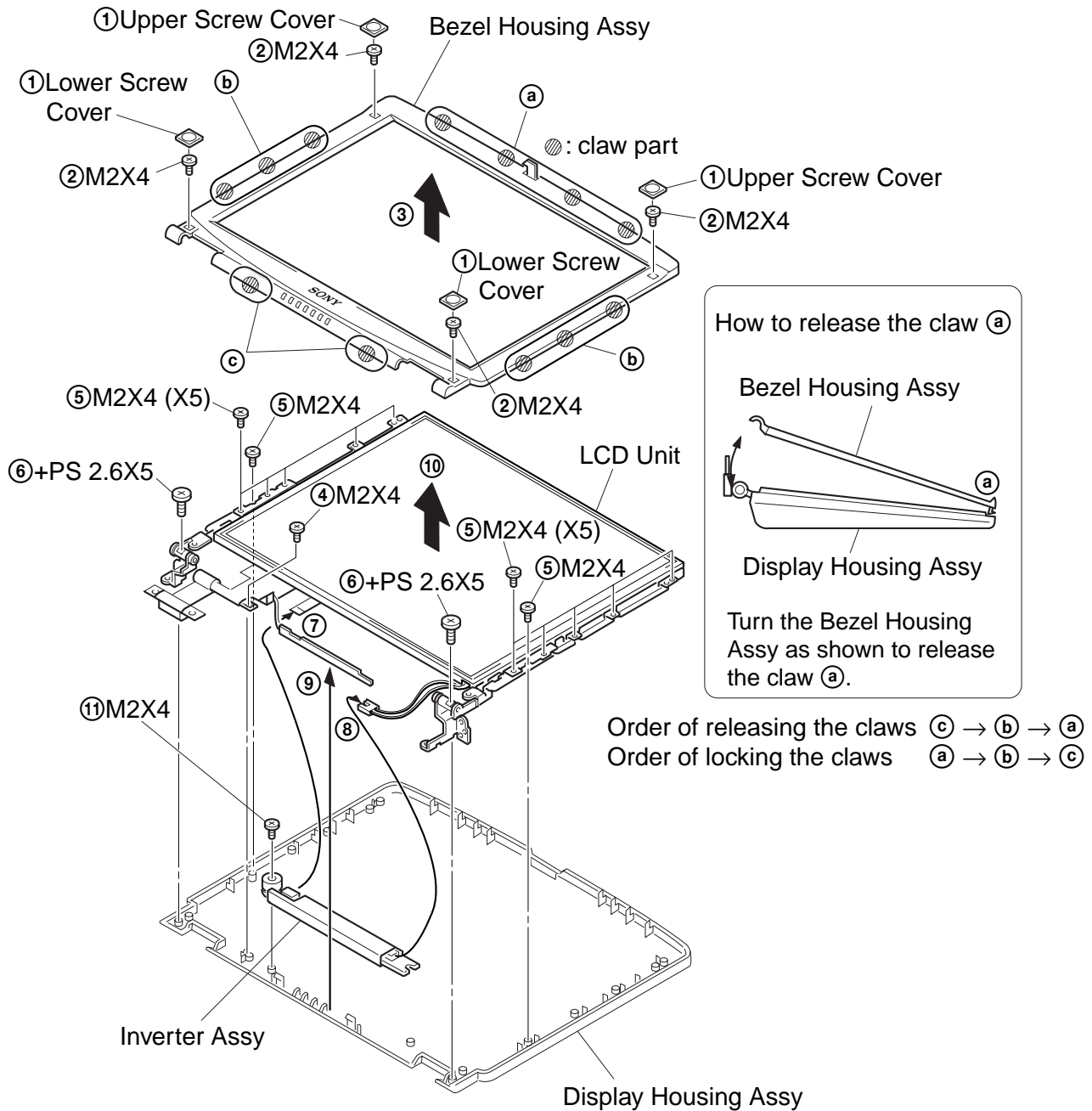

2. Hinge Left, Hinge Right, LCD Cable

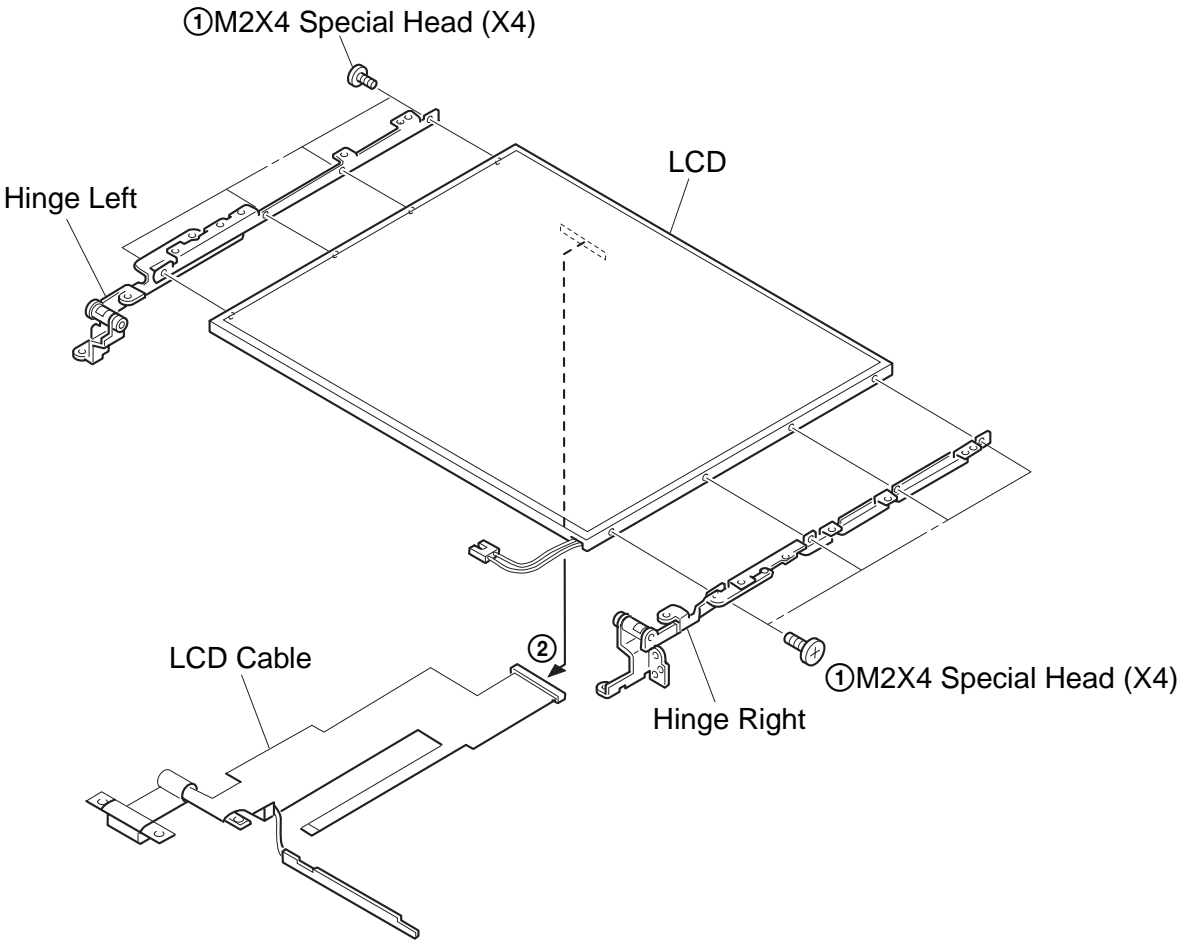

10. LCD Section (F350/F360 Model) (Made by Hitachi)

1. Bezel Housing Assy, LCD Unit (14 inch), Display Housing Assy, Inverter Assy

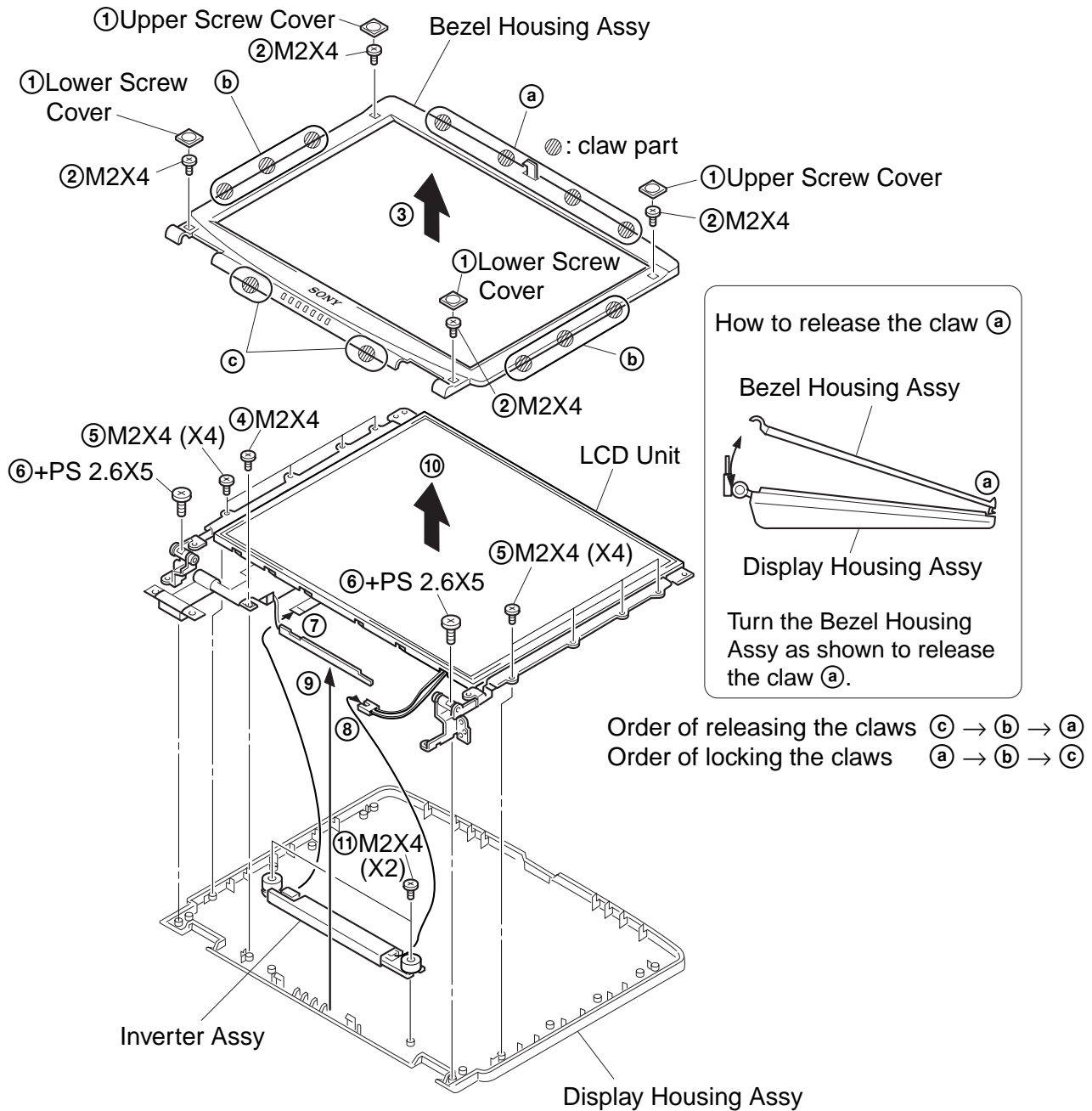

2. Hinge Left, Hinge Right, LCD Cable

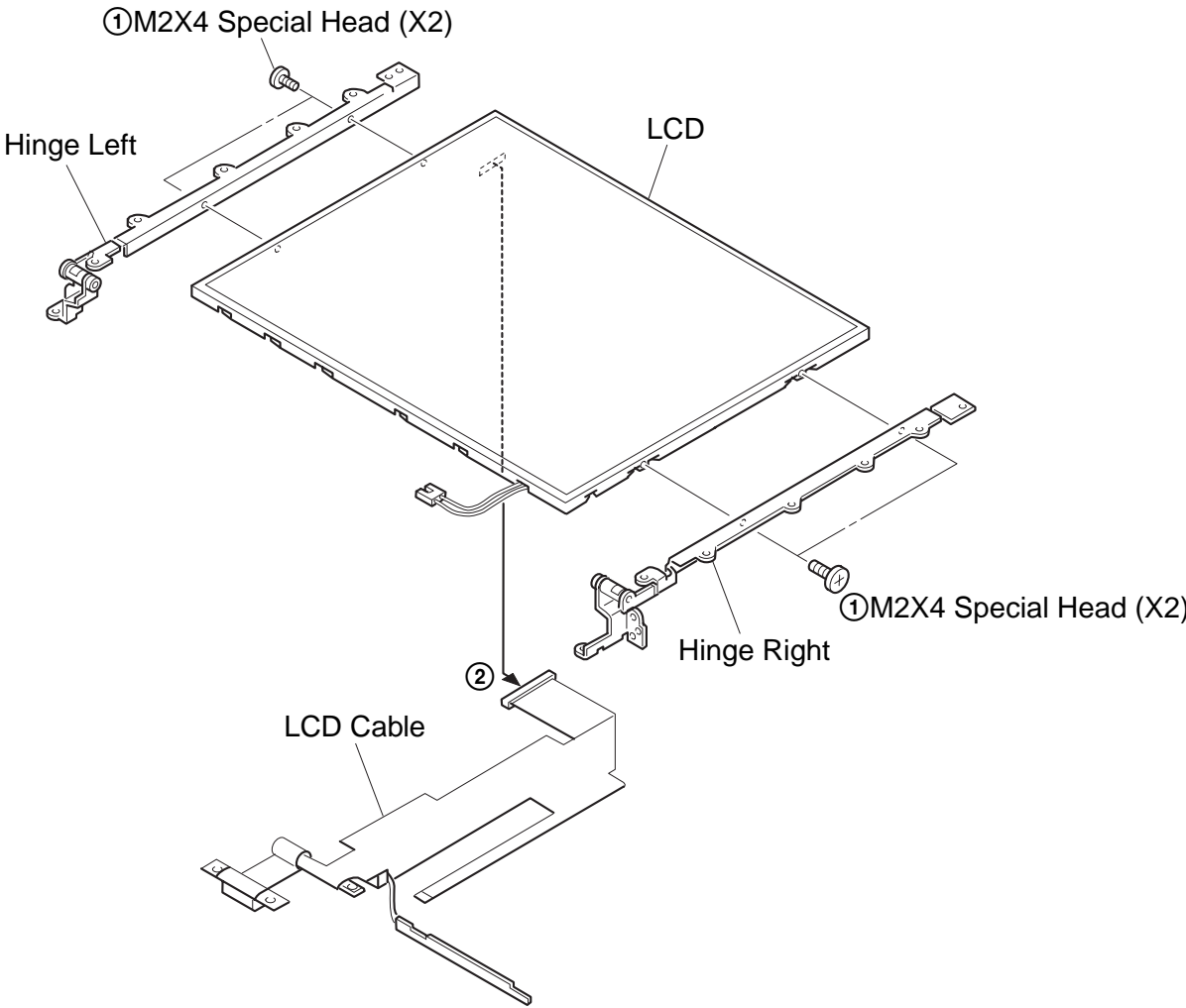

11. LCD Section (F340 Model)

1. Bezel Housing Assy, LCD Unit (13 inch), Display Housing Assy, Inverter Assy

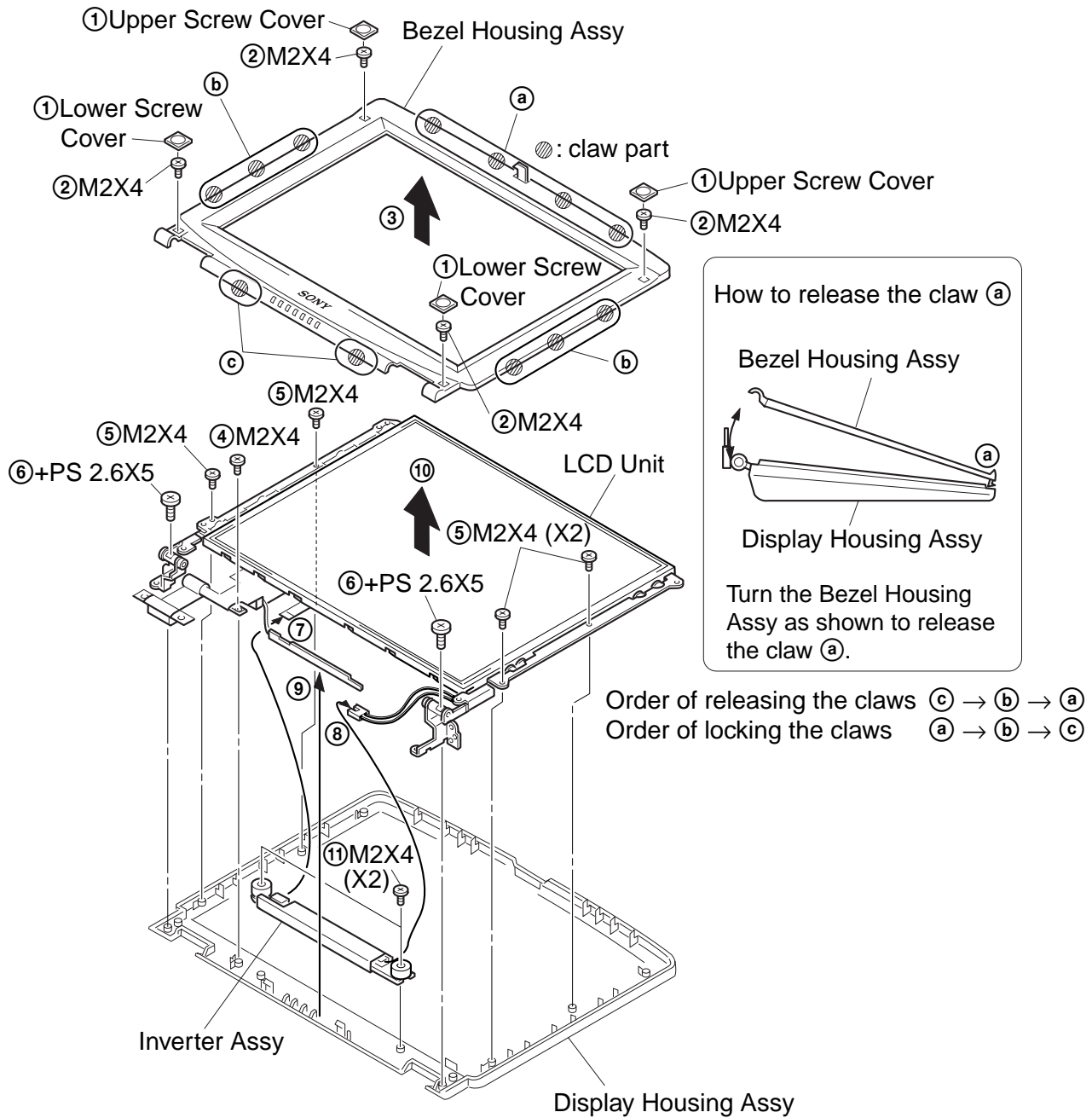

2. Hinge Left, Hinge Right, LCD Cable

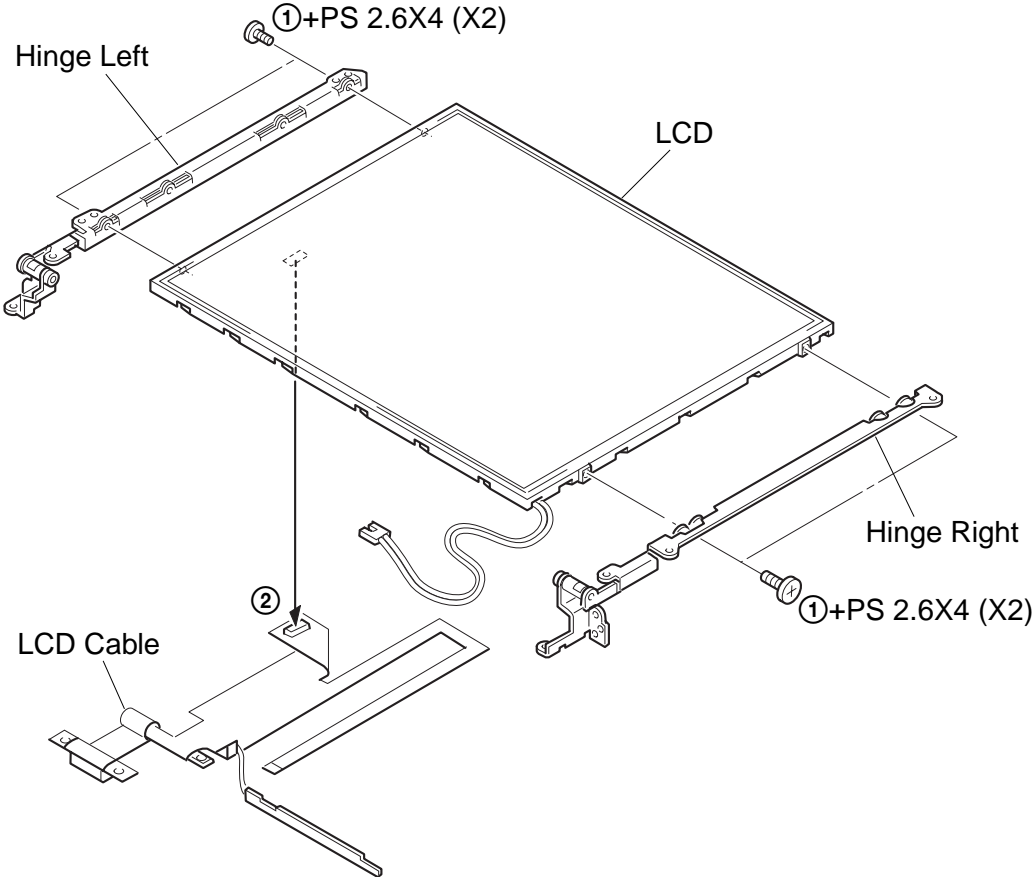

CHAPTER 2.

SELF DIAGNOSTICS

2-1. Required Tools and Peripheral Devices

	Tools and Peripheral Devices	Test Items
1	Serial Loopback Tool Loopback tool specified by QA and Factory (Refer to next page.)	Serial Port (COM) test
2	Parallel Loopback Tool Loopback Tool specified by QA and Factory (Refer to next page.)	Parallel Port (printer) test
3	V.34 Modem and Line Simulator	Modem test
4	VGA Monitor and Connection Cable	VGA output test
5	PC Card Tester PCCtest 450 Made by Sycard Corp.	PC Card test
6	USB Tester USB Host Production Tester Made by Computer Access Technology Corp.	USB device test
7	PCG-505G series VAIO for IrDA Function Test	IrDA Function test
8	Port Replicator PCGA-PRF1 for Port Replicator Connector Test	Port Replicator Connector test
9	FDD Bay supplied	FDD test
10	Diagnostics FD Media	(Diagnostics starting software)
11	Diagnostics CD-ROM Media	(Diagnostics software)
12	Battery supplied	Battery related tests
13	AC Adaptor supplied	(Power supply for diagnostics)
14	PCG-505G series VAIO for IEEE1394 Test	IEEE1394 Test

[Reference] On Serial/Parallel Loopback Tool

- The serial loopback tool and the parallel loopback tool are necessary for diagnostics of the serial communication line and the parallel communication line. Fabricate the serial loopback tool and the parallel loopback tool locally referring to the connection diagrams shown below.

Serial Loopback Tool : For diagnostics of serial port

SERIAL LOOPBACK CONNECTOR CONNECTION DIAGRAM

- Connector Types DB9S (Female)
- Interface Standard RS-232C
- Loopback Data & Handshake

NOTE: The black round mark "●" indicates soldering.

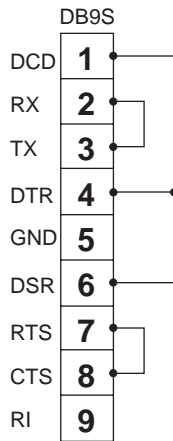

Parallel Loopback Tool : For diagnostics of parallel port

PARALLEL LOOPBACK CONNECTOR CONNECTION DIAGRAM

- Connector Types DB25P (Male)
- Interface Standard Centronics
- Loopback Status to Commands

NOTE: The black round mark "●" indicates soldering.

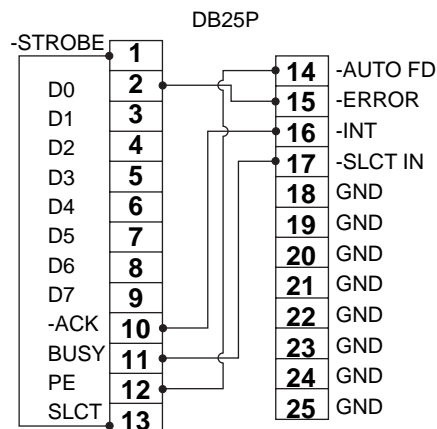

2-2. Tools and Peripheral Device Connection

System Connection Diagram

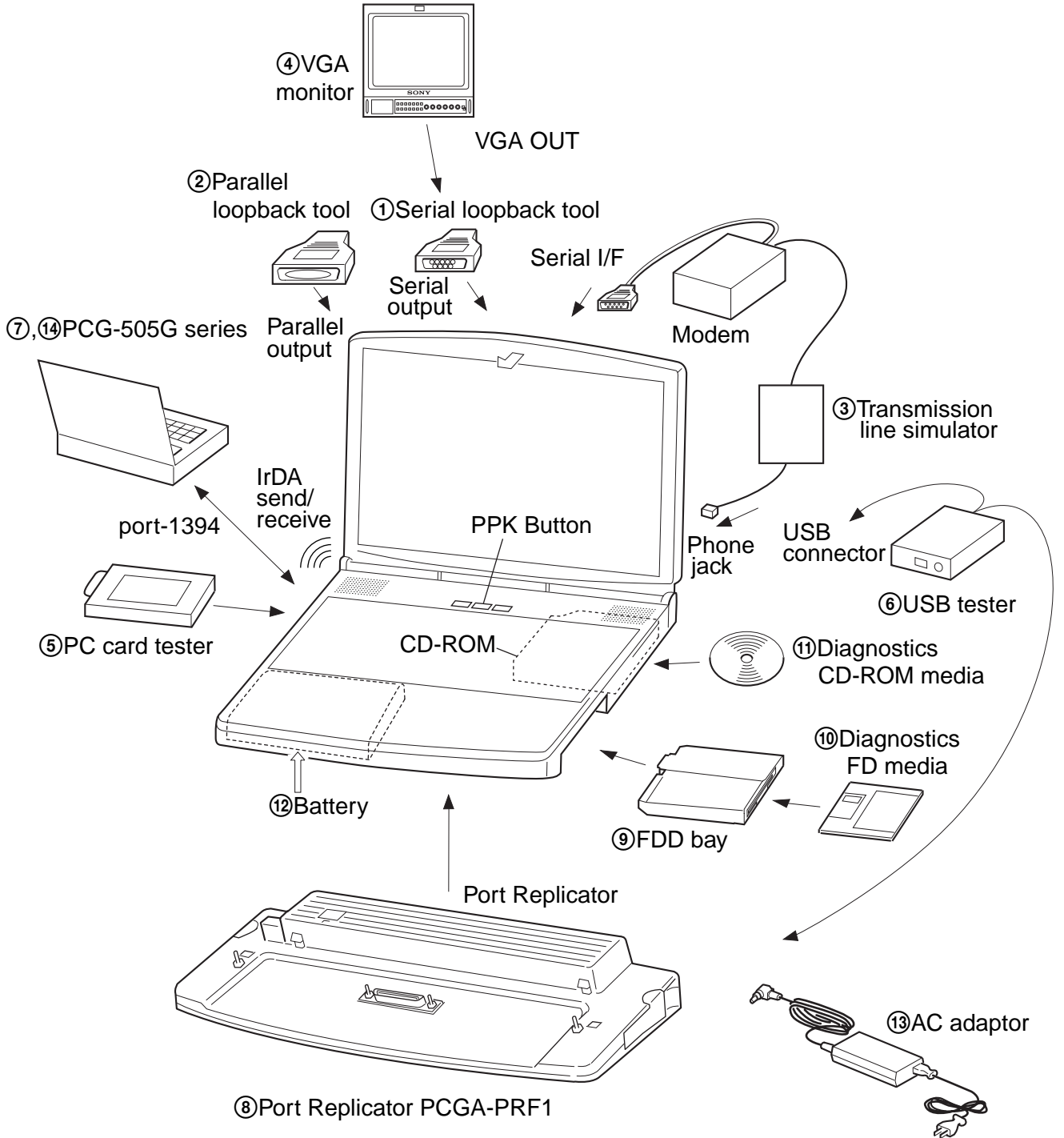

2-3. How to Start the Diagnostics

Precaution: The supplied floppy disk containing the diagnostics program can be damaged because it will be written the Log and used as FDD read-write test. Be sure to make a backup of the diagnostics floppy disk and use a backup disk for diagnostics.

Starting up the diagnostics

- Specify the FDD as the startup drive so that the system boots up from the diagnostics FD.
- Insert the diagnostics CD-ROM media into the CD-ROM bay. Insert the diagnostics FD into the FDD bay. Turn off the main power of the system once and back on to boot up the system from the diagnostics FD.
- When the system is booted from the diagnostics floppy disk, the start menu appears. Select a desired item to execute the diagnostics. When PASS is displayed as the result of diagnostics, the test is ended without any errors. When FAIL is displayed as the result of diagnostics, the test is ended with some errors.

2-4. Test Items

The test items are shown below.

2-4-1. Start Menu

1: Diagnostics for PCG-F3 Series

Select the respective test items of the PCG-F3 Series Diagnostics from the menu and perform the selected test.

2: PASSWORD BYPASS

The password which bypasses the PASSWORD is created.

3: Quit START MENU

Exits the diagnostics.

2-4-2. PCG-F3 Series Diagnostics

List of Test Items

The test items which are performed one after another or by selecting a specific item, are listed as follows. (Short descriptions of the respective test items follow later.)

1. Machine configuration
2. Check system bios revision
3. Check configuration
4. Battery test group
 - (1) Battery 1 test
 - (2) Battery 2 test
 - (3) Fan test
5. CD ROM test
6. FDD test
7. HDD test
8. Touch pad test
9. LED test
10. Main memory test
11. Main system test

12. Mouse test
13. Parallel loopback test
14. PC Card test
15. Serial loopback test
16. USB test
17. Port Replicator connector test
18. IrDA test
19. Video test
20. IEEE1394 test
21. PPK test
22. Aging (Short time) HDD test
23. Aging (Long time) HDD test
24. Aging (Short time)
25. Aging (Long time)

The following tests are performed using Windows 98.

- A. Audio test group
 - (1) Audio test (MIC test)
 - (2) Audio test (Speaker test)
- B. Modem loopback test

2-4-3. Short Descriptions of the Test Items

1. Machine configuration

Selects the type of configuration of the PCG-F3 series computer.
Because some diagnostics operate based on the selected configuration, perform this item first of all.
2. Check system bios revision

Indicates the BIOS which is currently used.
3. Check configuration

Tests clocks and CPUID.
4. Battery test group

Performs charging and discharging test of a battery.
A used battery with 30% to 80% already charged battery is necessary.

 - (1) Battery 1 test

This tests the battery 1.
 - (2) Battery 2 test

This tests the battery 2.

Start up the battery 2 test program only from the FD image from the DOS command line of the CD-ROM/DVD-ROM as described below.

Execute the following procedure and insert both the CD-ROM and FDD.

1. Selects "3: Quit MAIN MENU" from the main menu.

2. The ordinary DOS prompt "A:\>" appears. Input "G:[Enter]".
Then remove the FDD and insert the battery 2 instead of the FDD.
3. The prompt "G:\>PRG" appears and the active drive is changed. Input "CD \FD" to change directory.
4. When the prompt "G:\FD>" appears, input the command "BATT2".
5. The battery 2 test starts. Execute the battery 2 test by following the instructions that are displayed.
6. Remove the battery 2 from the bay and insert the FDD that is removed in step 2.
7. When the test is complete, the prompt returns to "G:\FD>". Input "A:" to change the drive.
8. Input "AUTOEXEC" to return to the main menu.

(3) Fan test

This tests the fan.

5. CD ROM test

Tests the CD-ROM.

6. FDD test

Tests the FDD. Note that the diagnostics floppy disk can be damaged when this test ends in fail.

7. HDD test

Tests the HDD.

8. Touch pad test

Tests the touch pad. Start pressing the keyboard surely from an end of a keyboard.
The Fn key is disabled. Press "Fn+End" instead.

9. LED test

Check that the LEDs start illuminating from the left of the LEDs.

10. Main memory test

Tests the memory.

11. Main system test

Tests the entire system including CPU, MATH and DMA.

12. Mouse test

Tests the mouse. Move the cursor inside the white square mark (□) and operate the system in accordance with instruction displayed.

13. Parallel loopback test

Tests the parallel (printer) port. The jig is necessary.
Connect the jig to the parallel port.

14. PC Card test

Tests the PC card. The PC card tester jig is necessary. Insert and remove the PC card tester in accordance with instruction displayed.

15. Serial loopback test

Tests the COM port. The serial loopback jig is necessary.
Connect the serial loopback jig to the COM port.

16. USB test

Tests the USB port. To perform this test, the USB jig is necessary.
Connect the USB jig to the USB port.

17. Port Replicator connector test

To perform this test, the port replicator and USB tester are necessary.

18. IrDA test

Tests the IrDA communication.
To perform this test, the PCG-505G series computer is necessary for communication.

19. Video test

Tests the circuit blocks related to the video display.
Tests the various video modes. A part of display is not shown as the video signal is displayed partly outside the screen in some tests of LCD (i.e., 1024 x 768 mode) when using the SVGA (800 x 600) displays. But this is normal.

20. IEEE1394 test

Executes the data transfer test of the IEEE1394.

21. PPK test

Tests the PPK.

22. Aging (Short time) HDD test

Executes the memory and main system tests repeatedly including the HDD test.
It takes about four hours. Contents of HDD are destroyed when this test is performed.

23. Aging (Long time) HDD test

Executes the memory and main system tests repeatedly including the HDD test.
It takes about ten hours. Contents of HDD are destroyed when this test is performed.

24. Aging (Short time)

Executes the memory and main system tests repeatedly. It takes about fifteen minutes.

25. Aging (Long time)

Executes the memory and main system tests repeatedly. It takes about ten hours.

A. Audio test group

Tests the audio related items.

(1) Audio test (MIC test)

Tests microphone.

(2) Audio test (Speaker test)

Tests speaker.

B. Modem loopback test

Tests the data send/receive between modem and computer. The jig modem is necessary.

Connect the jig modem to the modem port of the PCG-F3 series VAIO.

2-5. About the PASSWORD Bypass

When item “ 3: Return to START MENU ” of the start menu is selected, the following display appears.

```
Password Bypass Program
© 1999 Sony Corporation All rights reserved.
Input last 7 bytes of Serial number
(if serial xxxxxxxx-ooooooo , input serial number → ooooooo)
input serial number →
```

Enter the lower seven digits of the serial number of your system. Then the following message appears.

```
Bypassed pass word → @@@@ @@@
```

Enter the lower seven digits of the serial number of your system into the @@@@ @@@ portion of the password input display.

CHAPTER 3. BLOCK DIAGRAM

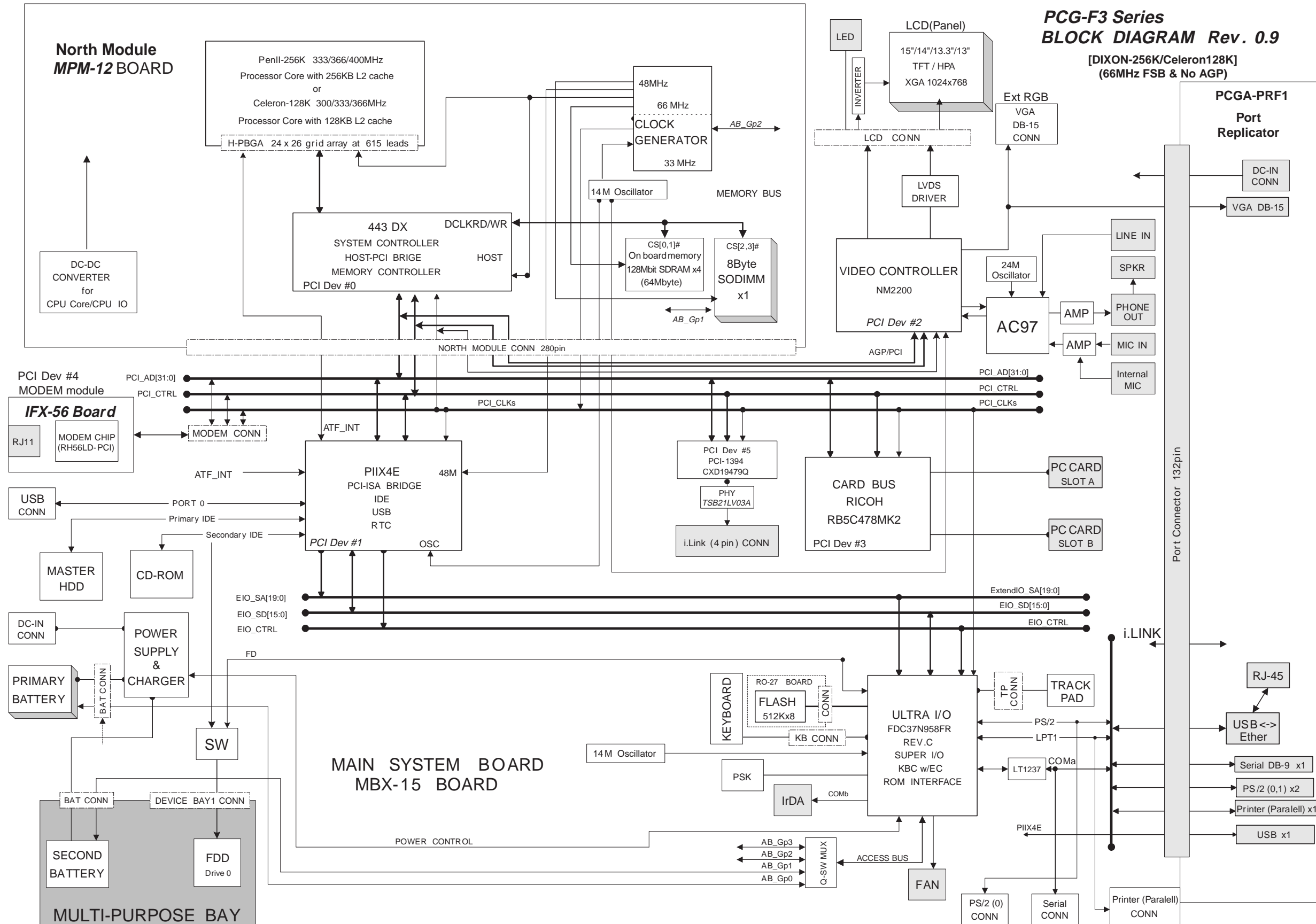

**PCG-F3 Series
BLOCK DIAGRAM Rev. 0.9**
[DIXON-256K/Celeron128K]
(66MHz FSB & No AGP)

CHAPTER 4. FRAME HARNESS DIAGRAM

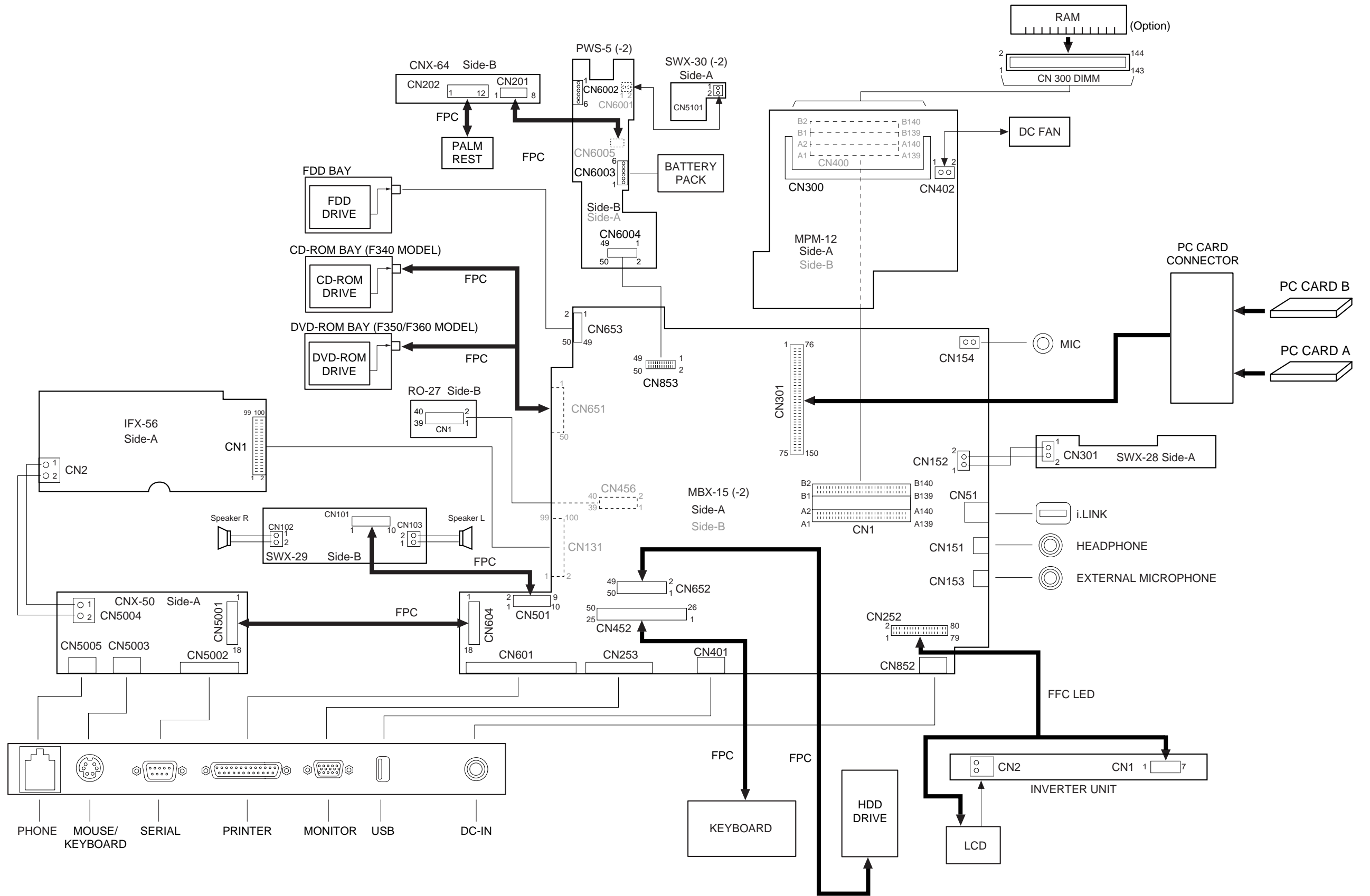

EXPLODED VIEWS AND PARTS LIST

NOTE:

- The mechanical parts with no reference number in the exploded views are not supplied.
- Items marked “ * ” are not stocked since they are seldom required for routine service. Some delay should be anticipated when ordering these items.

The components identified by mark Δ or dotted line with mark Δ are critical for safety. Replace only with part number specified.

Les composants identifiés par une marque Δ sont critiques pour la sécurité. Ne les remplacer que par une pièce portant le numéro spécifié.

5-1. Main Section

Ref.No.	Part No.	Description	Ref.No.	Part No.	Description
1	X-4622-490-1	ASSY BOTTOM (NHA)	63	4-643-794-11	COVER BATTERY CONNECTOR (EP)
3	4-640-837-11	DOOR BATTERY	* 64	4-641-188-01	SPACER MODEM
4	A-8056-427-A	RO-27 COMPLETE PWB (K3)	65	4-644-664-01	INSULATOR MODEM A
6	1-542-331-11	MICROPHONE UNIT	66	4-644-665-01	INSULATOR MODEM B
* 7	4-641-495-02	HOLDER MIC	* 67	4-641-366-02	LABEL I/O
* 8	4-640-856-01	HEAT SINK BOTTOM	68	4-641-629-01	INSULATOR FDD
10	4-639-101-01	SHEET (N), THERMAL	69	4-641-763-01	LABEL FD
11	4-640-874-11	INSULATOR HEATSINK BOTTOM	* 70	4-641-850-01	SPRING (CD-ROM), PLATE
12	1-763-330-11	FAN, DC	* 71	4-641-851-01	SPRING (FDD), PLATE
13	A-8056-025-A	COMPLETE PWB SWX-28	72	4-640-852-02	BRACKET I/O
14	4-640-819-02	PLATE HEAT T	73	4-640-820-01	PLATE STAND OFF
15	4-643-832-01	DUMMY CARD	74	4-641-365-11	INSULATOR A
16	4-640-821-01	PLATE SPK	75	4-640-895-01	STAND OFF (IFX)
17	4-640-822-01	CUSHION SPK	* 76	4-640-515-31	GASKET
18	A-8056-027-A	COMPLETE PWB SWX-29	* 77	4-641-844-01	GASKET (PS2)
19	X-4622-492-1	ASSY HOOD KEYBOARD (NHA)	* 78	4-642-094-01	THERMAL SHEET V
20	1-529-459-11	SPEAKER, (3.2CM)	79	4-640-515-01	GASKET
21	4-640-823-02	PLATE HOOD	80	4-640-515-21	GASKET
22	1-790-639-13	FPC 50PIN (FOR HDD)	* 81	4-641-842-01	(F350/F360)...GASKET (CD-ROM)
23	4-644-641-01	COVER HDD2	81	4-645-103-01	(F340)...GASKET (CD-ROM) 2
24	A-8045-479-A	HDD 6.4GB (S)	* 82	4-641-843-01	GASKET (FDD)
25	1-418-041-11	KEY BOARD UNIT	* 84	4-641-853-01	TAPE (PLATE), SHIELD
26	X-4622-489-1	ASSY PALMREST (NHA)	* 85	4-642-066-01	SHEET PW
27	1-759-708-11	PAD, TOUCH	* 86	4-641-841-01	GASKET (PALM)
28	A-8056-023-A	COMPLETE PWB CNX-64	* 87	4-641-852-01	TAPE (PAD), SHIELD
29	4-640-862-11	BRACKET PAD	88	A-8045-604-A	(F340/F350)...1090P2 366/64 (S)
* 30	4-640-853-02	BRACKET HDD		(MBX-15 (-2) BOARD/MPM-12 (P366-64) BOARD)	
31	4-640-861-04	BRACKET CD-ROM R	88	A-8045-603-A	(F360)...1090P2 400/64 (S)
32	1-772-033-11	(F340)...CD-ROM (X24)		(MBX-15 (-2) BOARD/MPM-12 (P400-64) BOARD)	
32	1-772-211-11	(F350/F360)...DVD-ROM (4X)	90	4-640-833-11	BOTTOM WEIGHT SAVER
33	X-4622-494-1	(F340)...ASSY DOOR CD-ROM (NHA)	91	4-640-834-11	BUTTON WEIGHT SAVER
33	X-4622-495-1	(F350/F360)...ASSY DOOR DVD-ROM (NHA)	* 92	4-640-847-01	LATCH WEIGHT SAVER
34	4-640-860-02	BRACKET (CD-ROM L)	93	4-640-968-11	ARM WEIGHT SAVER
35	4-640-828-01	PLATE FDD	* 94	4-640-969-01	CLICKER WEIGHT SAVER
36	1-772-034-11	FDD	* 95	4-640-970-11	COVER WEIGHT SAVER
37	X-4622-493-1	ASSY BOTTOM FDD (NHA)	* 96	4-641-764-01	LABEL WEIGHT SAVER
38	4-640-838-11	DOOR I/O	97	1-959-405-11	HARNES 2P
39	4-640-850-11	FOOT REAR	* 401	4-643-010-01	BRACKET IRDA
40	4-640-863-11	DOOR DOCKING CONNECTOR	* 402	4-642-180-01	LABEL HOOD
41	4-640-851-01	FOOT FRONT	403	A-8046-136-A	ASSY WEIGHT SAVER (NHA)
42	4-640-839-11	DOOR FLASH	* 405	4-641-630-01	COVER BAY HOLE
43	A-8056-302-A	COMPLETE PWB SWX-30 (-2)	* 406	4-641-860-01	COVER BOTTOM
44	4-644-190-01	LATCH DETECTOR BASE (K)	407	4-641-835-11	INSULATOR CNX-64
45	4-635-255-01	LATCH DETECTOR	* 409	4-642-177-01	SPACER MAIN BOARD
46	A-8056-300-A	COMPLETE PWB PWS-5 (-2)	* 410	4-642-178-01	INSULATOR HDD 2
48	A-8056-021-A	COMPLETE PWB IFX-56 (U)	411	4-642-413-01	CUSHION FLASH 1060
49	4-644-666-01	INSULATOR PC CARD	412	1-785-736-11	CONNECTOR, PC CARD 150P
50	1-790-585-11	CABLE (2P)	413	1-790-708-11	FFC (MBX-CNX)
51	X-4622-085-1	ASSY PANEL CONNECTOR	414	4-644-667-01	COVER RJ-11
52	1-790-640-11	FPC 50PIN (FOR CD-ROM)	415	4-641-836-11	INSULATOR FLASH
53	1-790-641-11	FPC 50PIN (FOR FDD)	416	4-643-759-02	SHIELD TAPE (MPM-12)
54	4-640-840-11	BUTTON PW	417	4-642-424-01	CUSHION HDD2
55	4-640-845-11	BUTTON BAY	418	4-642-423-01	CUSHION HDD
56	4-640-846-11	LATCH BAY	420	4-641-849-01	GND PLATE
* 57	4-640-854-01	SPRING BAY	421	4-643-760-11	SHIELD TAPE (FPC)
* 58	4-640-855-02	BRACKET BOTTOM	422	4-645-220-01	SHIELD TAPE (BOTTOM)
* 59	4-640-857-01	DOOR BATTERY SPRING	423	1-790-711-11	FFC (PPK)
60	4-640-865-21	DISPLAY BASE	424	1-790-709-11	FFC (SWX-TP)
61	4-640-875-11	INSULATOR HDD	425	1-790-710-11	FFC (SWX-PWS)
* 62	4-640-877-01	LENS IR	426	4-644-053-01	SPACER FDD

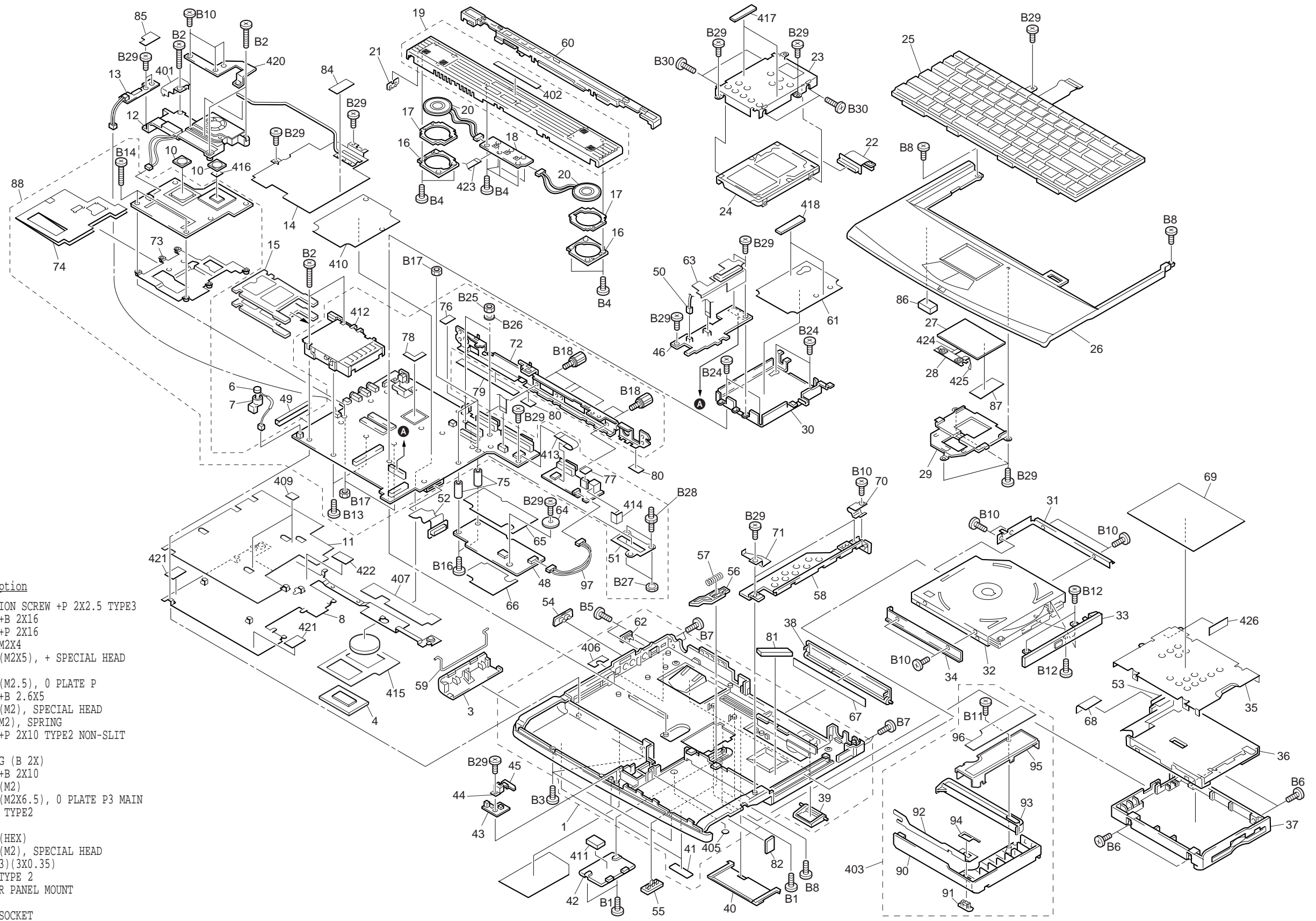

Ref.No.	Part No.	Description
B1	7-627-854-08	PRECISION SCREW +P 2X2.5 TYPE3
B2	7-621-772-80	SCREW +B 2X16
B3	7-621-256-00	SCREW +P 2X16
B4	4-639-112-01	SCREW M2X4
B5	4-641-655-02	SCREW (M2X5), + SPECIAL HEAD
B6	4-641-656-02	SCREW (M2.5), 0 PLATE P
B7	7-621-775-20	SCREW +B 2.6X5
B8	4-641-726-11	SCREW (M2), SPECIAL HEAD
B10	4-640-694-41	BOLT (M2), SPRING
B11	7-685-106-19	SCREW +P 2X10 TYPE2 NON-SLIT
B12	4-642-229-01	TAPPING (B 2X)
B13	7-621-772-50	SCREW +B 2X10
B14	3-740-546-21	SCREW (M2)
B16	4-642-516-01	SCREW (M2X6.5), 0 PLATE P3 MAIN
B17	7-622-205-05	NUT M2 TYPE2
* B18	4-635-966-01	SCREW (HEX)
B24	4-641-726-61	SCREW (M2), SPECIAL HEAD
B25	3-181-686-01	NUT (N3)(3X0.35)
B26	7-623-208-22	SW 3, TYPE 2
* B27	4-641-834-01	NUT FOR PANEL MOUNT
* B28	4-641-833-01	GUIDE SOCKET
B29	4-642-852-21	+B M2
B30	4-635-301-01	SCREW M3X4

5-2. LCD Section (F350/F360 Model)

5-2-1. LCD Made by Samsung

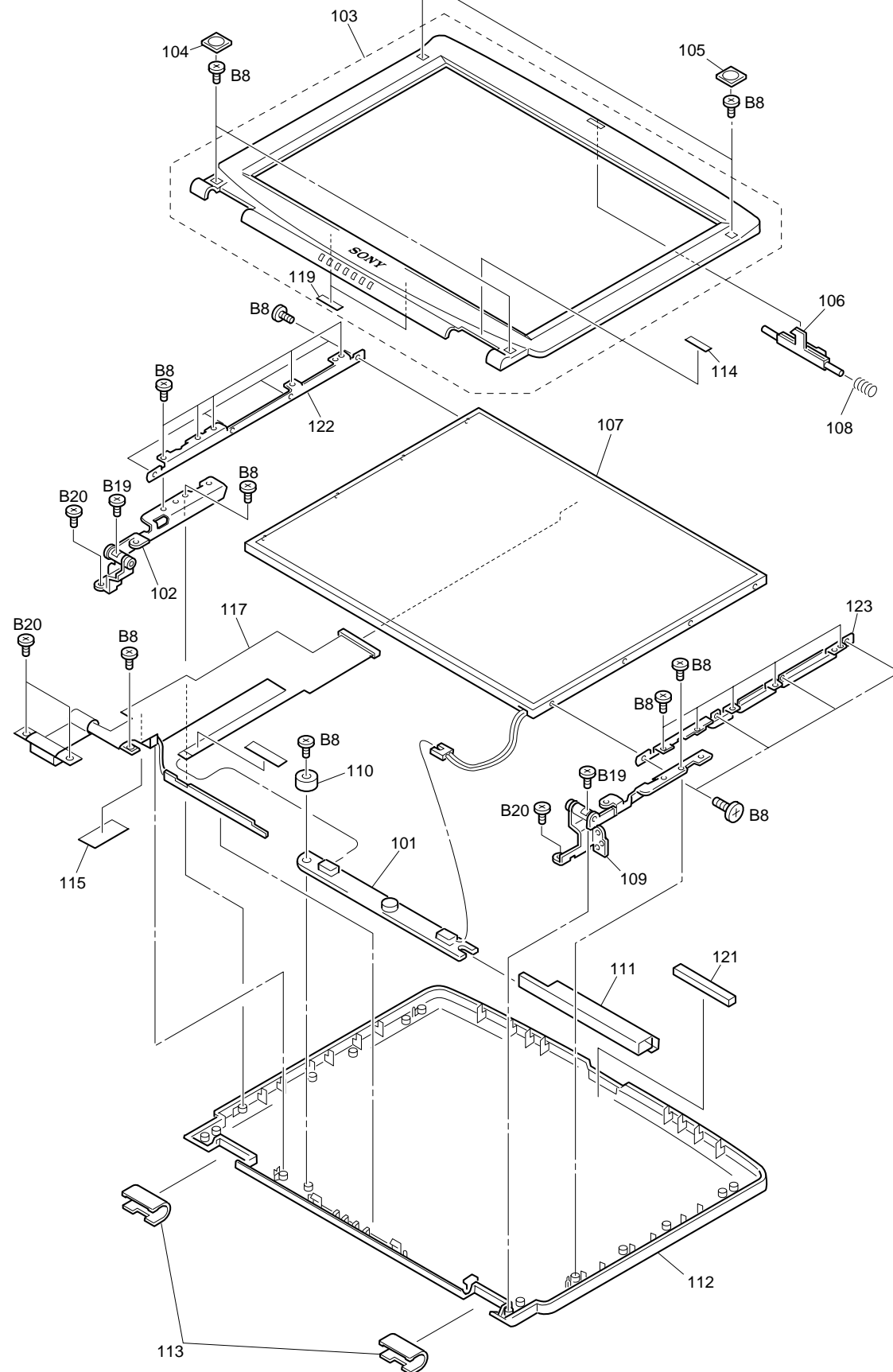

Ref.No.	Part No.	Description
101	1-418-578-11	INVERTER UNIT
102	X-4622-432-1	HINGE LEFT 14 (SA)
103	X-4622-431-1	ASSY HOU, BEZEL 14 (SA)
104	4-635-277-11	COVER SCREW LOWER
105	4-635-276-11	COVER SCREW UPPER
106	4-637-902-41	LATCH
107	4-6045-905-2	ASSY LCD XGA 14T SA (UC)
108	4-637-903-01	SPRING LATCH
109	X-4622-433-1	HINGE RIGHT 14 (SA)
110	4-635-274-01	BRACKET INVERTER
111	4-643-767-11	INSULATOR INVERTER (TR)
112	X-4622-430-1	ASSY HOU, DISPLAY 14 (SA)
113	4-642-762-11	COVER HINGE (15)
114	4-644-711-21	(F350)...LABEL ID
114	4-644-711-11	(F360)...LABEL ID
115	4-641-768-01	TAPE (LCD), GND
117	1-791-750-11	FPC CABLE (14.1" TFT XGA)
* 119	3-909-058-01	SHEET (D), ADHESIVE
121	4-642-040-01	CUSHION LCD 3S
* 122	4-644-163-01	BRACKET LCD LEFT 14 (SA)
* 123	4-644-164-01	BRACKET LCD RIGHT 14 (SA)

△ [COR] 1-418-716-11

Ref.No.	Part No.	Description
B8	4-641-726-11	SCREW (M2), SPECIAL HEAD
B19	7-628-254-00	SCREW +PS 2.6X5
B20	7-628-253-20	SCREW +PS 2X6

5-2-2. LCD Made by Hitachi

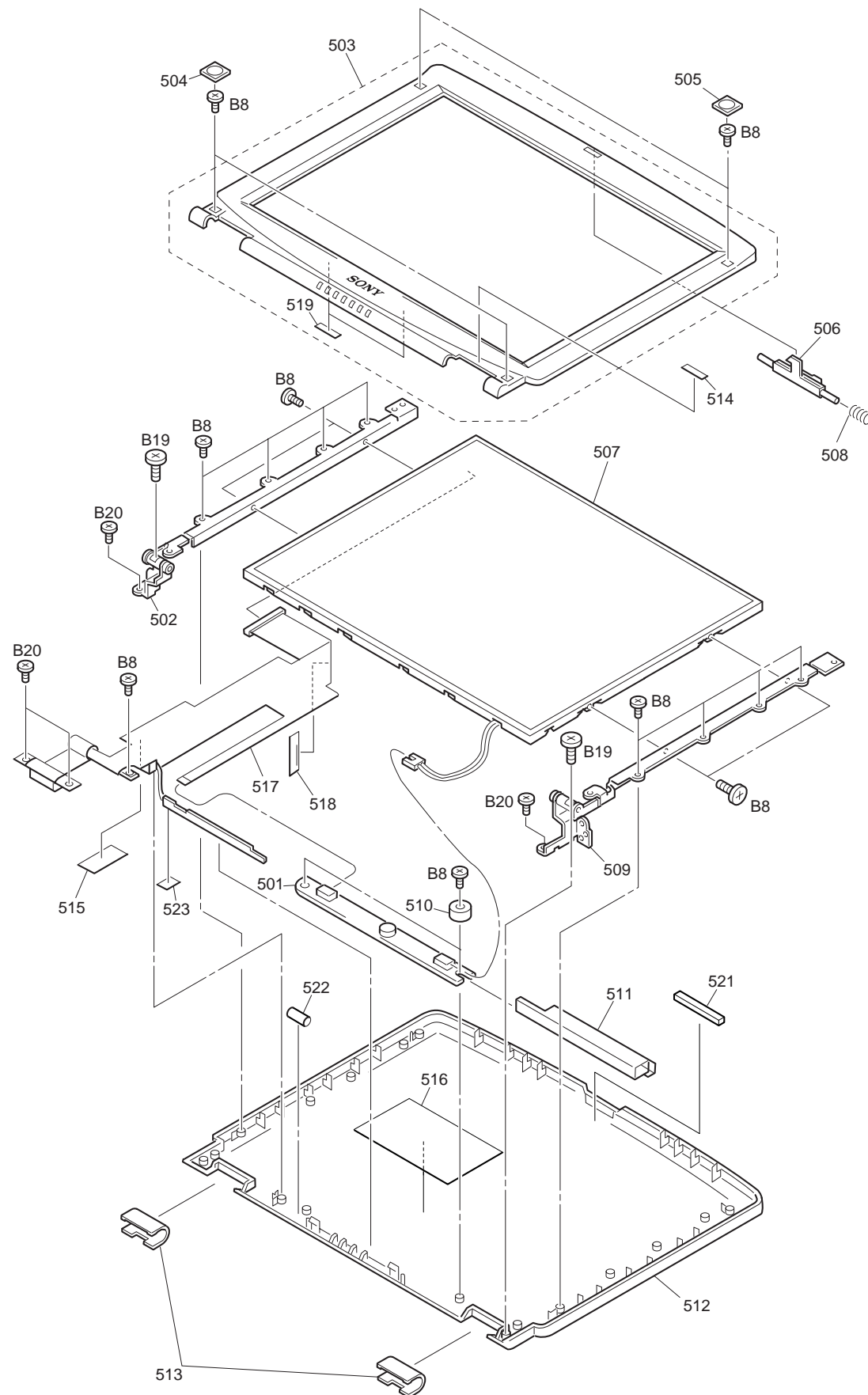

Ref.No.	Part No.	Description
501	1-418-297-22	INVERTER UNIT
502	X-4622-263-1	HINGE LEFT 14T (B)
503	X-4622-396-2	ASSY HOU, BEZEL 14 (NH)
504	4-635-277-11	COVER SCREW LOWER
505	4-635-276-11	COVER SCREW UPPER
506	4-637-902-31	LATCH
507	A-8045-723-A	ASSY LCD XGA 14T (S)
508	4-635-272-01	SPRING, COMPRESSION
509	X-4622-264-1	HINGE RIGHT 14T (B)
510	4-635-274-01	BRACKET INVERTER
511	4-640-892-11	INSULATOR INVERTER
512	X-4622-394-1	ASSY HOU, DISPLAY 14 (NH)
513	4-642-762-11	COVER HINGE (15)
514	4-644-711-41	LABEL ID
515	4-641-768-01	TAPE (LCD), GND
* 516	4-642-228-02	SHEET, RADIATION
517	1-790-531-12	CABLE, FPC (14.1" TFT XGA)
518	3-907-769-01	SHEET (B), ADHESIVE
* 519	3-909-058-01	SHEET (D), ADHESIVE
521	4-642-040-01	CUSHION LCD 3S
522	4-644-661-01	GASKET (13.3)
523	4-645-102-01	SHIELD TAPE (LED)

Ref.No.	Part No.	Description
B8	4-641-726-11	SCREW (M2), SPECIAL HEAD
B19	7-628-254-00	SCREW +PS 2.6X5
B20	7-628-253-20	SCREW +PS 2X6

5-3. LCD Section (F340 Model)

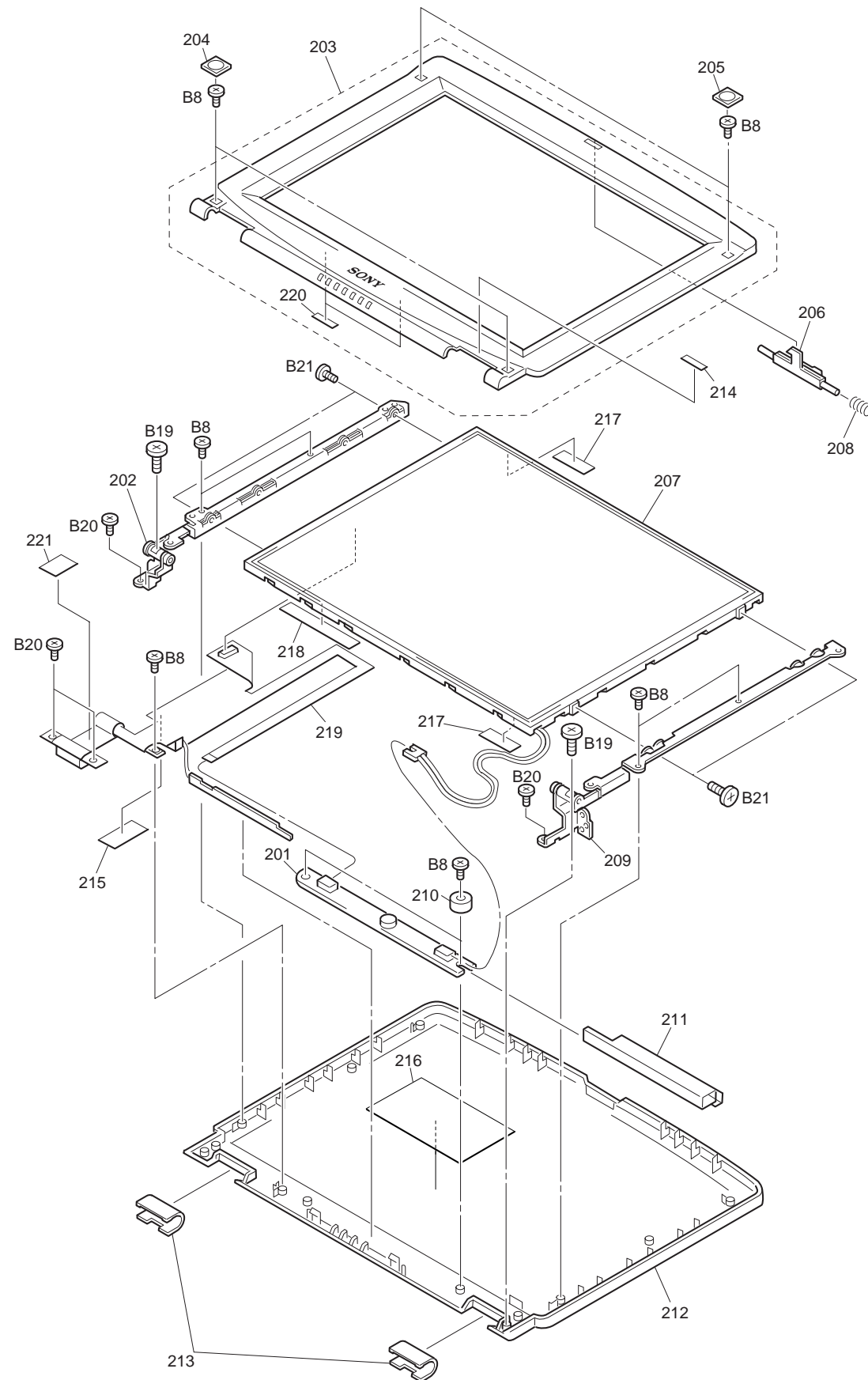

Ref.No.	Part No.	Description
201	1-418-297-12	INVERTER UNIT
202	X-4622-261-1	HINGE LEFT 13H
203	X-4622-395-2	ASSY HOU, BEZEL 13H (NH)
204	4-635-277-11	COVER SCREW LOWER
205	4-635-276-11	COVER SCREW UPPER
206	4-637-902-31	LATCH
207	1-803-345-11	LCD UNIT (13.0" DSTN XGA)
208	4-635-272-01	SPRING, COMPRESSION
209	X-4622-262-1	HINGE RIGHT 13H (B)
210	4-635-274-01	BRACKET INVERTER
211	4-640-892-11	INSULATOR INVERTER
212	X-4622-393-1	ASSY HOU, DISPLAY 13 (NH)
213	4-642-762-11	COVER HINGE (15)
214	4-644-711-31	LABEL ID
215	4-641-768-01	TAPE (LCD), GND
* 216	4-642-228-02	SHEET, RADIATION
217	4-641-765-01	GASKET (LA)
218	4-641-766-01	GASKET (LB)
219	1-790-532-12	CABLE, FPC (13.0" DSTN-XGA)
* 220	3-909-058-01	SHEET (D), ADHESIVE
221	4-643-760-11	SHIELD TAPE (FPC)
B8	4-641-726-11	SCREW (M2), SPECIAL HEAD
B19	7-628-254-00	SCREW +PS 2.6X5
B20	7-628-253-20	SCREW +PS 2X6
B21	7-628-253-90	SCREW +PS 2.6X4

Ref.No.	Part No.	Description
		ACCESSORIES *****
△ 303	1-782-614-11	CORD, POWER
*	A-8046-144-A	WEIGHT SAVER ASSY
304	A-8046-136-A	ASSY WEIGHT SAVER (NHA)
	3-868-301-11	USER GUIDE
	3-868-302-11	READ ME FIRST

303 Power cord (1)

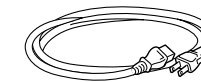

304 Weight saver (1)

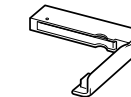

The components identified by mark △ or dotted line with mark △ are critical for safety. Replace only with part number specified.

Les composants identifiés par une marque △ sont critiques pour la sécurité. Ne les remplacer que par une pièce portant le numéro spécifié.

QUICK MEMO

(1/1)

No. FIT- **M2001_043K**

J UC E I

The object of information

Technical Parts Other information

Date : 2001.6.29

From : MNC IT Planning & Control Dept.

The relation document to the plan of

T/N Service manual Others No publication

[SNT]

Tel : +81 3 5795 6931

[Model/Series]

PCG-F Series

VAIO Notebook Computer SERVICE MANUAL

[Subject]

CORRECTION

[Contents]

Correction (of part)

Model (Page)		Ref.No.	Incorrect		Correct	
			Part No.	Description	Part No.	Description
UC	F350/F360 (5-6)	107	A-8045-905-A	ASSY LCD XGA 14T SA (UC)	<u>1-418-716-11</u>	ASSY LCD XGA 14T SA (UC)

* Please make these changes on the list of repair parts as well until revised version published.

[Applicable Manuals]

UC : PCG-F340/F350/F360

(9-872-001-11)

< For Japanese staff > Please look at information in Japanese by visiting at our web site.

Service Manual Update List

Date of the Lastest Update 2001.06.29

ADD : ADDITION COR : CORRECTION DEL : DELETION

Update No.	Contents				Medium			SM
	Classification	Page	Section	Details	Type	No.	Date	Ver.
△	COR	5-6	Main Section	Ref.107 A-8045-905-A → 1-418-716-11	Quick Memo	M2001_043K	2001.06.29	Ver. 2