

PCG-Z1V/Z1VE/Z1VT PCG-Z1VAP1/Z1VAP2/Z1VA/Z1VFP PCG-Z1VCP/Z1VGP/Z1VJP/Z1VLP/Z1VTP

SERVICE MANUAL

Ver 3-2003J

Revision History

Area	Model	Line up	
Japanese	Japanese	PCG-Z1VT/P PCG-Z1V/P PCG-Z1VE	△ [MA]
American	US/ Canadian	PCG-Z1VAP1 * PCG-Z1VAP2 * PCG-Z1VA *	△ [MA] △ [MA] △ [MA]
	Latin	PCG-Z1VFP	△ [MA]
Asian/Oceania/ South Africa	International	PCG-Z1VGP	△ [MA]
	Korean	PCG-Z1VLP	△ [MA]
	Chinese	PCG-Z1VCP	△ [MA]
	Taiwan	PCG-Z1VTP	△ [MA]
	Thailand	PCG-Z1VJP	△ [MA]

* : CTO model

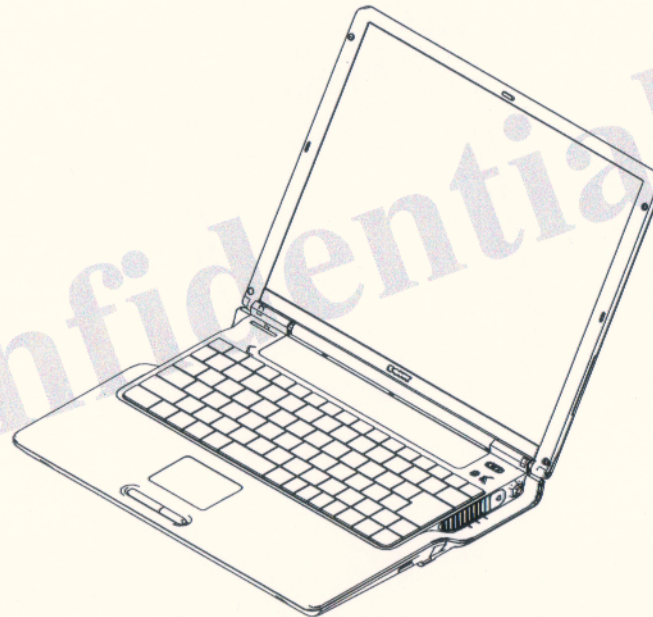

Illust : PCG-Z1V/P



• Design and specifications are subject to change without notice.

• 本機の仕様および外観は、改良のため予告なく変更することがありますが、ご了承ください。

Notebook Computer

SONY

Information in this document is subject to change without notice.

Sony, VAIO and CLIE are trademarks or registered trademarks of Sony. Microsoft, Windows, Windows Media, Outlook, Bookshelf and other Microsoft products are trademarks or registered trademarks of Microsoft Corporation in the United State and other countries.

The word Bluetooth and the Bluetooth logo are trademarks of Bluetooth SIG, Inc. AMD, the AMD logo, other AMD product names and combinations thereof are trademarks of Advanced Micro Devices, Inc. Intel Inside logo, Pentium and Celeron are trademarks or registered trademarks of Intel Corporation. Transmeta, the Transmeta logo, Crusoe Processor, the Crusoe logo and combinations thereof are trademarks of Transmeta Corporation in the USA and other countries. Graffiti, Hotsync, PalmModem, and Palm OS are registered trademarks, and the Hotsync logo and Palm are trademarks of Palm, Inc. or its subsidiaries. (M) and Motrola are trademarks of Motrola, Inc. Other Motrola prudemarks and services with (R) mark like Dragomball are the trademarks of Motrola, Inc.

All other name of systems, products and services in this manual are trademarks or registered trademarks of their respective owners. In this manual, the (TM) or (R) mark are not specified.

Caution Markings for Lithium/Ion Battery - The following or similar texts shall be provided on battery pack of equipment or in both the operating and the service instructions.

CAUTION: Danger of explosion if battery is incorrectly replaced. Replace only with the same or equivalent type recommended by the manufacturer. Discard used batteries according to the manufacturer's instructions.

CAUTION: The battery pack used in this device may present a fire or chemical burn hazard if mistreated. Do not disassemble, heat above 100°C (212°F) or incinerate.

Dispose of used battery promptly. Keep away from children.

CAUTION: Changing the back up battery.

- Overcharging, short circuiting, reverse charging, mutilation or incineration of the cells must be avoided to prevent one or more of the following occurrence; release of toxic materials, release of hydrogen and/or oxygen gas, rise in surface temperature.
- If a cell has leaked or vented, it should be replaced immediately while avoiding to touch it without any protection.

Service and Inspection Precautions

1. Obey precautionary markings and instructions

Labels and stamps on the cabinet, chassis, and components identify areas requiring special precautions. Be sure to observe these precautions, as well as all precautions listed in the operating manual and other associated documents.

2. Use designated parts only

The set's components possess important safety characteristics, such as noncombustibility and the ability to tolerate large voltages. Be sure that replacement parts possess the same safety characteristics as the originals. Also remember that the Δ mark, which appears in circuit diagrams and parts lists, denotes components that have particularly important safety functions; be extra sure to use only the designated components.

3. Always follow the original design when mounting parts and routing wires

The original layout includes various safety features, such as inclusion of insulating materials (tubes and tape) and the mounting of parts above the printer board. In addition, internal wiring has been routed and clamped so as to keep it away from hot or high-voltage parts. When mounting parts or routing wires, therefore, be sure to duplicate the original layout.

4. Inspect after completing service

After servicing, inspect to make sure that all screws, components, and wiring have been returned to their original condition. Also check the area around the repair location to ensure that repair work has caused no damage, and confirm safety.

5. When replacing chip components...

Never reuse components. Also remember that the negative side of tantalum capacitors is easily damaged by heat.

6. When handling flexible print boards...

- The temperature of the soldering-iron tip should be about 270°C.
- Do not apply the tip more than three times to the same pattern.
- Handle patterns with care; never apply force.

Caution: Remember that hard disk drives are easily damaged by vibration. Always handle with care.

ATTENTION AU COMPOSANT AYANT RAPPORT À LA SÉCURITÉ!

LES COMPOSANTS IDENTIFIÉS PAR UNE MARQUE Δ SUR LES DIAGRAMMES SCHÉMATIQUES ET LA LISTE DES PIÈCES SONT CRITIQUES POUR LA SÉCURITÉ DE FONCTIONNEMENT. NE REMPLACER CES COMPOSANTS QUE PAR DES PIÈCES SONY DONT LES NUMÉROS SONT DONNÉS DANS CE MANUEL OU DANS LES SUPPLÉMENTS PUBLIÉS PAR SONY.

Confidential

TABLE OF CONTENTS

<u>Section</u>	<u>Title</u>	<u>Page</u>
CHAPTER 1. SPECIFICATIONS	1-1
		(to 1-1)
CHAPTER 2. BLOCK DIAGRAM	2-1
		(to 2-1)
CHAPTER 3. FRAME HARNESS DIAGRAM	3-1
		(to 3-1)
CHAPTER 4. EXPLODED VIEWS AND PARTS LIST		
Palmrest		
P-1	4-2
Bottom		
B-1	4-3
Main Board		
M-1	4-4
LCD		
L-1	4-5
Accessories		
A-1	4-6
DIP Switch	4-7
		(to 4-7)
CHAPTER 5. OTHERS		
5-1. The Barcode Label	5-1
5-2. CTO Information	5-2
		(to 5-2) △ [MA]

History of the changes is shown as the Revision History at the end of this data.

Confidential

PCG-Z1V/Z1VE/Z1VT (J)
 PCG-Z1VAP1/Z1VAP2/Z1VA/Z1VFP (AM)
 PCG-Z1VCP/Z1VGP/Z1VJP/Z1VLP/Z1VTP (AO)

CHAPTER 1. SPECIFICATIONS

	J			AM			
	PCG-Z1VT/P	PCG-Z1V/P	PCG-Z1VE	PCG-Z1VAP1*	PCG-Z1VAP2*	PCG-Z1VA*	PCG-Z1VFP
CPU	Pentium-M 1.7 GHz	Pentium-M 1.6 GHz	Pentium-M 1.3 GHz	Pentium-M 1.6 GHz	Pentium-M 1.7 GHz	Pentium-M 1.6 GHz	Pentium-M 1.6 GHz
LCD	14.1SXGA+	14.1SXGA+	14.1SXGA+	14.1SXGA+	14.1SXGA+	14.1SXGA+	14.1SXGA+
HDD	80GB	60GB	40GB	60GB	80GB	60GB	60GB
MEMORY (STANDARD/MAX)	512 MB/1GB	512 MB/1GB	256 MB/768MB	512 MB/1GB	1GB/1GB	512 MB/1GB	512 MB/1GB
On Board	512MB	512MB	256MB	512MB	512MB	512MB	512MB
SLOT	-	-	-	-	512MB	-	-
OPT-DRIVE	COMBO	COMBO	COMBO	COMBO	COMBO	COMBO	COMBO
Wireless LAN	○	○	○	○	○	○	○
Bluetooth	○	○	○	○	○	○	×
AC Adaptor	PCGA-AC16V6	PCGA-AC16V6	PCGA-AC16V6	PCGA-AC16V6	PCGA-AC16V6	PCGA-AC16V6	PCGA-AC16V6
Battery	PCGA-BP2V	PCGA-BP2V	PCGA-BP2V	PCGA-BP2V	PCGA-BP4V	PCGA-BP2V	PCGA-BP2V
OS	XP Professional	XP Professional	XP Home Edition	XP Professional	XP Professional	XP Home Edition	XP Professional
	△[MA]			△[MA]	△[MA]	△[MA]	△[MA]

	AO				
	PCG-Z1VGP	PCG-Z1VLP	PCG-Z1VCP	PCG-Z1VTP	PCG-Z1VJP
CPU	Pentium-M 1.6 GHz	Pentium-M 1.6 GHz	Pentium-M 1.6 GHz	Pentium-M 1.6 GHz	Pentium-M 1.6 GHz
LCD	14.1SXGA+	14.1SXGA+	14.1SXGA+	14.1SXGA+	14.1SXGA+
HDD	60GB	60GB	60GB	60GB	60GB
MEMORY (STANDARD/MAX)	512 MB/1GB	512 MB/1GB	512 MB/1GB	512 MB/1GB	512 MB/1GB
On Board	512MB	512MB	512MB	512MB	512MB
SLOT	-	-	-	-	-
OPT-DRIVE	COMBO	COMBO	COMBO	COMBO	COMBO
Wireless LAN	○	○	○	○	○
Bluetooth	×	×	×	×	×
AC Adaptor	PCGA-AC16V6	PCGA-AC16V6	PCGA-AC16V6	PCGA-AC16V6	PCGA-AC16V6
Battery	PCGA-BP2V	PCGA-BP2V	PCGA-BP2V	PCGA-BP2V	PCGA-BP2V
OS	XP Professional	XP Professional	XP Professional	XP Professional	XP Professional
	△[MA]	△[MA]	△[MA]	△[MA]	△[MA]

- The trademarks or registered trademarks of above table, refer to page 2.
- The model that is accompanied by asterisk (*) is CTO model.

- 本表中の商標・登録商標については、2ページをご参照下さい。
- 機種名に(*)がつくのは、CTOモデルです。

Confidential

PCG-Z1V/Z1VE/Z1VT (J)
PCG-Z1VAP1/Z1VAP2/Z1VA/Z1VFP (AM)
PCG-Z1VCP/Z1VGP/Z1VJP/Z1VLP/Z1VTP (AO)

CHAPTER 2. BLOCK DIAGRAM

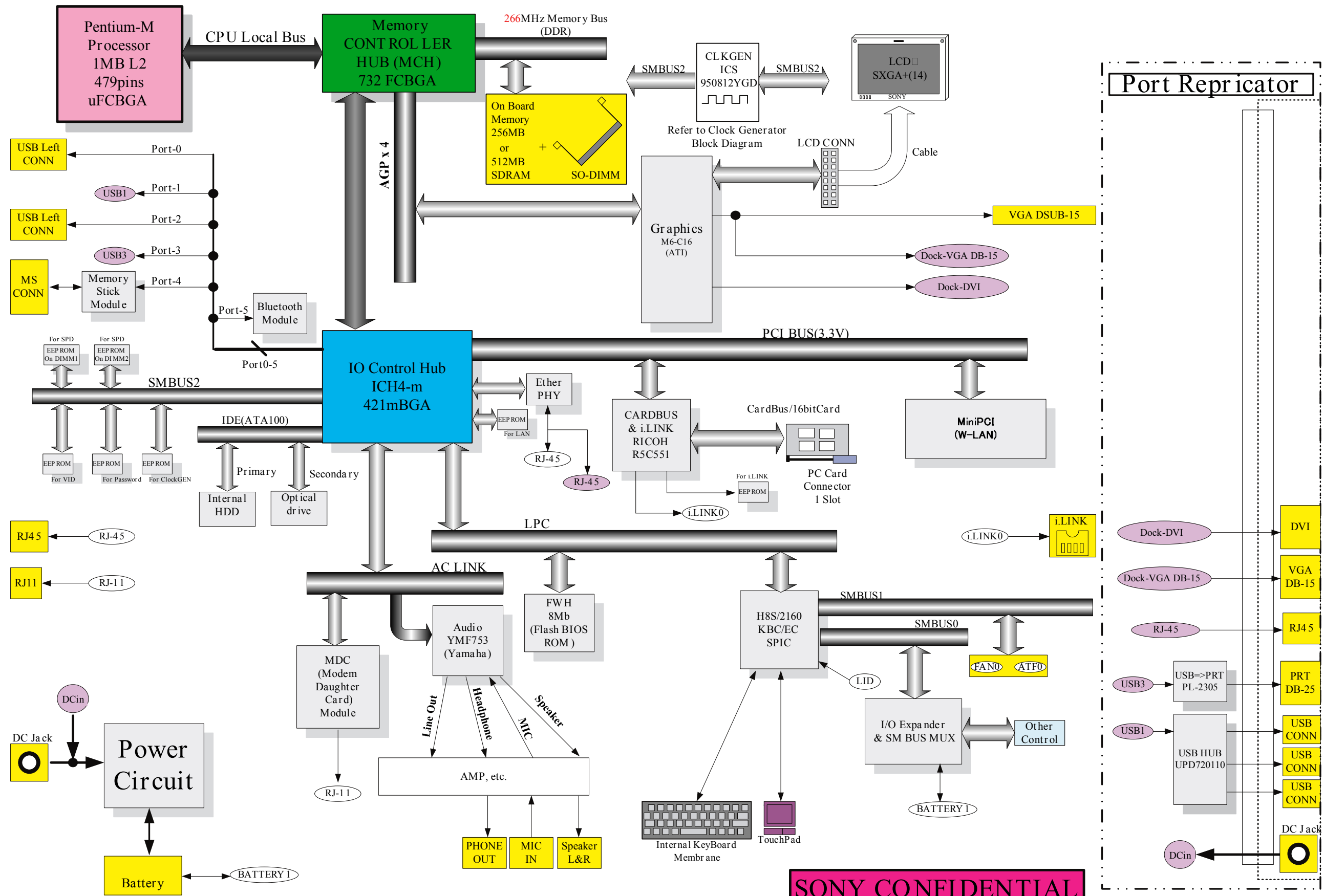

SONY CONFIDENTIAL

Confidential

PCG-Z1V/Z1VE/Z1VT (J)
PCG-Z1VAP1/Z1VAP2/Z1VA/Z1VFP (AM)
PCG-Z1VCP/Z1VGP/Z1VJP/Z1VLP/Z1VTP (AO)

CHAPTER 3. FRAME HARNESS DIAGRAM

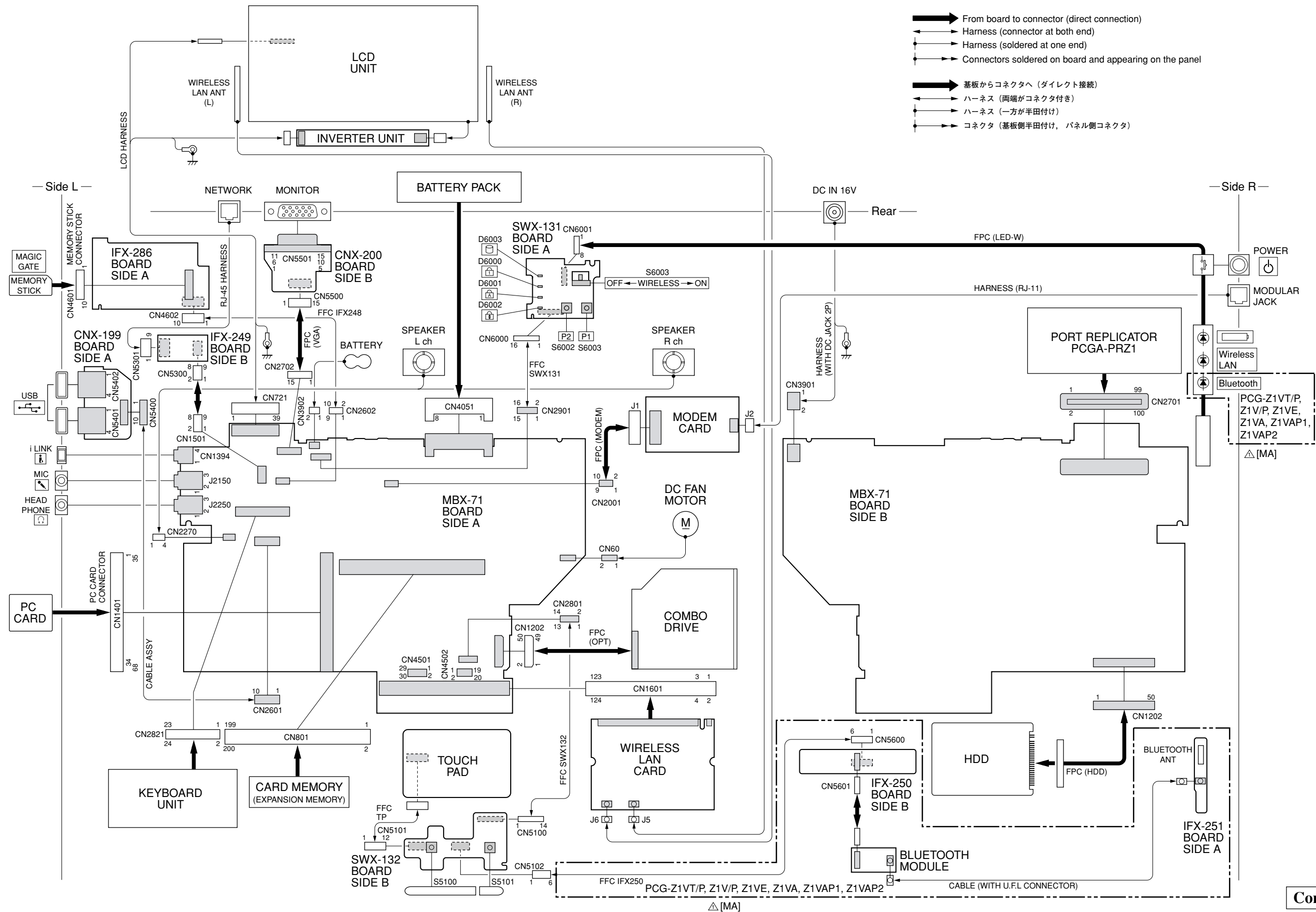

Confidential

PCG-Z1V/Z1VE/Z1VT (J)
 PCG-Z1VAP1/Z1VAP2/Z1VA/Z1VFP (AM)
 PCG-Z1VCP/Z1VGP/Z1VJP/Z1VLP/Z1VTP (AO)

CHAPTER 4. EXPLODED VIEWS AND PARTS LIST

- The parts list is compiled by blocks of a palmrest and bottom etc. The sections of the parts list are different depending on the model. Please refer to list of contents shown in the below.

Section	Page
Palmrest	
P-1	4-2
Bottom	
B-1	4-3
Main Board	
M-1	4-4
LCD	
L-1	4-5
Accessories	
A-1	4-6
DIP Switch	4-7

- 分解図と部品表は、パームレスト、ボトムなどのブロックごとに分かれています。機種によって部品表のセクションが異なりますので、詳細は右下の一覧表を参照してください。

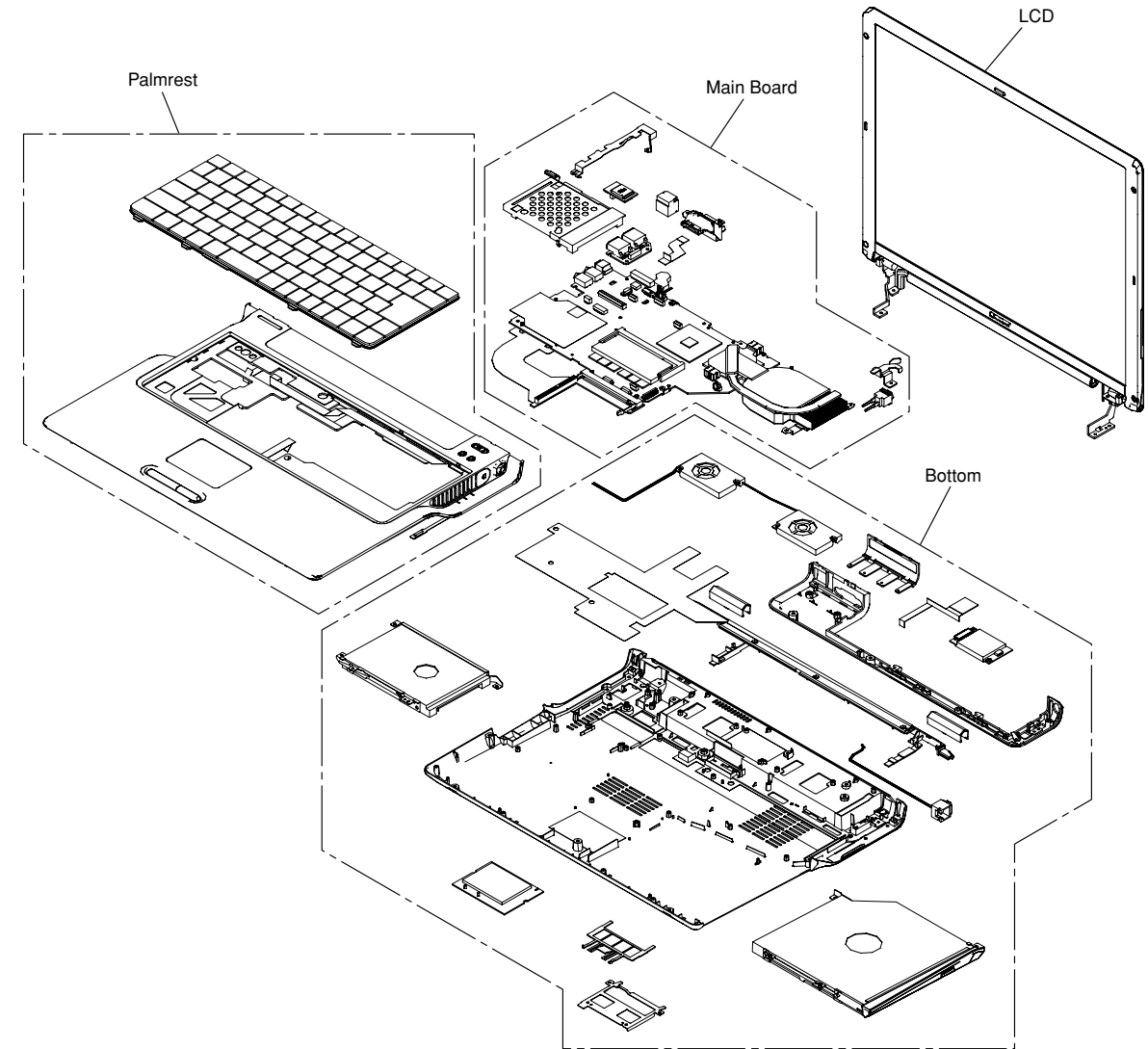

- NOTE:**
- Items marked “ * ” are not stocked since they are seldom required for routine service. Some delay should be anticipated when ordering these items.
 - The mechanical parts with no reference number in the exploded views are not supplied.
 - When two or more parts are shown, use the parts described first as the main part.
 - The parts marked “ \$ ” are the High Value Modules (HVM).
 - The parts marked “ # ” are the parts on which barcode label is attached. For the barcode label, refer to CHAPTER 5.
 - The parts marked “ & ” are the “Customer Replacable parts (CRP)” that can be replaced by Field Customer Support. Especially the parts with the <> mark require the special attention to use them. Here fore, check first whether the desired part is one of the targetted parts of the Customer Replacable Parts (CRP), or the non-targetted parts by referring to the exploded view.

- 【使用上の注意】**
- *印の部品は常備在庫しておりません。
 - 図面番号のない部品は供給しません。
 - 併記部品の場合、上部記載部品をメイン部品として使用してください。
 - 部品名称の前に\$印のついた部品は、High Value Module (HVM) です。
 - 商品名称の前に#印のついた部品は、バーコードラベル貼付部品です。バーコードラベルについてはCHAPTER 5を参照してください。
 - 商品名称の前に&印のついた部品は、お客様窓口などでも交換可能な Customer Replacable Parts (CRP)です。特に<&>印のついた部品は、使い分けが必要な部品ですので、分解図でCustomer Replacable Parts 対象部品か、対象外部部品かを必ず御確認ください。

△印の部品、または△印付きの点線で囲まれた部品は、安全性を維持するために重要な部品です。従って交換時は、必ず指定の部品を使用して下さい。

The components identified by mark △ or dotted line with mark △ are critical for safety. Replace only with part number specified.

Les composants identifiés par une marque △ sont critiques pour la sécurité. Ne les remplacer que par une pièce portant le numéro spécifié.

		Palmrest	Bottom	Main Board	LCD	Accessoris	
△ [MA]	J	Z1VT/P	P-1	B-1	M-1	L-1	A-1
		Z1V/P	P-1	B-1	M-1	L-1	A-1
		Z1VE	P-1	B-1	M-1	L-1	A-1
△ [MA]	AM	U-CTO	P-1	B-1	M-1	L-1	A-1
		Z1VFP	P-1	B-1	M-1	L-1	A-1
△ [MA]	AO	Z1VGP	P-1	B-1	M-1	L-1	A-1
		Z1VLP	P-1	B-1	M-1	L-1	A-1
		Z1VCP	P-1	B-1	M-1	L-1	A-1
		Z1VTP	P-1	B-1	M-1	L-1	A-1
△ [MA]		Z1VJP	P-1	B-1	M-1	L-1	A-1

Confidential

PCG-Z1V/Z1VE/Z1VT (J)
PCG-Z1VAP1/Z1VAP2/Z1VA/Z1VFP (AM)
PCG-Z1VCP/Z1VGP/Z1VJP/Z1VLP/Z1VTP (AO)

P-1. Palmrest

P-1

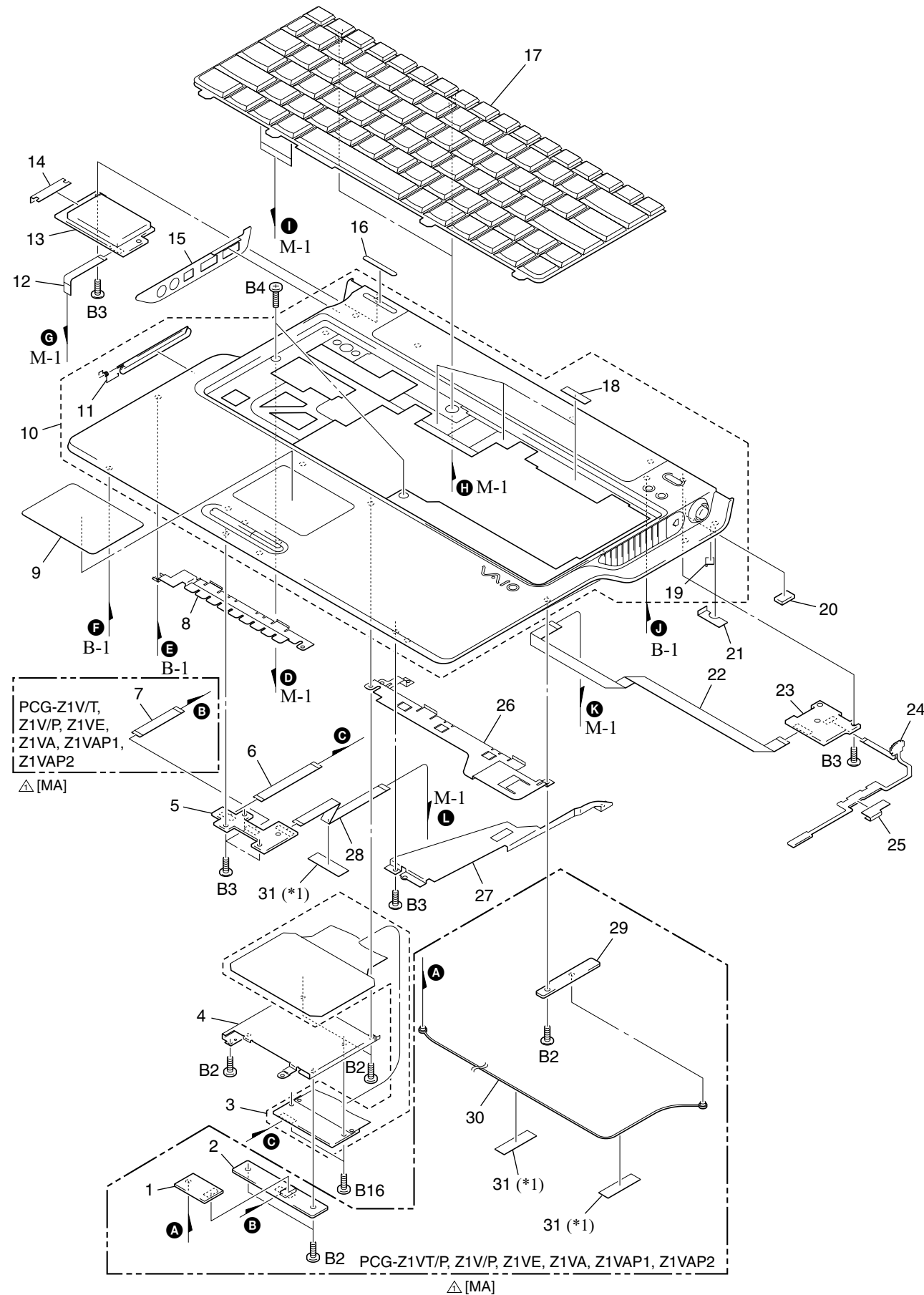

Ref.No.	Part No.	Description	Ref.No.	Part No.	Description
3	1-796-622-11	TOUCH PAD	* 27	4-670-301-01	BRACKET (OD)
* 4	4-670-302-01	BRACKET (TP)	28	1-824-950-11	CABLE, FLEXIBLE FLAT (SWX132)
5	A-8117-905-A \$	SWX-132 (3) (S)	31		FILAMENT TAPE (W12X30) (*1)
6	1-824-948-11	CABLE, FLEXIBLE FLAT (TP)	B2	4-673-648-01	SCREW, M2 (+B) (EG)
* 8	4-670-303-01	PLATE (PARM REST L)	B3	4-676-936-01	+SCREW, M2 +SPECIAL HEAD SELF S
9	4-670-975-02	SHEET (TP)	B16	4-672-834-91	SCRWE, +B EG GRIP
11	4-647-180-01	COIL SPRING			
12	1-824-947-11	CABLE, FLEXIBLE FLAT (IFX248)			
13	A-8117-909-A \$ #	IFX-286 (S)			
14	4-670-314-01	SHEET (MS)			
15	4-670-294-03	ESCUTCHEON (JACK)			
18	4-669-735-01	ADHESIVE TAPE (16SH)			
19	4-661-451-01	ADHESIVE TAPE TOUCHPAD			
20	4-674-011-01	CUSHION (BT)			
21	4-675-270-01	SHEET (PW LED)			
22	1-824-946-11	CABLE, FLEXIBLE FLAT (SWX131)			
23	A-8117-902-A \$	SWX-131 (3) (S)			
24	1-687-010-12	PWB, FLEXIBLE PRINT (LED-W)			
25	4-673-768-01	SHEET (LED B)			
* 26	4-670-313-02	PLATE (PARM REST R)			

*1 Use the FILAMENT TAPE.

Ref. No.	Part No.	Description	J		AM			AO						
			Z1VT/P	Z1V/P	Z1VE	Z1VAP1 *	Z1VAP2 *	Z1VA *	Z1VFP	Z1VGP	Z1VLP	Z1VCP	Z1VTP	Z1VJP
1	1-234-803-21	BLUETOOTH MODULE	●	●	●	●	●							
2	A-8117-910-A \$	IFX-250 (3) (S)	●	●	●	●	●							
7	1-824-949-11	CABLE, FLEXIBLE FLAT (IFX250)	●	●	●	●	●							
10	X-4626-401-1	HOUSING (PARM REST) ASSY	●	●	●	●	●							
	X-4626-402-1	HOUSING (PARM REST) ASSY						●	●	●	●	●	●	●
△ [MA]	16	4-678-382-01	●											
	4-678-382-11	LABEL ID		●										
	4-678-382-21	LABEL ID			●									
△ [MA]	4-678-382-31	LABEL ID							●					
△ [MA]	4-678-382-41	LABEL ID								●				
△ [MA]	4-678-382-51	LABEL ID									●			●
△ [MA]	4-678-382-61	LABEL ID										●		●
△ [MA]	4-678-382-71	LABEL ID											●	●
△ [MA]	4-679-371-01	LABEL ID								●				
△ [MA]	4-679-371-11	LABEL ID									●			
△ [MA]	4-679-371-21	LABEL ID										●		
△ [MA]	17	1-477-792-11 \$ #	●	●	●									
△ [MA]	1-477-792-21	KEYBOARD UNIT (US)				●	●	●					●	●
△ [MA]	1-477-792-81	KEYBOARD UNIT (LA)												
△ [MA]	1-477-792-91	KEYBOARD UNIT (KR)												
△ [MA]	1-478-193-11	KEYBOARD UNIT (TW)												●
△ [MA]	1-478-193-21	KEYBOARD UNIT (TH)												●
	29	A-8117-911-A \$	●	●	●	●	●	●						
	30	1-827-266-21	●	●	●	●	●	●						

- This prts list contains two different types of parts. The first type is the parts that are common to all models. The other type is the parts that are different depending on each model.
- The model that is accompanied by asterisk (*) is the CTO model.

- この部品表は、機種共通の部品と、機種によって使い分けが必要な部品に分かれています。
- 機種名に(*)がつくのはCTOモデルです。

Confidential

PCG-Z1V/Z1VE/Z1VT (J)
 PCG-Z1VAP1/Z1VAP2/Z1VA/Z1VFP (AM)
 PCG-Z1VCP/Z1VGP/Z1VJP/Z1VLP/Z1VTP (AO)

B-1. Bottom

B-1

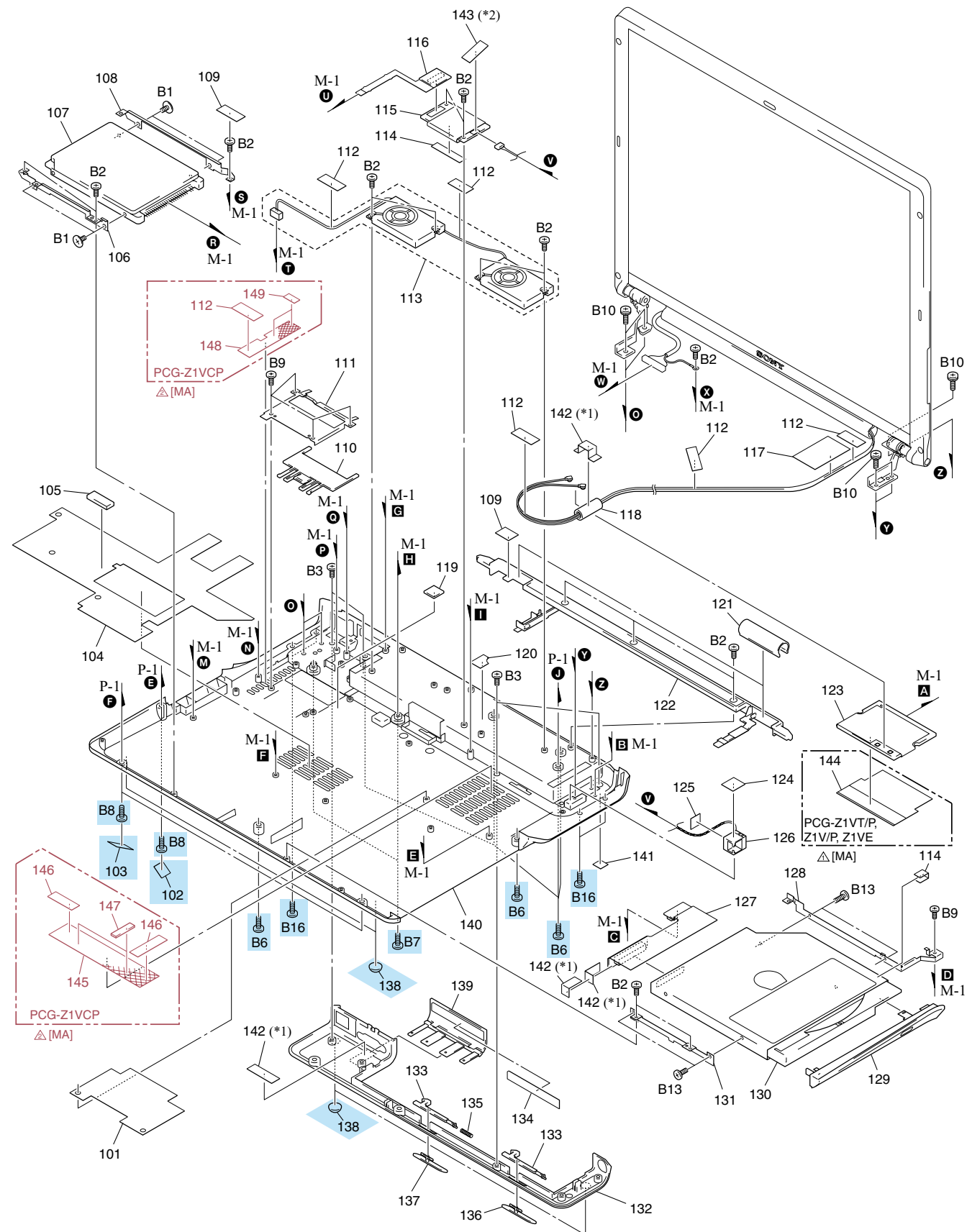

Ref.No.	Part No.	Description	Ref.No.	Part No.	Description
101	4-673-387-01	SHEET (BHF)	133	4-670-335-02	LEVER, RELEASE
102	4-671-053-01	& SHEET (SCREW S)	134	4-671-074-01	LABEL (DOOR IO)
103	4-670-341-01	& SHEET (SCREW)	135	4-635-956-01	SPRING (B), COMPRESSION COIL
104	4-670-340-01	SHEET (BT)	136	4-670-338-02	KNOB (BR)
105	4-673-386-01	SPACER (P)	137	4-670-336-02	KNOB (BL)
* 106	4-670-328-01	BRACKET (HDR)	138	4-670-325-01	& FOOT
* 108	4-670-327-01	BRACKET (HDL)	139	X-4625-671-2	DOOR (IO) ASSY
109	4-672-493-01	COVER (SC)	140	4-670-324-03	# HOUSING (BOTTOM)
110	4-670-319-01	COVER (PR)	141	4-673-385-01	SHEET (GP)
* 111	4-670-333-01	LOCK (PR)	142	_____	FILAMENT TAPE (W12X30) (*1)
112	4-662-881-02	CUSHION, KEY BOARD	143	_____	CAPTON TAPE (W10X20) (*2)
113	1-825-310-12	SPEAKER, BOX WITH (2.3CM)			
114	4-675-315-01	SHEET (K1035)	B1	4-672-839-01	HEAD, M3 FLAT
115	1-761-606-14	CARD, MODEM	B2	4-673-648-01	GRIP, M2 (+B) (EG)
116	1-687-012-11	PWB, FLEXIBLE PRINT (MODEM)	B3	4-676-936-01	+SCREW, M2 +SPECIAL HEAD SELF S
117	4-672-491-01	SHEET (FIN)	B6	4-672-834-61	& SCREW, +B EG GRIP
118	1-400-255-11	FERRITE CORE	B7	4-672-834-81	& SCREW, +B EG GRIP
119	4-674-429-01	THERMAL PAD (GFX)	B8	4-672-834-51	& SCREW, +B EG GRIP
120	4-670-320-01	SHEET (MDC)	B9	4-673-646-01	DIA. (4.6) (M2)
121	4-670-345-03	COVER (HINGE)	B10	4-673-647-01	M2 (+BSW)
122	4-670-322-04	BASE, DISPLAY	B13	4-671-538-01	SCREW (M2X4), SPECIAL HEAD
124	4-671-461-01	TAPE (M)	B16	4-672-834-91	& SCRWE, +B EG GRIP
125	4-671-235-01	SHEET (M)			
126	1-962-037-11	HARNESS (RJ11)			
127	1-687-011-11	PWB, FLEXIBLE PRINT (OPT)			
* 128	4-670-346-01	BRACKET (ODR)			
129	X-4625-673-2	BEZEL (ODP) ASSY			
130	1-796-626-12 \$ #	COMBO DRIVE (UJDA745, 9.5MM)			
* 131	4-670-330-01	BRACKET (ODL)			
132	4-670-318-03	COVER (BT)			

*1 Use the FILAMENT TAPE.
*2 Use the CAPTON TAPE.

Ref. No.	Part No.	Description	J		AM				AO					
			Z1V7P	Z1V/P	Z1VE	Z1VAP1*	Z1VAP2*	Z1VA*	Z1VFP	Z1VGP	Z1VLP	Z1VCP	Z1VTP	Z1VJP
△ [MA]	107	A-8067-943-A \$ # ASSY HDD 80GB (I. 40) (S)	●				●							
△ [MA]		A-8111-360-A \$ # ASSY HDD 60GB (T. 30) (S)												
		A-8116-402-A \$ # ASSY HDD 60GB (I. 40) (S)		●			●	●	●			●	●	●
		A-8116-404-A \$ # ASSY HDD 40GB (I. 40) (S)			●									
△ [MA]	123	1-761-660-13 CARD, WIRELESS LAN (CLX11B 11CH)				●	●	●				●	●	
△ [MA]		1-761-660-23 CARD, WIRELESS LAN (CLX11B 14CH)												●
		1-761-784-11 CARD, WIRELESS LAN	●	●	●									
△ [MA]	144	4-674-985-01 SHEET (MINI-PCI)	●	●	●									
△ [MA]	145	4-679-415-01 PLATE (UL) 1											●	
△ [MA]	146	4-676-302-01 TAPE (COMMON)											●	
△ [MA]	147	4-679-417-01 SPACER (UL) 1											●	
△ [MA]	148	4-679-416-01 PLATE (UL) 2											●	
△ [MA]	149	4-679-418-01 SPACER (UL) 2											●	

- This prts list contains two different types of parts. The first type is the parts that are common to all models. The other type is the parts that are different depending on each model.
- The model that is accompanied by asterisk (*) is the CTO model.

この部品表は、機種共通の部品と、機種によって使い分けが必要な部品に分かれています。
機種名に(*)がつくのはCTOモデルです。

Confidential

PCG-Z1V/Z1VE/Z1VT (J)
PCG-Z1VAP1/Z1VAP2/Z1VA/Z1VFP (AM)
PCG-Z1VCP/Z1VGP/Z1VJP/Z1VLP/Z1VTP (AO)

M-1. Main Board

M-1

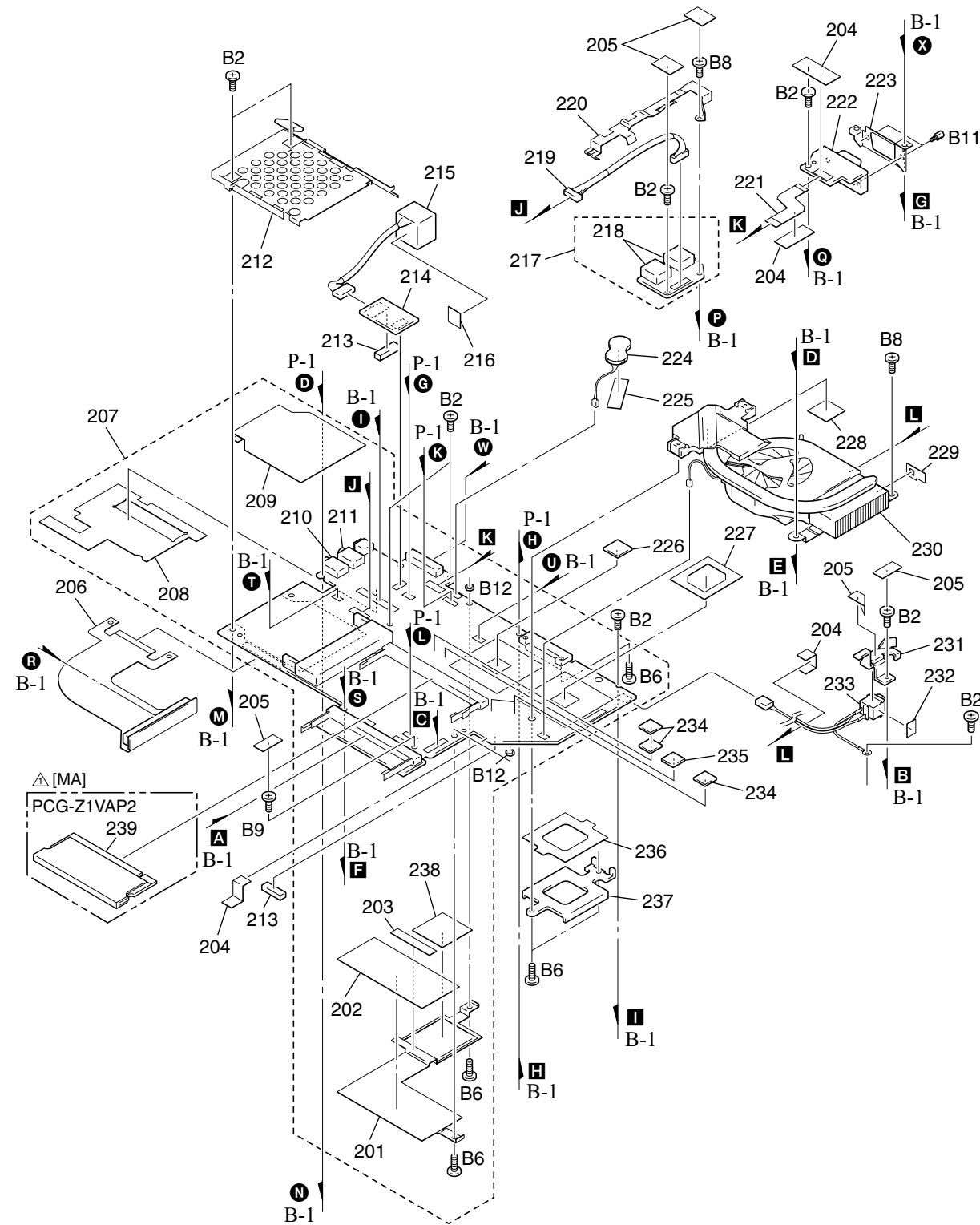

Ref.No.	Part No.	Description	Ref.No.	Part No.	Description
* 201	4-670-289-01	HEAT SPREADER	232	4-674-795-01	SHEET (DC)
202	4-671-078-01	SHEET (MEMO), THERMAL	233	1-961-978-12	HARNESS (WITH DC JACK 2P)
203	4-671-187-01	SHEET (HS)	234	4-673-671-01	THERMALPAD (FET)
204	4-662-881-02	CUSHION, KEY BOARD	235	4-673-670-01	THERMALPAD (COIL)
205	4-672-493-01	COVER (SC)	236	4-671-186-01	SHEET (BFAN)
206	1-687-009-11	PWB, FLEXIBLE PRINT (HDD)	* 237	4-670-291-01	BRACKET (FAN)
208	4-670-342-01	SHEET (PR)	238	4-671-077-01	SHEET (GFX), THERMAL
209	4-670-321-01	SHEET (PCC)	B2	4-673-648-01	GRIP, M2 (+B) (EG)
210	1-694-760-21	JACK, SMALL TYPE	B6	4-672-834-61	SCREW, +B EG GRIP
211	1-694-760-31	JACK, SMALL TYPE	B8	4-672-834-51	SCREW, +B EG GRIP
212	1-817-281-14	CONNECTOR, PC CARD	B9	4-673-646-01	DIA. (4.6) (M2)
213	4-670-343-01	SPACER (ETHER)	B11	4-635-966-01	SCREW (HEX)
214	A-8117-906-A \$	IFX-249 (3) (S)	B12	4-673-751-01	NUT (M2) (TYPE2)
215	1-962-080-11	HARNESS, RJ-45			
216	4-671-235-01	SHEET (M)			
217	A-8117-907-A \$	CNX-199 (3) (S)			
218	1-794-548-21	CONNECTOR, USB (A)			
219	1-824-973-11	CABLE ASSY			
* 220	4-670-331-01	BRACKET (USB)			
221	1-687-013-12	PWB, FLEXIBLE PRINT (VGA)			
222	A-8117-908-A \$ #	CNX-200 (3) (S)			
* 223	4-670-329-01	BRACKET (IO)			
224	1-756-038-11	BATTERY, NICKEL HYDROGEN			
225	4-642-711-01	SHEET (BATTERY), ADHESIVE			
226	4-674-010-01	THERMALPAD (MCH)			
227	4-673-971-02	SHEET (CPU)			
228	4-672-944-01	THERMAL SHEET (CPU)			
229	4-672-945-01	GUARD (FIN)			
230	1-763-964-12	DC FAN			
* 231	4-670-332-02	HOLDER (DC)			

Ref. No.	Part No.	Description	J		AM			AO						
			Z1VT/P	Z1V/P	Z1VE	Z1VAP1 *	Z1VAP2 *	Z1VA *	Z1VFP	Z1VGP	Z1VLP	Z1VCP	Z1VTP	Z1VJP
△ [MA]	207	A-8117-897-A \$ # MBX-71 (B3) (S)	●											
		A-8117-899-A \$ # MBX-71 (C3) (S)		●										
		A-8117-900-A \$ # MBX-71 (D3) (S)			●									
△ [MA]	239	A-8067-880-A \$ # COMPLETE PWB MM-10				●								

- This prts list contains two different types of parts.
The first type is the parts that are common to all models.
The other type is the parts that are different depending on each model.
- The model that is accompanied by asterisk (*) is the CTO model.
- この部品表は、機種共通の部品と、機種によって使い分けが必要な部品に分かれています。
- 機種名に (*) がつくのは CTO モデルです。

Confidential

PCG-Z1V/Z1VE/Z1VT (J)
PCG-Z1VAP1/Z1VAP2/Z1VA/Z1VFP (AM)
PCG-Z1VCP/Z1VGP/Z1VJP/Z1VLP/Z1VTP (AO)

L-1. LCD 14-inch SXGA+ - Made by TS -

L-1

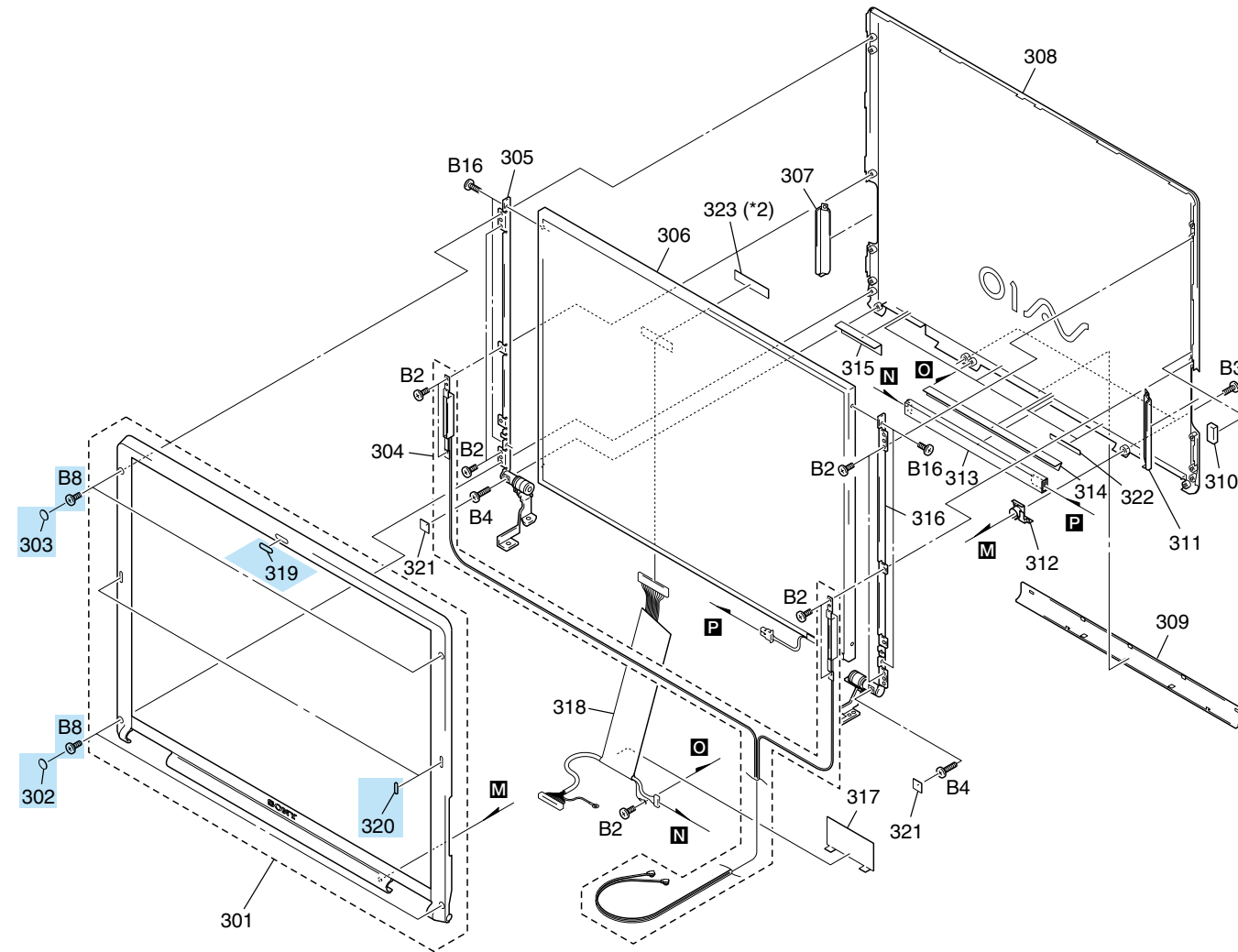

Ref.No.	Part No.	Description
301	X-4625-667-3	HOUSING (BEZEL) ASSY
302	4-671-221-02	& CAP (DOWN)
303	4-670-189-01	& CUSHION (UP)
304	1-754-292-12	ANTENNA (2.4GHZ L AND R)
305	4-669-620-03	HINGE (L)
306	A-8114-655-A \$ #	LCD (UNIT) (14SXGA+) (S)
307	4-669-613-02	COVER (WLL)
308	A-8114-751-A	DISPLAY ASSY (S)
309	4-669-615-03	COVER (DISPLAY)
310	4-669-622-01	MAGNET
311	4-669-614-02	COVER (WLR)
312	4-669-612-02	COVER (CABLE)
313	1-477-753-11	INVERTER UNIT
314	4-675-311-01	SHEET (WLCL)
315	4-673-641-01	SHEET (CORNER)
316	4-669-621-02	HINGE (R)
317	4-671-222-01	SHEET (LH)
318	1-961-999-21	HARNESS, LCD (SXGA+)
319	4-670-188-01	& CUSHION (CENTER)
320	4-670-190-01	& CUSHION (SIDE)
321	4-675-342-01	SHEET (HS)
322	4-675-312-01	ADHESIVE TAPE (WLCL)
323		CAPTON TAPE (W10X30) (*2)
B2	4-673-648-01	SCREW, M2 (+B) (EG)
B3	4-676-936-01	+SCREW, M2 +SPECIAL HEAD SELF S
B4	4-672-834-71	SCREW, +B EG GRIP
B8	4-672-834-51	& SCREW, +B EG GRIP
B16	4-672-834-91	SCREW, +B EG GRIP

*2 Use the CAPTON TAPE.

Confidential

PCG-Z1V/Z1VE/Z1VT (J)
 PCG-Z1VAP1/Z1VAP2/Z1VA/Z1VFP (AM)
 PCG-Z1VCP/Z1VGP/Z1VJP/Z1VLP/Z1VTP (AO)

A-1. Accessories

A-1

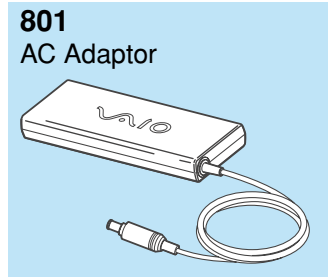

801
AC Adaptor

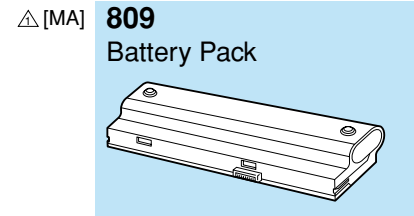

△ [MA] **809**
Battery Pack

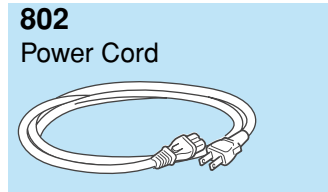

802
Power Cord

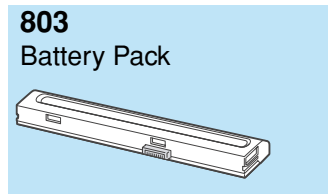

803
Battery Pack

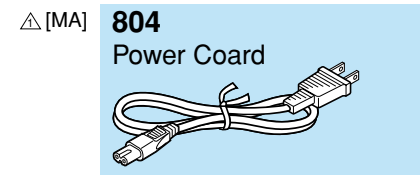

△ [MA] **804**
Power Cord

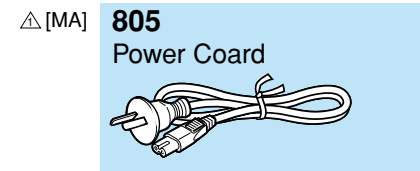

△ [MA] **805**
Power Cord

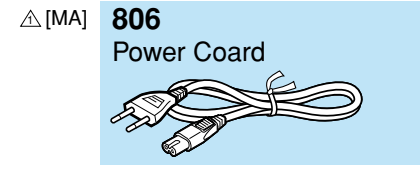

△ [MA] **806**
Power Cord

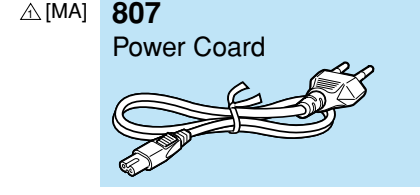

△ [MA] **807**
Power Cord

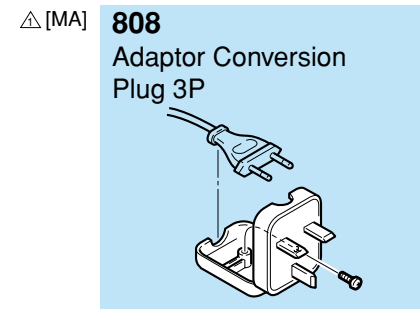

△ [MA] **808**
Adaptor Conversion
Plug 3P

Ref.No. Part No. Description
 △ 801 1-477-749-51 \$ & ADAPTOR, AC

Ref. No.	Part No.	Description	J		AM				AO					
			Z1VT/P	Z1V/P	Z1VE	Z1VAP1*	Z1VAP2*	Z1VA*	Z1VFP	Z1VGP	Z1VLP	Z1VCP	Z1VTP	Z1VJP
△ [MA] △ 802	1-782-476-22	& CORD, POWER												
	1-790-732-32	& CORD, POWER	●	●	●									
	803	A-8114-136-A \$ & BP2V (J) ASSY (S)	●	●	●									
△ [MA]		A-8114-137-A \$ & BP2V (U) ASSY (S)				●		●	●					
△ [MA]		1-756-328-22 \$ & BATTERY PACK, LITHIUM ION (PCGA-BP2V)				●	●	●	●	●	●	●	●	●
△ [MA]	△ 804	1-757-562-21 & CORD, POWER				●	●	●	●					
△ [MA]	△ 805	1-555-074-31 & CORD, POWER								●				
△ [MA]	△ 806	1-575-131-61 & CORD, POWER								●				●
△ [MA]	△ 807	1-823-947-32 & POWER-SUPPLY CORD									●			
△ [MA]	△ 808	1-770-019-12 & ADAPTOR, CONVERSION PLUG 3P								●				
△ [MA]	809	A-8114-139-A \$ & BP4V (U) ASSY (S)												
△ [MA]	—	4-679-331-01 & QUICK START, 2800UA				●	●	●						
△ [MA]	—	4-679-384-01 & INSTRUCTION MANUAL (XP Professional, XP Home Edition)	●	●	●									
△ [MA]	—	4-679-642-11 & SPEC SHEET, 2800LA							●					
△ [MA]	—	4-679-643-11 & QUICK START, 2800LA							●					
△ [MA]	—	4-679-658-11 & INSTRUCTION MANUAL (XP Professional)							●					●
△ [MA]	—	4-679-658-21 & INSTRUCTION MANUAL (XP Professional)								●				
△ [MA]	—	4-679-658-41 & INSTRUCTION MANUAL (XP Professional)									●			●
△ [MA]	—	4-679-659-31 & INSTRUCTION MANUAL (XP Professional)										●		●

- This prts list contains two different types of parts.
The first type is the parts that are common to all models.
The other type is the parts that are different depending on each model.
- The model that is accompanied by asterisk (*) is the CTO model.
- この部品表は、機種共通の部品と、機種によって使い分けが必要な部品に分かれています。
- 機種名に(*)がつくのはCTOモデルです。

Confidential

PCG-Z1V/Z1VE/Z1VT (J)
 PCG-Z1VAP1/Z1VAP2/Z1VA/Z1VFP (AM)
 PCG-Z1VCP/Z1VGP/Z1VJP/Z1VLP/Z1VTP (AO)

DIP Switch

The DIP switch setting is following table.

DIPスイッチの設定は下の表をご覧ください

Set the DIP switch on the MBX-71 board (Main board) to match with the LCD that is used in this computer.

MBX-71 Board（メインボード）のDIPスイッチは、下図のように本機で使用するLCDに合わせて設定します。



The lower position where ON indication is shown is the ON position.

The upper position is the OFF position.

下側（ONと表記のある側）がON, 上側がOFF

No.	1	2	3	4
ON/OFF	1	0	1	1

0 : ON 1 : OFF

Confidential

PCG-Z1V/Z1VE/Z1VT (J)

PCG-Z1VAP1/Z1VAP2/Z1VA/Z1VFP (AM)

PCG-Z1VCP/Z1VGP/Z1VJP/Z1VLP/Z1VTP (AO)

CHAPTER 5. OTHERS

5-1. The Barcode Label

The half-tone dot meshing part will be used as repair data.

バーコードラベルの網掛け部は、修理データとして使用いたします。

[Main Section] (Bottom)

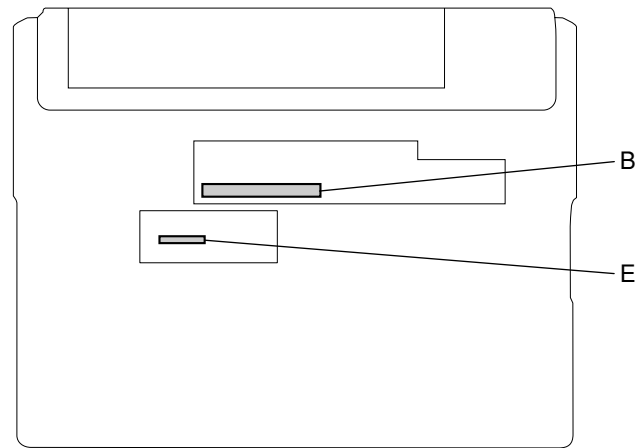

[COMBO Drive] (Top)

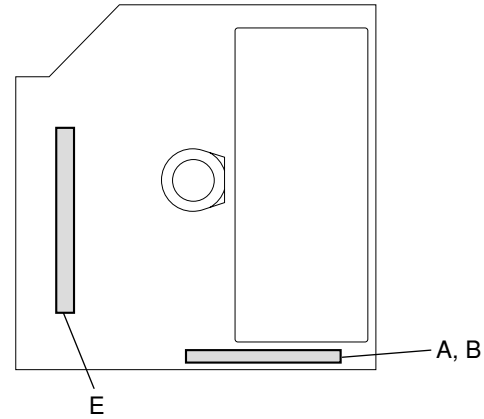

[HDD] (Top)

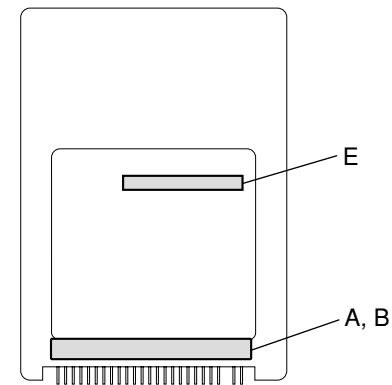

[MBX-71 Board] (Side A)

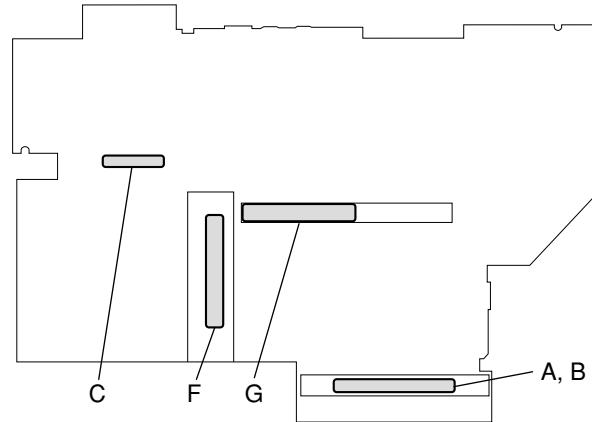

[LCD] (Bottom)

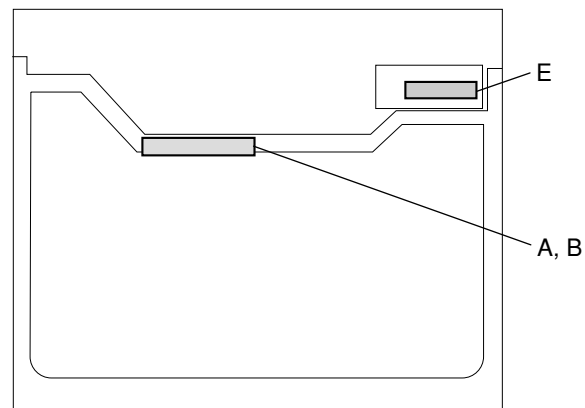

[IFX-286 Board] (Side B)

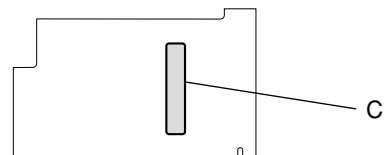

[KEYBOARD] (Bottom)

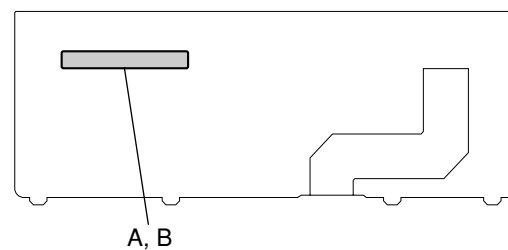

- A : Part No.
- B : Serial No.
- C : Revision No.
- D : Product Code
- E : Maker Barcode
- F : Global User ID (iLink)
- G : Mac Address
- : Barcode

Confidential

PCG-Z1V/Z1VE/Z1VT (J)
PCG-Z1VAP1/Z1VAP2/Z1VA/Z1VFP (AM)
PCG-Z1VCP/Z1VGP/Z1VJP/Z1VLP/Z1VTP (AO)

5-2. CTO Information △ [MA]

1. PCG-Z1VA/Z1VAP1/Z1VAP2

PCG-Z1V Series CTO Component List
Ver.1.0

The parts marked "○" are commonly used in all models. For the component of the parts that are not shown here, please refer to the PCG-Z1V* Service Manual.

Configuration Parts		Product Code		28156630	28156530	28156930				
		Model Name		PCG-Z1VA	PCG-Z1VAP1	PCG-Z1VAP2				
M/B	MBX-71 (B3) (S) (CPU:1.7Ghz/Memory (On-Board):512MB)	A-8117-897-A	-	-	○					
	MBX-71 (C3) (S) (CPU 1.6Ghz/Memory (On-Board):512MB)	A-8117-899-A	○	○	-					
HDD	80GB	A-8067-943-A	-	-	○					
	60GB	A-8116-402-A	○	○	-					
LCD	14SXGA+	A-8114-655-A	○	○	○					
Expansion Memory	512MB	A-8067-880-A	-	-	○					
Battery	BP2V	A-8114-137-A	○	○	-					
	BP4V	A-8114-139-A	-	-	○					
Opt.Drive	COMBO DRIVE	1-796-626-12	○	○	○					
W-LAN	Available	1-761-660-13	○	○	○					
Bluetooth	Available	-	○	○	○					
Office	Bundle	-	-	-	-					
OS	WinXP Pro	-	-	○	○					
	WinXP Home	-	○	-	-					

Confidential

PCG-Z1V/Z1VE/Z1VT (J)
PCG-Z1VAP1/Z1VAP2/Z1VA/Z1VFP (AM)
PCG-Z1VCP/Z1VGP/Z1VJP/Z1VLP/Z1VTP (AO)

List of PCG-Z1 Series (As of October, 2003)

Service Manual Parts No.	Model Name			
	J	AM	EU	AO
9-876-075-XX	PCG-Z1/P PCG-Z1T/P			
9-876-076-XX		PCG-Z1A		
9-876-078-XX		PCG-Z1FP		
9-876-077-XX			PCG-Z1M PCG-Z1MP PCG-Z1SP	
9-876-079-XX				PCG-Z1GP
9-876-080-XX				PCG-Z1LP
9-876-331-XX	PCG-Z1R/P PCG-Z1RT/P			
9-876-339-XX		PCG-Z1RA		
9-876-340-XX			PCG-Z1RMP PCG-Z1RSP	
9-876-332-XX				PCG-Z1RGP
9-876-333-XX				PCG-Z1RLP
9-876-335-XX				PCG-Z1RCP
9-876-334-XX				PCG-Z1RTP
9-876-345-XX	PCG-Z1VT/P PCG-Z1V/P PCG-Z1VE	PCG-Z1VAP1 * PCG-Z1VAP2 * PCG-Z1VA * PCG-Z1VFP		PCG-Z1VGP PCG-Z1VLP PCG-Z1VCP PCG-Z1VTP PCG-Z1VJP

* : CTO model

: Additional Models

This manual and the constituent data may not be replicated, copied nor reprinted in whole or in part without prior written authorization of Sony Corporation.

本マニュアルの一部、または全部について、無断でデータの複製、複写、転載することを禁じます。

Revision History

Suffix	Ver.	Date	Contents	QM No.
-01	Ver. 1	2003.09.18	First Edition	
-02	Ver. 2	2003.10.06	△ Front Page (Model Line Up), Page 1-1, Page 3-1, Page 4-1, Page 4-2, Page 4-3, Page 4-4, Page 4-6, Page 5-2, Back Cover	N2003_066AK
-03	Ver. 3	2003.10.23	△ Front Page (Model Line Up), Page 1-1, Page 4-1, Page 4-2, Page 4-3, Page 4-4, Page 4-6, Back Cover	N2003_081AK
<Remarks>				

[Confidential]

PCG-Z1V/Z1VE/Z1VT (J)
 PCG-Z1VAP1/Z1VAP2/Z1VA/Z1VFP (AM)
 PCG-Z1VCP/Z1VGP/Z1VJP/Z1VLP/Z1VTP (AO)