



REMOVAL

1. Remove the battery terminal ("-", "+").



2. Remove the heat shield(A). (Bolt: 1EA(B), Retainer: 3EA(C))

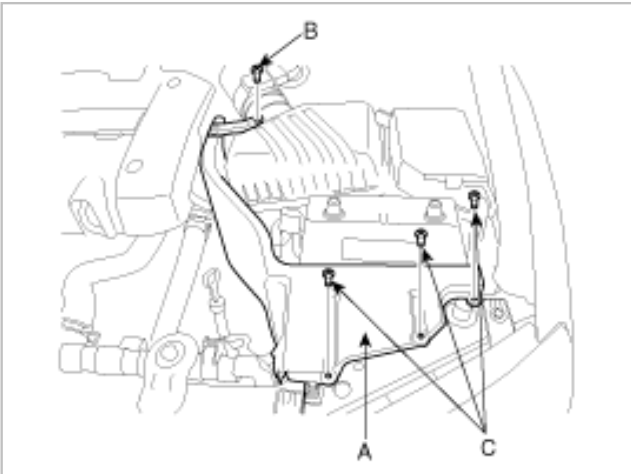

3. Remove the battery and the battery tray(A).

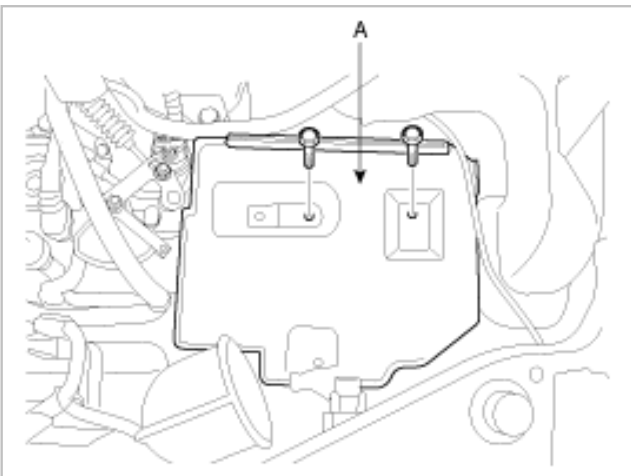

4. Removal of air cleaner and air intake hose.

- (1) Disconnect the air flow sensor connector(A) and breather hose(B).
- (2) Air cleaner upper cover(C) and air intake hose(D).

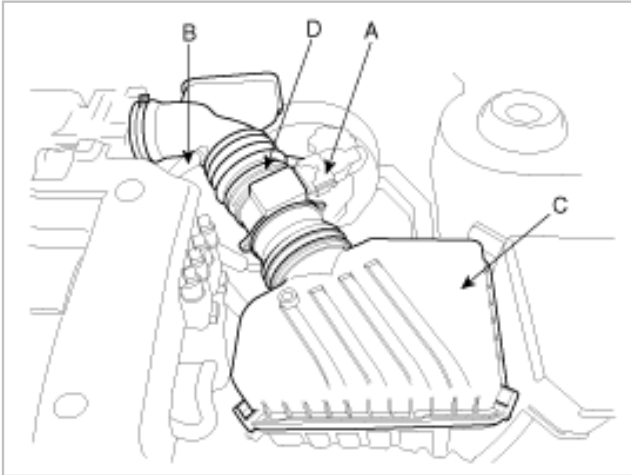

- (3) Air cleaner lower(A) (Bolt: 3EA(B)).

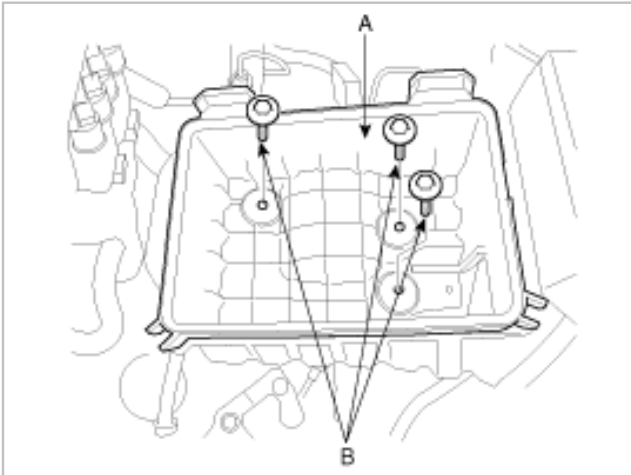

5. Remove the solenoid valve connector(A).

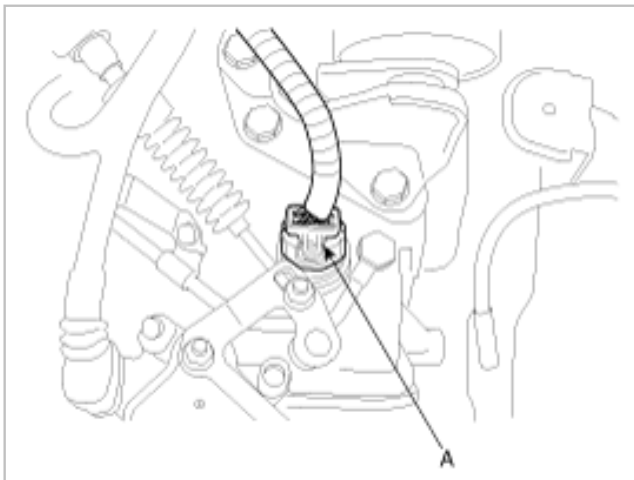

6. Remove the transaxle range switch connector(A).

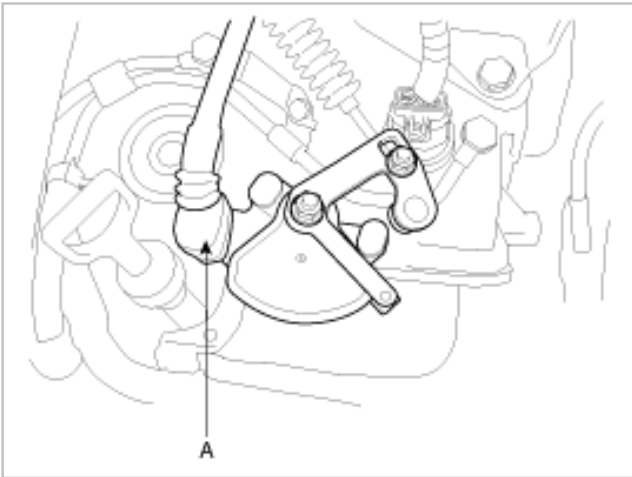

7. Remove the control cable(A) to transaxle range switch mounting nut(B).

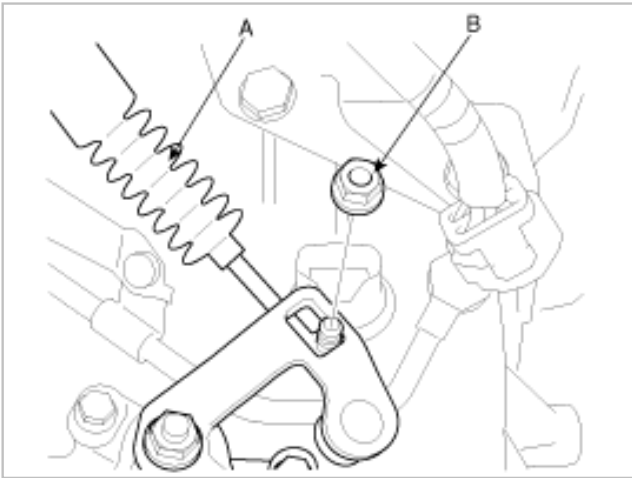

8. Remove the clip(A) of the control cable(B).

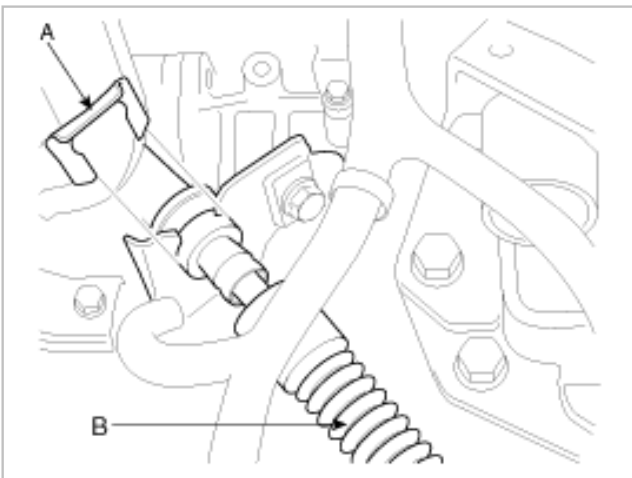

9. Remove the input shaft speed sensor connector(A).

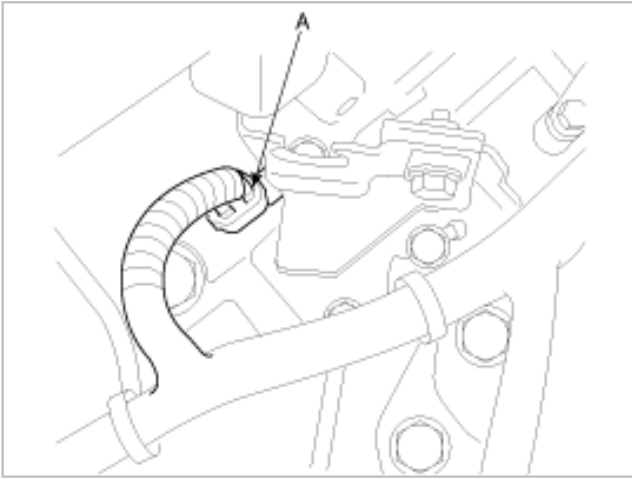

10. Remove the output shaft speed sensor connector(A).

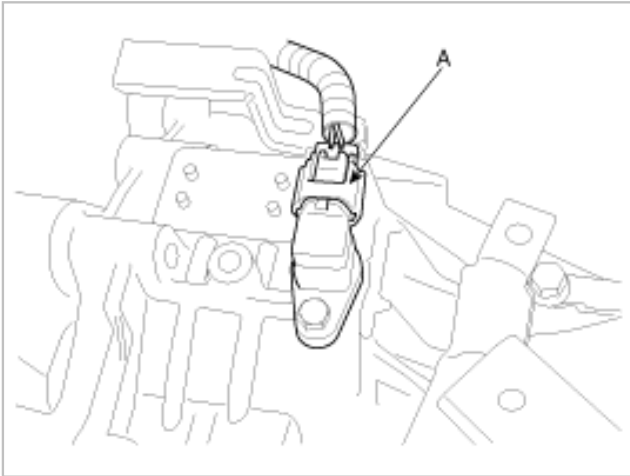

11. Remove the transaxle earth cable(A).

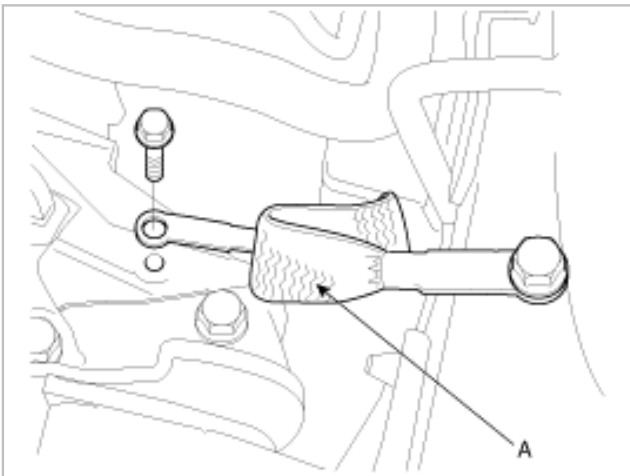

12. Remove the oil cooler hose(A).

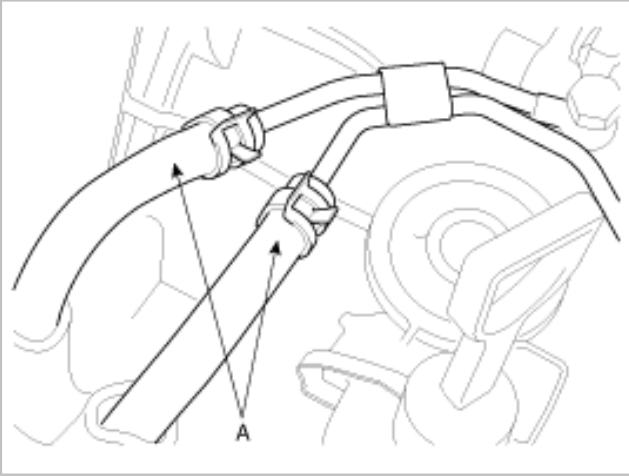

NOTE

To prevent entry of dust or foreign matter, plug the disconnected hoses and transaxle fittings.

13. Remove the start motor cable mounting bolts(A, B).

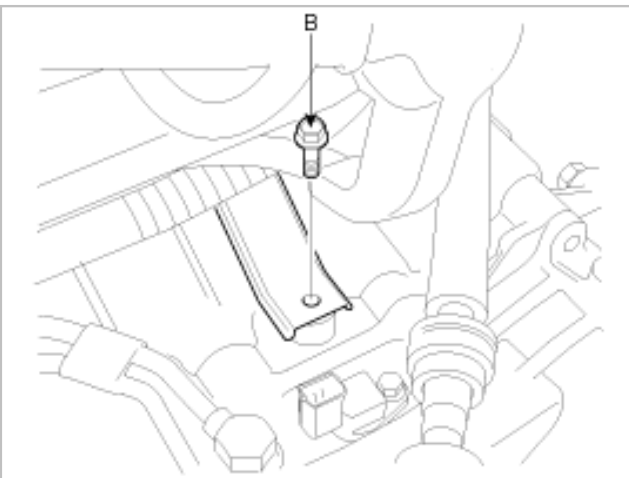
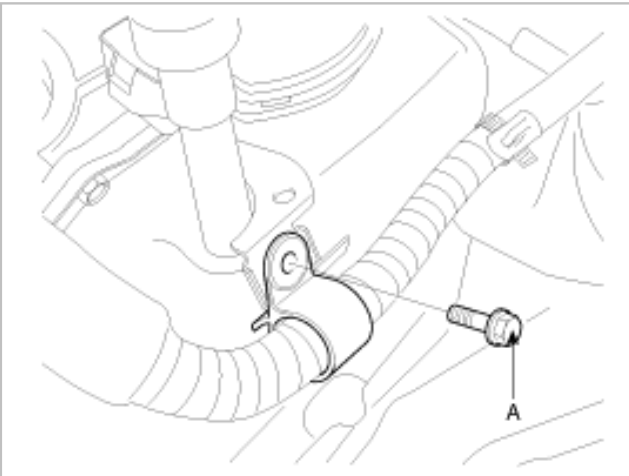

14. Remove the power steering eye bolt(A).

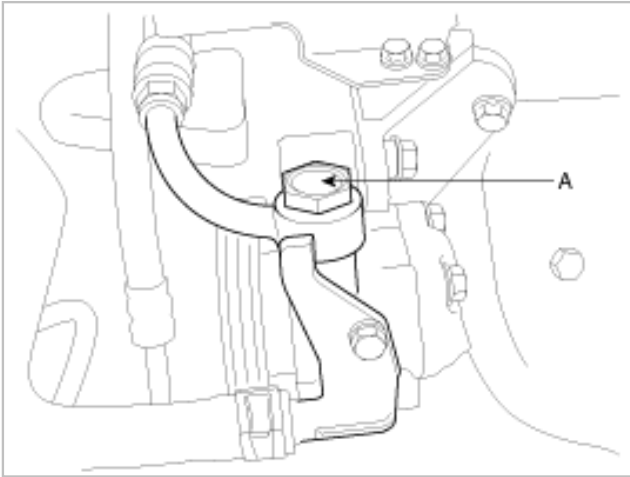

15. Remove the steering u-joint(A) mounting bolt.

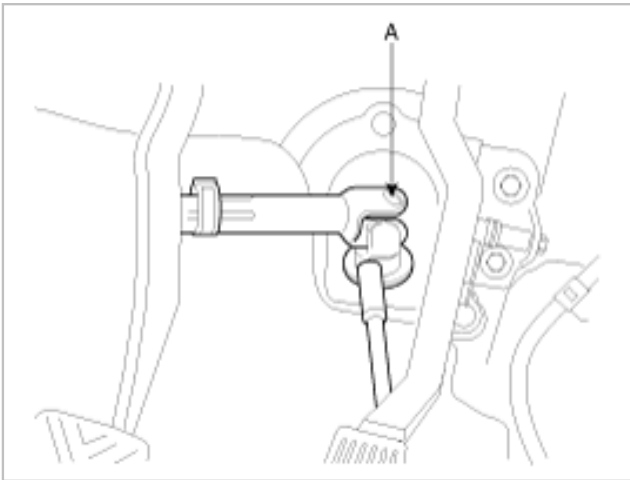

NOTE

Mark a mating line on the steering column universal joint and the gear box before disassembling to make the installation easier.

16. Remove the start motor mounting bolt(A). (1EA)

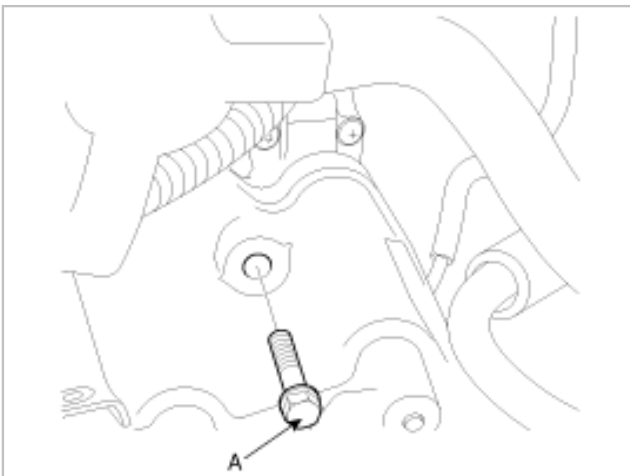

17. Install the special tools (09200-38001, 09200-1C000), the engine support fixture and the adapter, on the engine assembly.

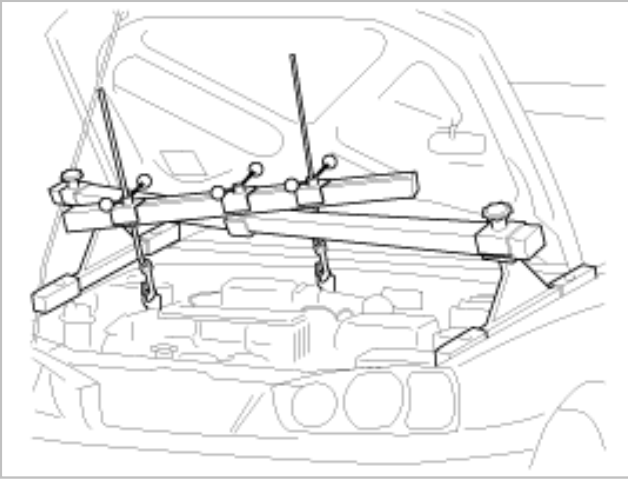

NOTE

When using the special tool, be careful that the hook holder of the special tool doesn't wear the cowl top cover.

18. Remove the transaxle-mounting bracket.

(1) Body mounting bolts(A) (Upper side)

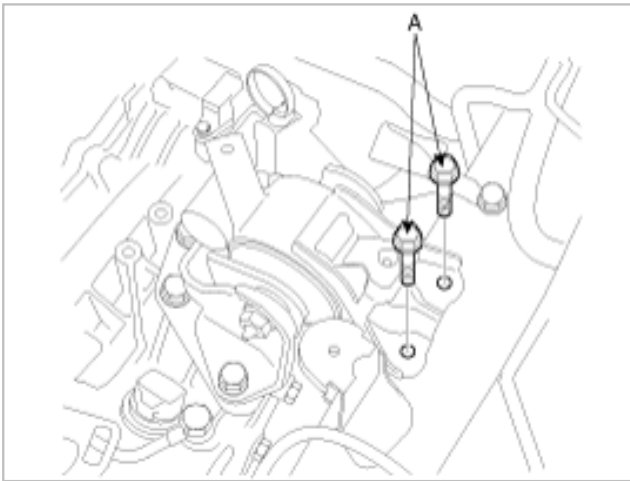

(2) Insulator bolt(A).

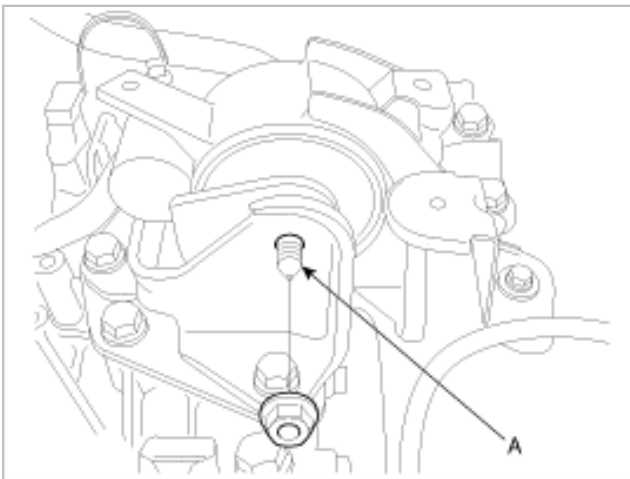

(3) Body mounting bolts(A) (Left side).

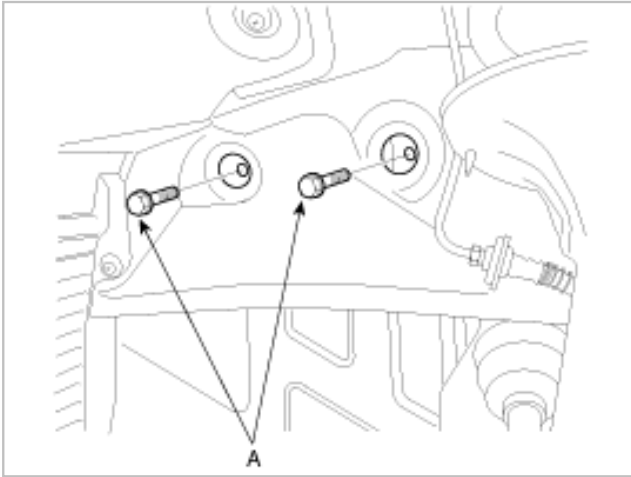

(4) Transaxle mounting bracket(A).

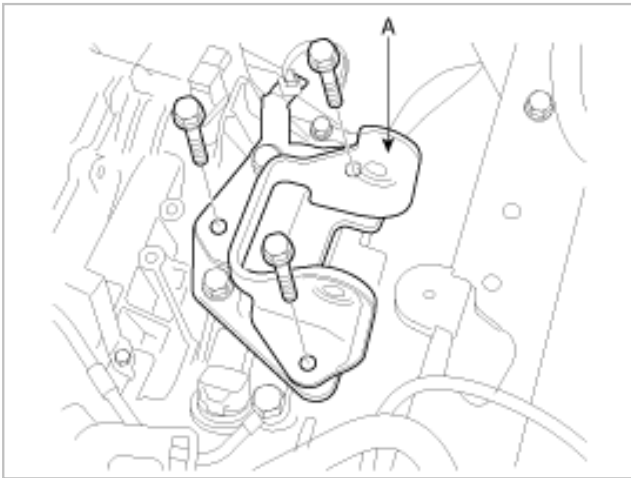

19. Remove front oxygen sensor, engine oil pressure switch(A), crank position sensor(B) connector mounting bracket(C).

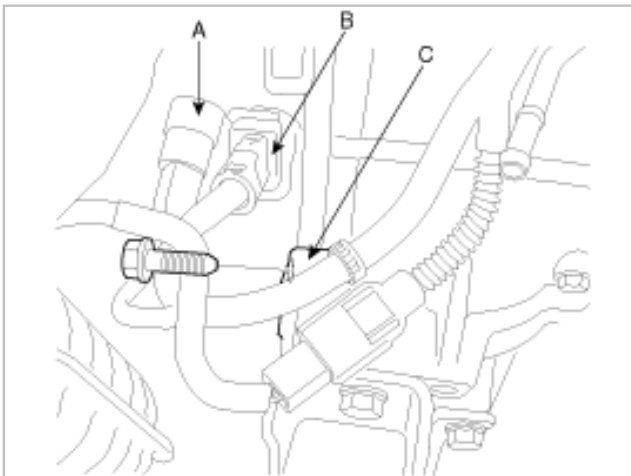

20. Remove the transaxle mounting to the engine bolts(A).

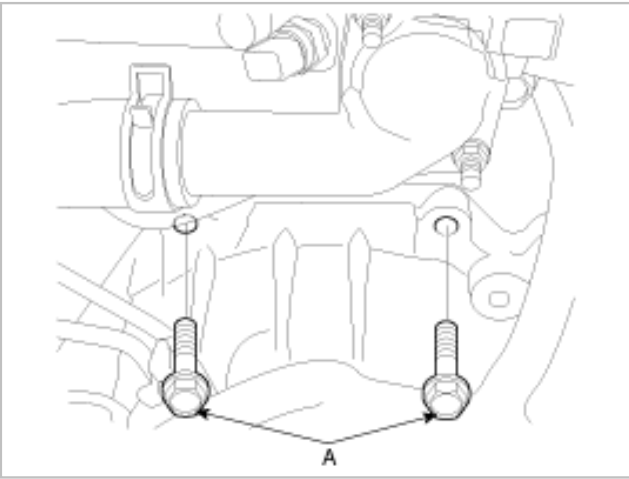

21. Lift up the vehicle.

22. Remove the drain plug(A) and drain the automatic transaxle fluid.

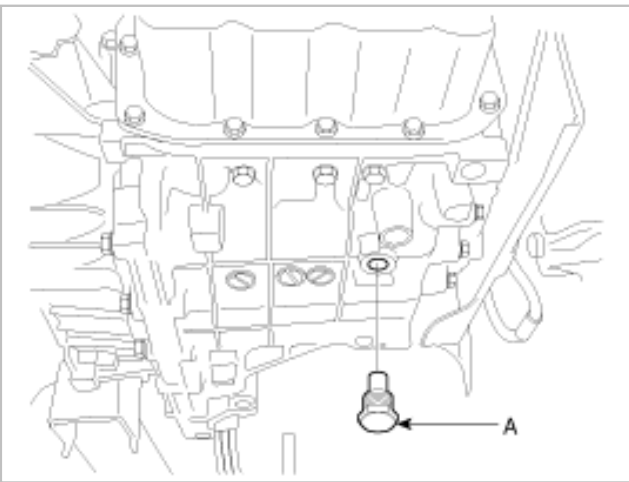

23. Remove the tire

24. Separate the tie rod end(A) from the pin(B) and nut(C).

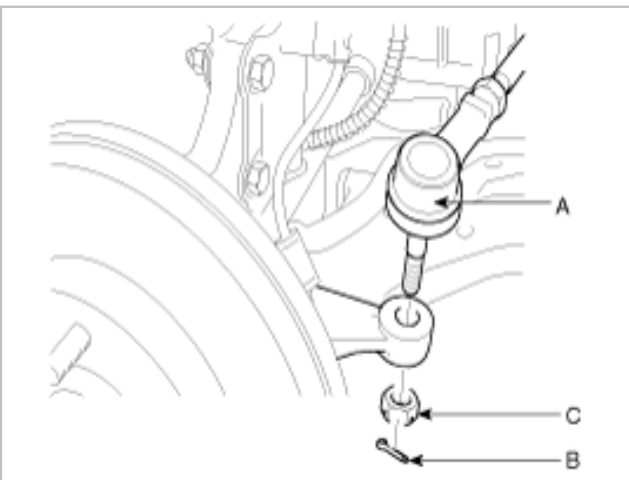

25. Remove the pin(A) and hub nut(B) from the front axle(C).

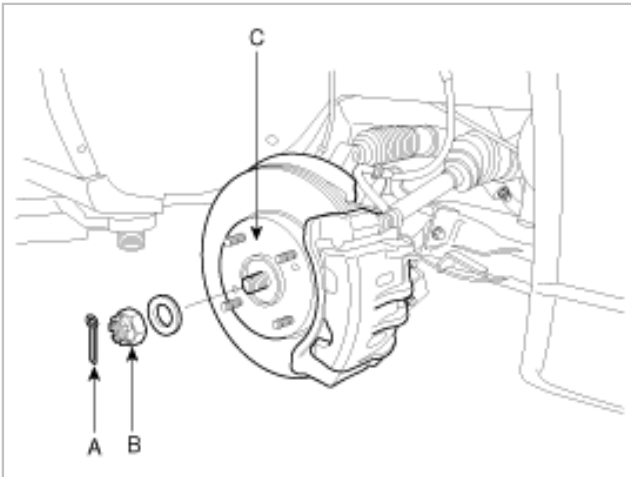

26. Remove the ABS wheel speed sensor(A).

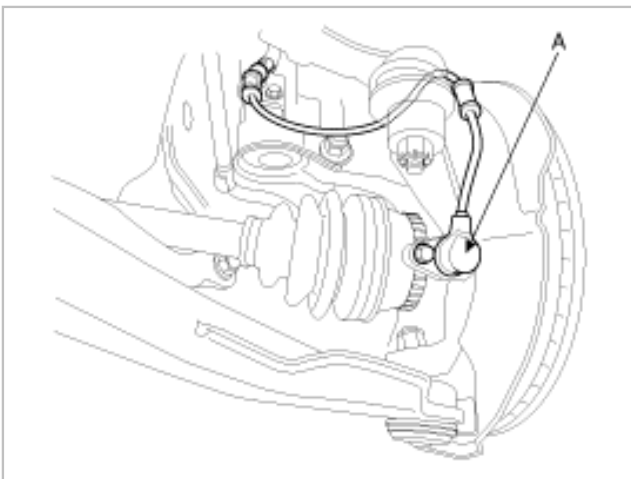

27. Remove the knuckle mounting bolts(A).

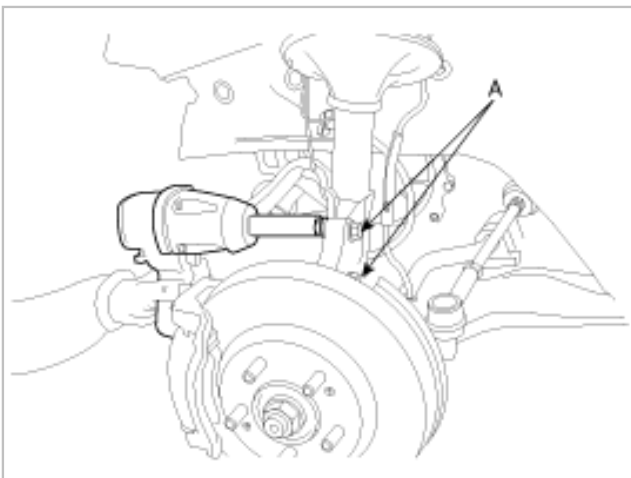

28. Remove the caliper(A).

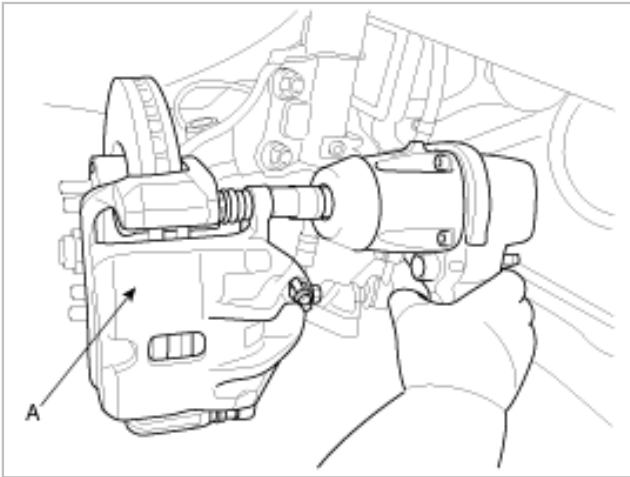

29. Hang the caliper assembly(A).

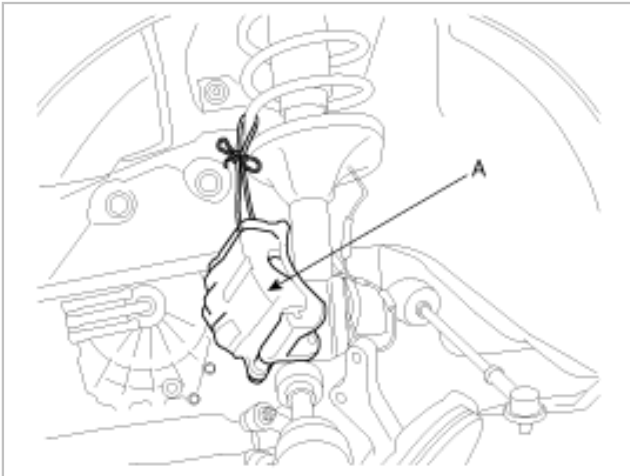

30. Remove the knuckle from the drive shaft.

31. Remove the drive shaft(A) from the transaxle(B).

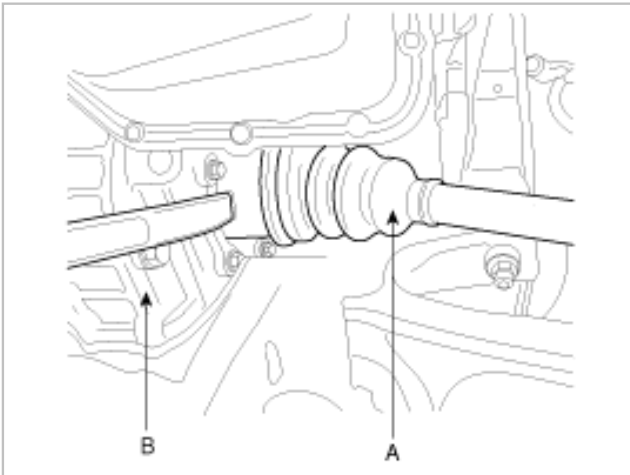

32. Remove the side cover(A).

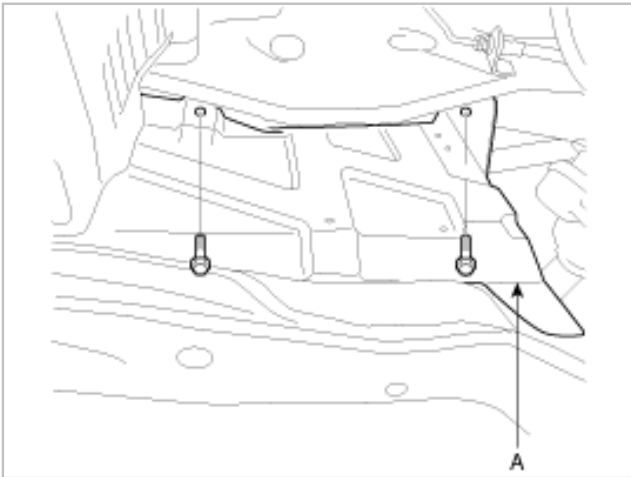

33. Remove the power return hose(A) and drain the power steering oil.

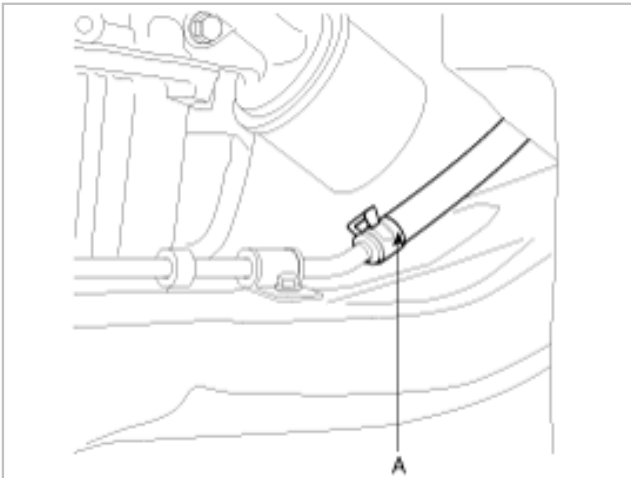

34. Disconnect the rear oxygen sensor connector(A).

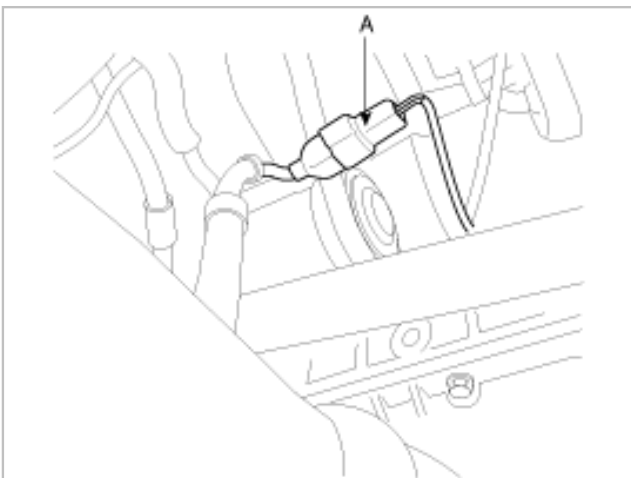

35. Remove the front muffler(A).

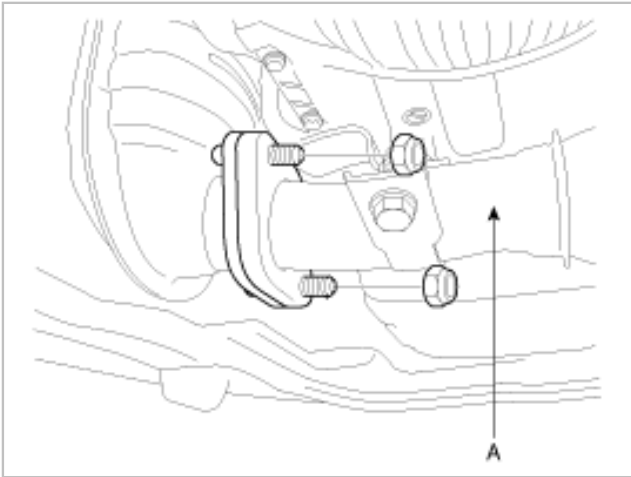

36. Remove the front roll stopper-mounting bolt(A).

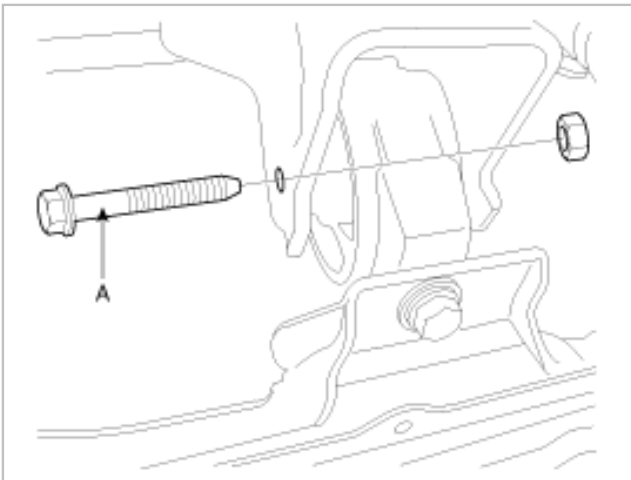

37. Remove the rear roll stopper-mounting bolt(A).

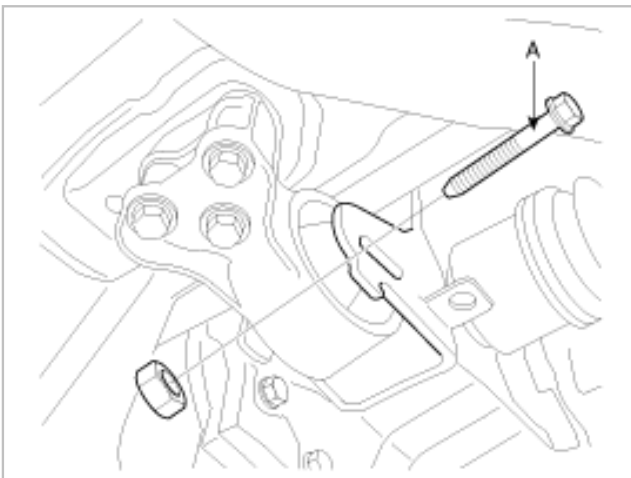

38. Remove the vehicle speed sensor connector(A).

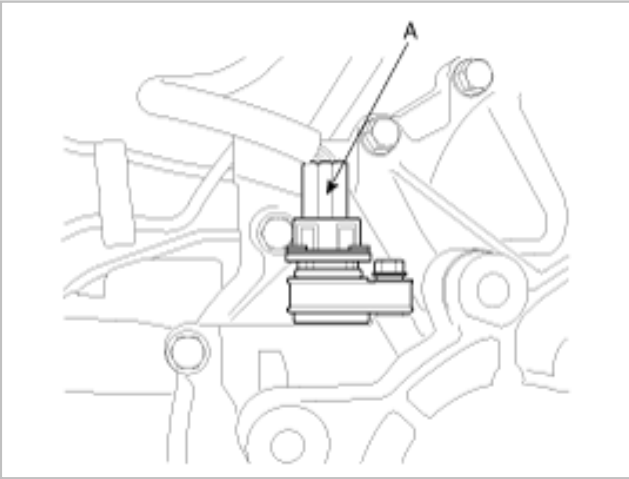

39. Install the jack(A).

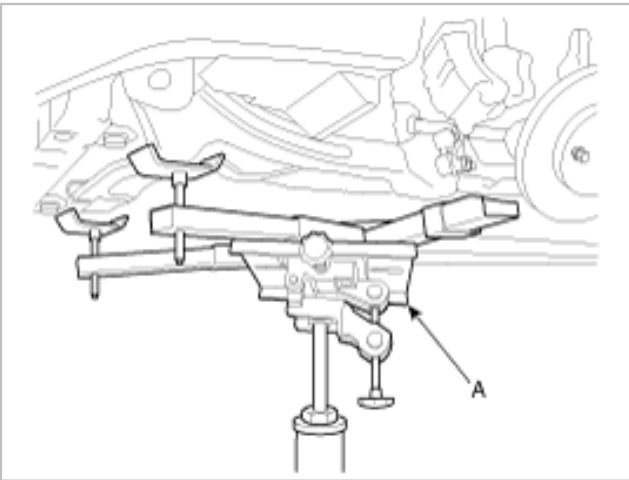

40. Remove the sub frame(A).

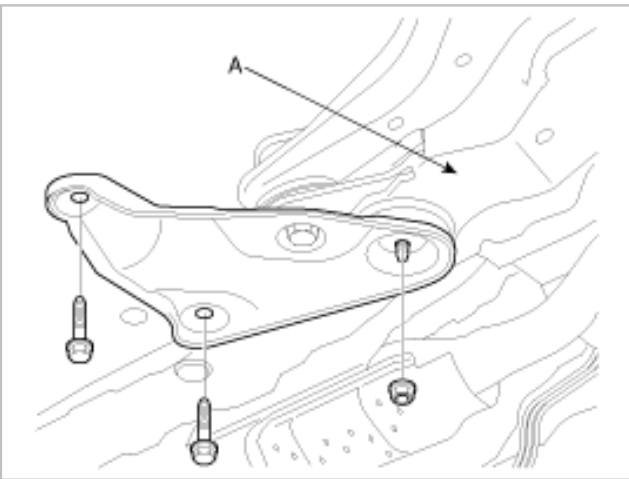

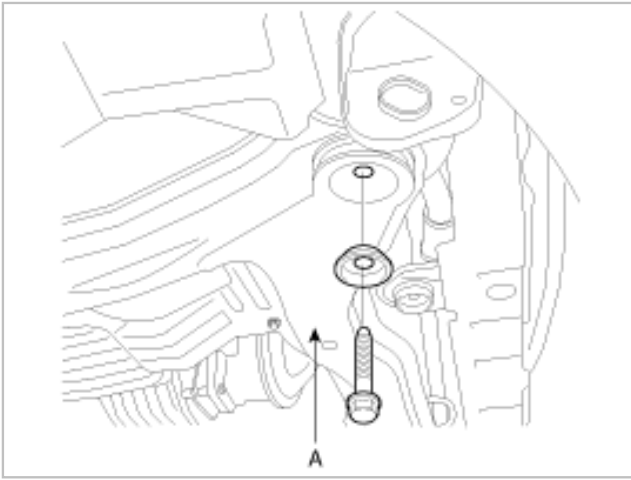

41. Remove the start motor mounting bolt.

42. Remove the engine to the torque converter mounting bolts(A). (4EA)

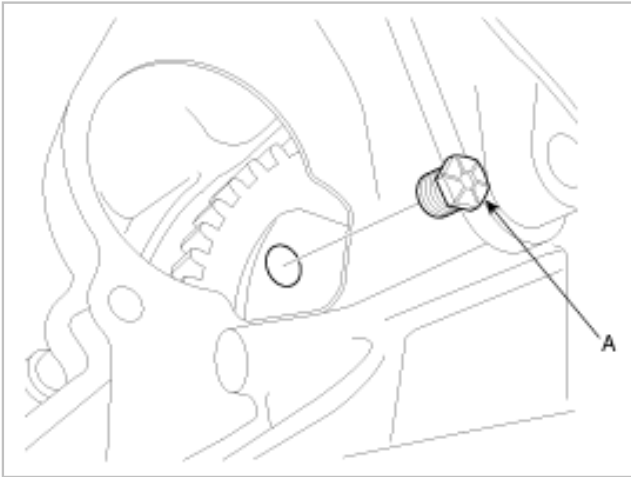

43. Install the jack(A) for supporting transaxle.

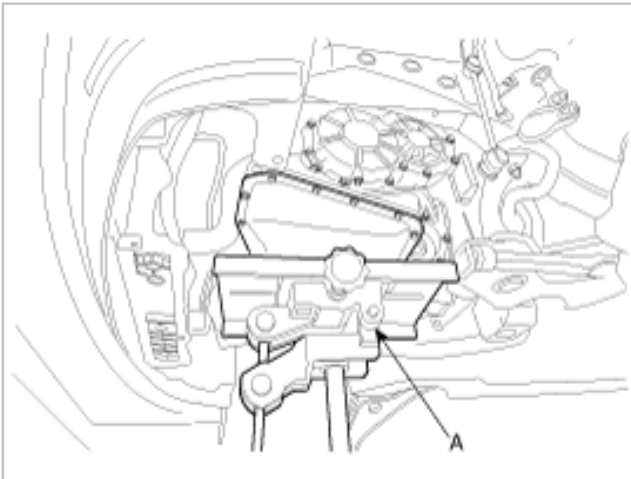

44. Remove the engine to automatic transaxle mounting bolts.

(1) Transaxle to engine mounting bolt(A).

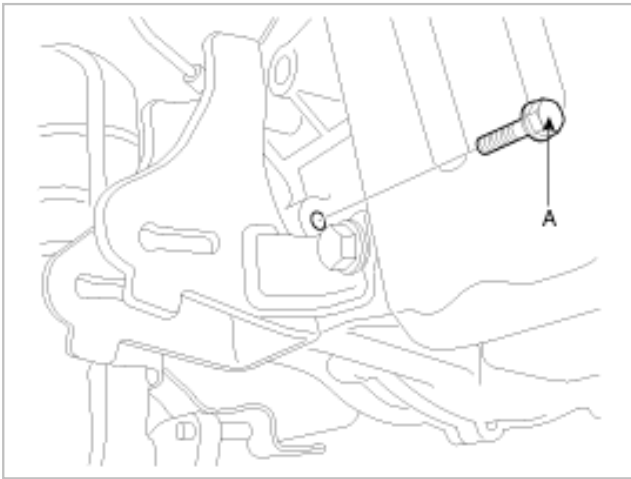

(2) Engine to transaxle mounting bolt(A).

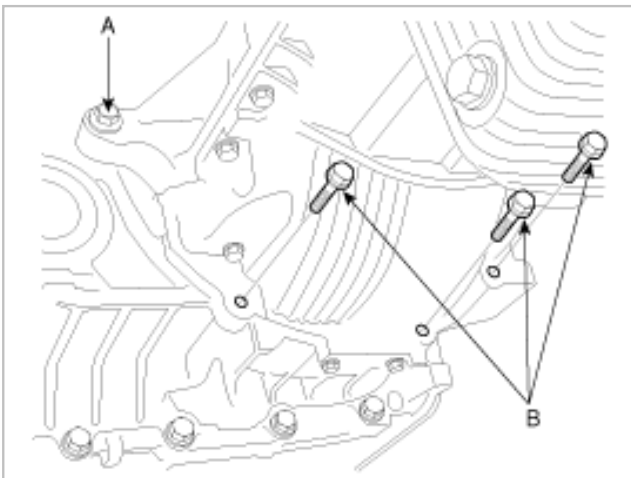

(3) Engine oil pan to transaxle mounting bolts(B).

45. Remove the transaxle.

ON-VEHICLE REPAIR

DRIVE SHAFT OIL SEAL REPLACEMENT

1. Disconnect the drive shaft from the transaxle. (see to "DS" group)
2. Using a flat-tip screwdriver, remove the oil seal.

INSTALLATION

1. Apply a coating of gear oil to the lip of the oil seal.

Auto transaxle fluid :

HYUNDAI GENUINE ATF, DIAMOND ATF SP-III, SK ATF SP-III

- Using the special tool (09431-21200) name, tap the drive shaft oil seal into the transaxle.

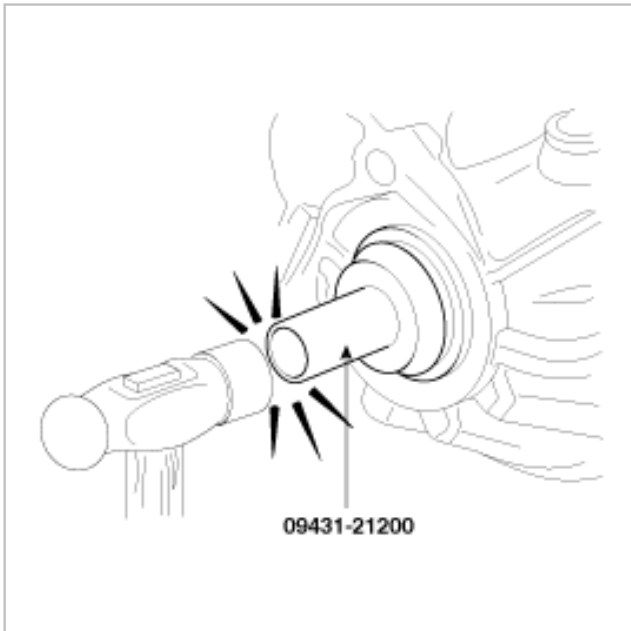

- Installation is the reverse of removal.
- Refill the transaxle fluid.
- Start engine and the transaxle range selector lever through all gear positions. Refill as necessary.

TRANSAXLE RANGE SWITCH REPLACEMENT

- Remove the battery terminal.



- Remove the heat shield(A) (Bolt: 1EA(B), Retainer: 3EA(C)).

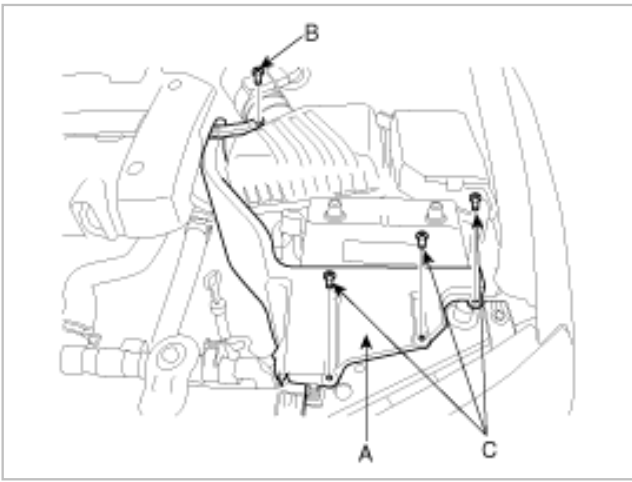

3. Remove the battery and battery tray(A).

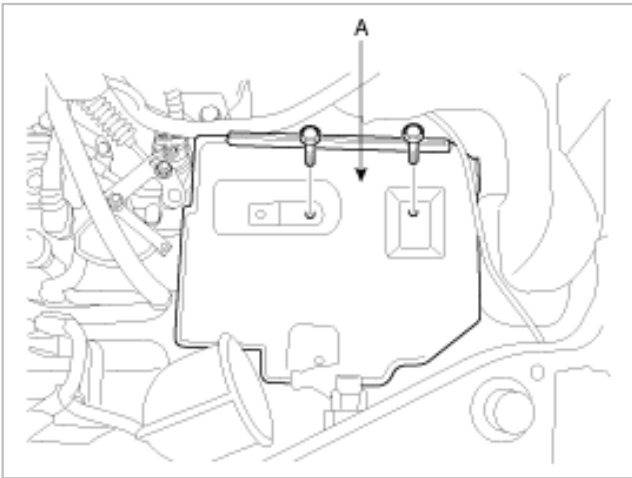

4. Disconnect the air flow sensor connector(A) and breather hose(B).

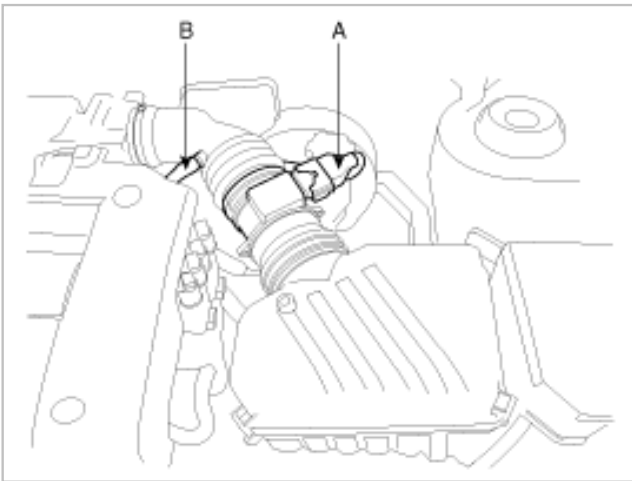

5. Removal of air cleaner and air intake hose.

A. Air cleaner upper cover(C) and air intake hose(D).

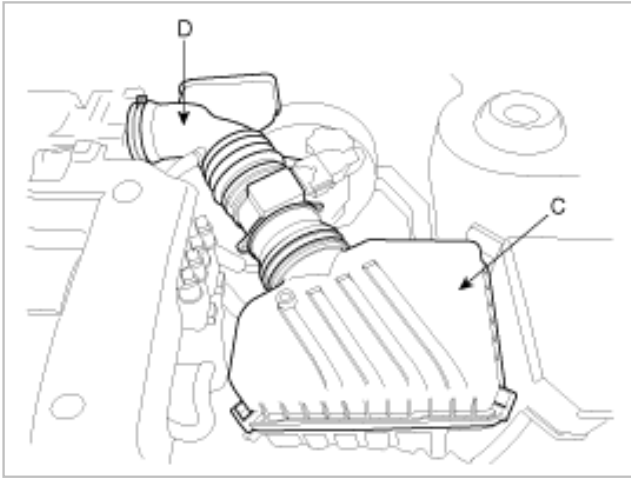

B. Air cleaner lower(A) (Bolt: 3EA(B)).

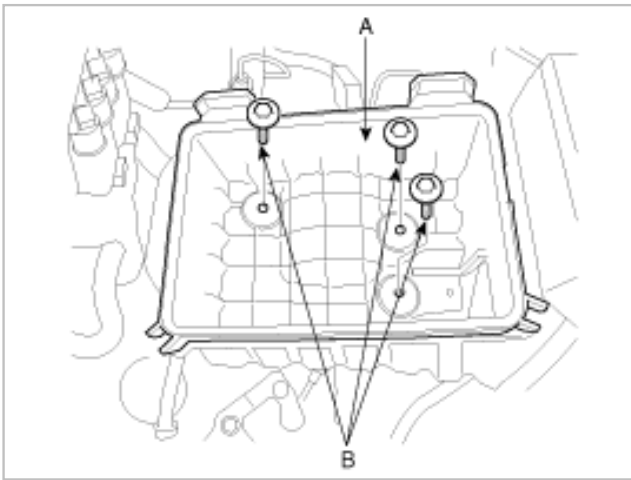

6. Remove the transaxle range switch connector(A).

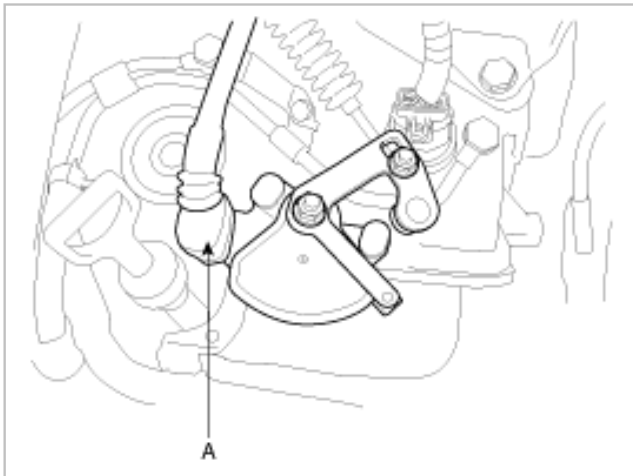

7. Remove the control cable to transaxle range switch(A) mounting nut(B).

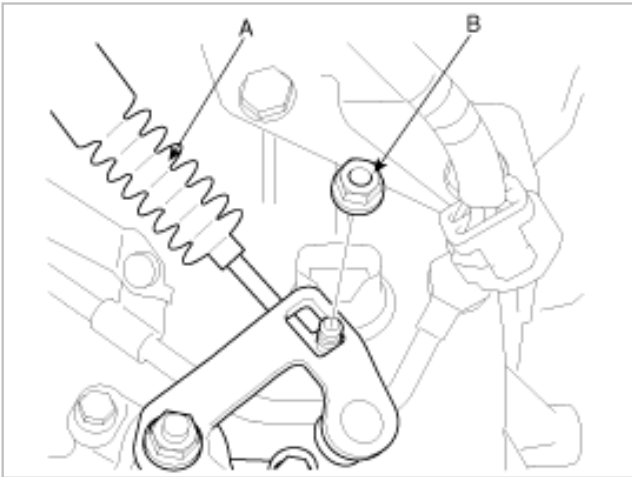

8. Remove the transaxle range switch manual lever mounting nut(A).

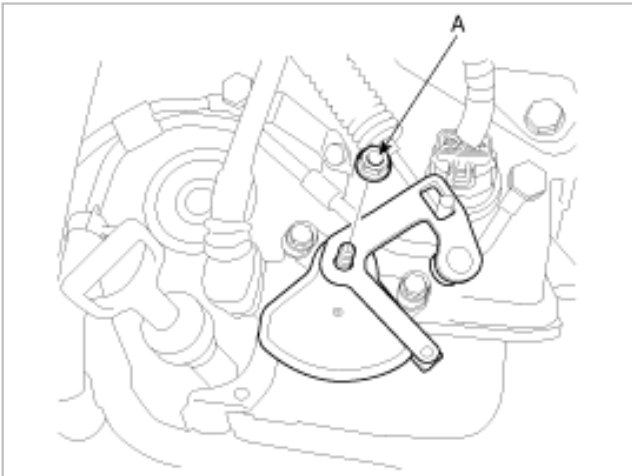

9. Remove the transaxle range switch(A).

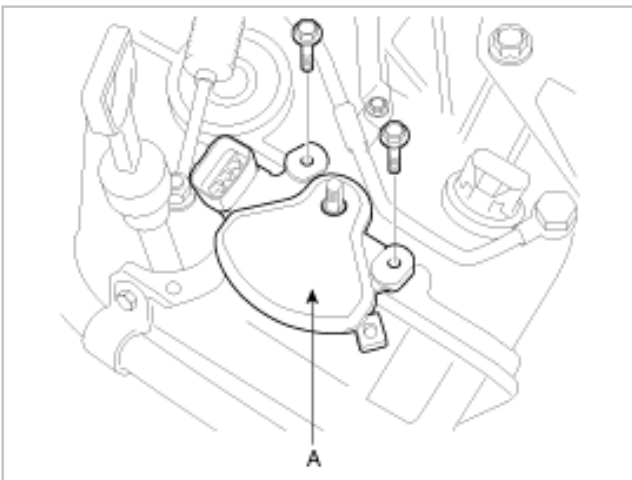

INSTALLATION

Refer to Transaxle range switch and control cable adjustment.

INPUT SHAFT SPEED SENSOR REPLACEMENT

1. Removal of the battery and air cleaner (see the page TR-119 "Transaxle range switch replacement").
2. Remove the transaxle range switch connector.
3. Remove the control cable to transaxle range switch mounting nut.

4. Remove the clip(A) of the control cable(B).

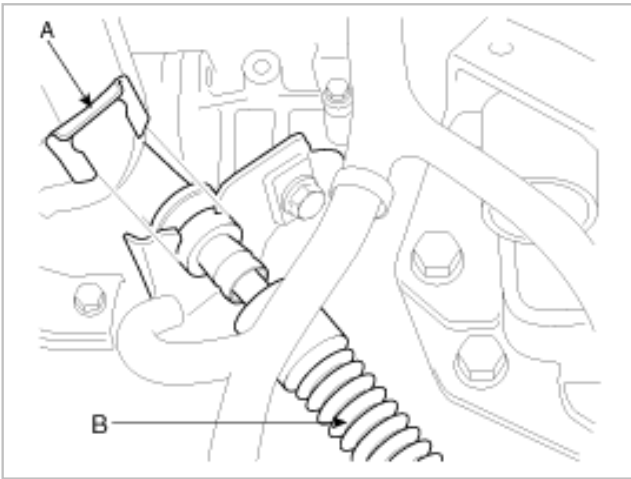

5. Remove the control cable mounting bracket.
6. Remove the input shaft speed sensor(A).
 - (1) Disconnect the input shaft speed sensor connector.
 - (2) Remove the bolt(B).

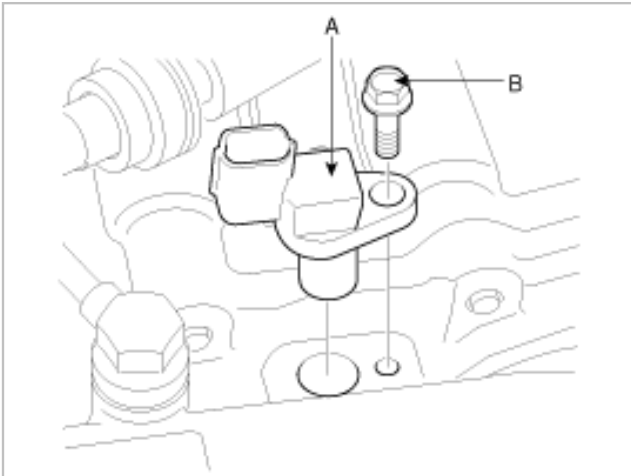

- (3) Inspect the input shaft speed sensor bore.

INSTALLATION

1. Apply a light coat of automatic transaxle fluid to the O-ring seal before installation.
2. Install the input shaft speed sensor.
3. Install the control cable mounting bracket.
4. Connect the input shaft speed sensor connector.
5. Install the clip of the control cable.
6. Adjust the control cable to transaxle range switch and tight the transaxle manual lever to the control cable mounting nut. (see the page TR-27 "Transaxle range switch and control cable adjustment")
7. Installation is the reverse of removal.

OUTPUT SHAFT SPEED SENSOR REPLACEMENT

1. Removal of the battery and air cleaner. (see the page TR-119 "Transaxle range switch replacemtn")

2. Remove the output shaft speed sensor(A).

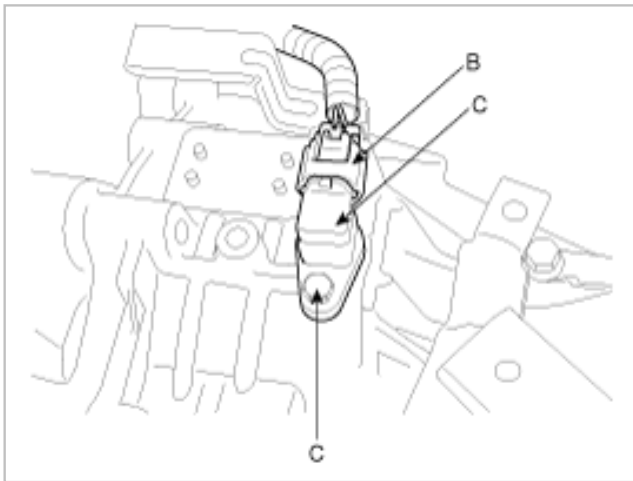

- (1) Disconnect the output shaft speed sensor connector(B).
- (2) Remove the bolt(C).
- (3) Inspect the output shaft speed sensor bore.

INSTALLATION

1. Apply a light coat of automatic transaxle fluid to the O-ring seal before installation.
2. Installation is the reverse of removal.

VEHICLE SPEED SENSOR REPLACEMENT

1. Lift up the vehicle.
2. Remove the vehicle speed sensor(A).

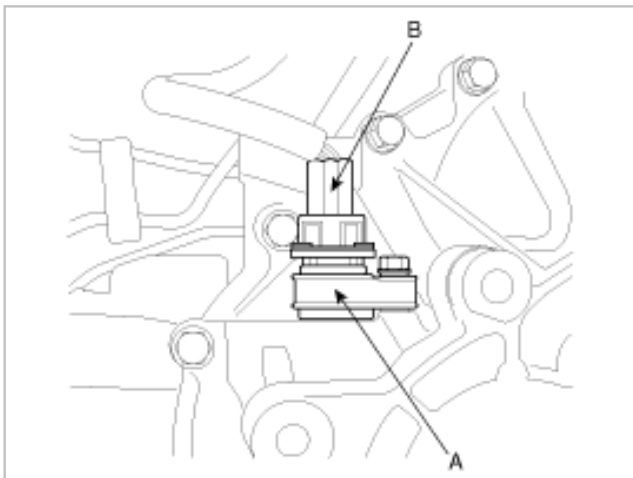

- (1) Disconnect the vehicle speed sensor connector(B).
 - (2) Remove the bolt (10mm).
 - (3) Inspect the vehicle speed sensor bore.
3. Inspect the O-ring for nicks or cut. Install a new O-ring as necessary.

INSTALLATION

1. Apply a light coat of automatic transaxle fluid to the O-ring seal before installation.
2. Install the vehicle speed sensor.
3. Connect the vehicle speed sensor connector.
4. Installation is the reverse of removal.

ATM CONTROL CABLE REPLACEMENT

1. Remove the control cable to transaxle range switch mounting nut. (see the page TR-119 "Transaxle range switch replacement").
2. Remove the clip of the control cable.
3. Remove the console (Screw : 6EA)
4. Remove the control cable pin.
5. Remove the clip of the control cable by pressing it with the driver.
6. Remove the control cable mounting nuts(A).



7. Remove the mounting bolts of the cable of the lower dashboard side to remove the cable.

INSTALLATION

1. See the page TR-27 "Transaxle range switch and control cable adjustment"
2. Installation is the reverse of removal.

INSTALLATION

1. Attach the torque converter on the transaxle side and mount the transaxle assembly onto the engine.

CAUTION

If the torque converter is mounted first on the engine, the oil seal on the transaxle may be damaged. Therefore, be sure to first assemble the torque converter to the transaxle.

2. Install the transaxle control cable and adjust as follows.
 - (1) Move the shift lever and the transaxle range switch to the "N" position, and install the control cable.
 - (2) When connecting the control cable to the transaxle mounting bracket, install the clip until it contacts the control cable.
 - (3) Remove any free-play in the control cable by adjusting nut and then check to see that the selector lever moves smoothly.

(4) Check to see that the control cable has been adjusted correctly.

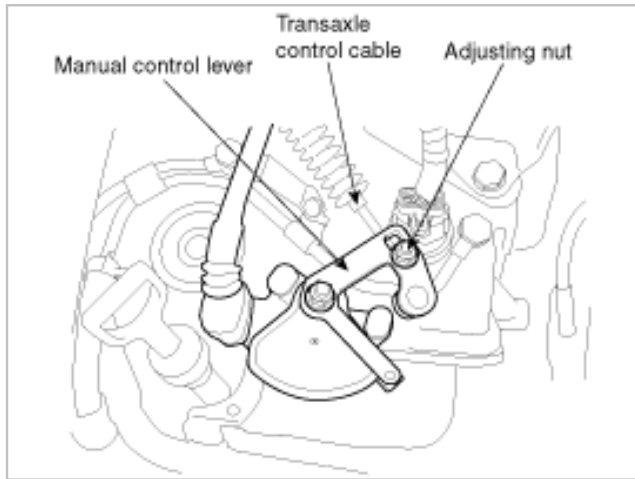

3. Installation is the reverse of removal.