

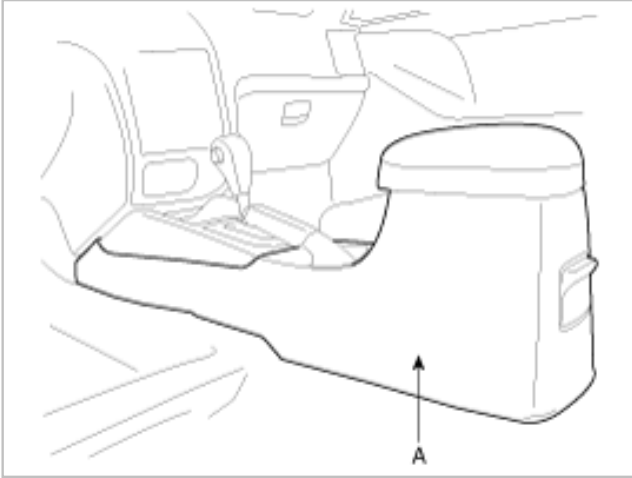

REMOVAL

1. Remove the console(A) mounting screws (6EA).



2. Remove the console(A).

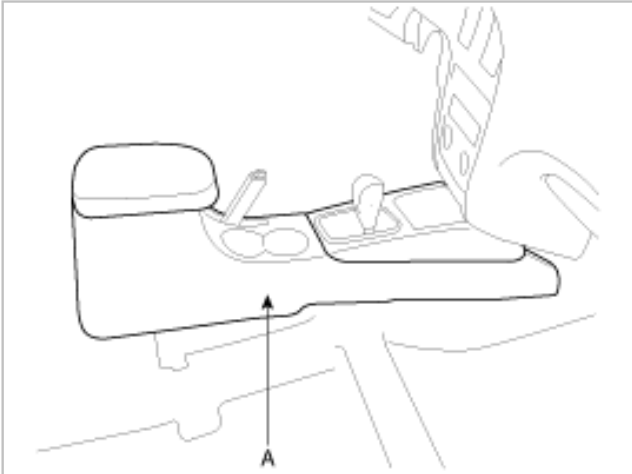

3. Remove the control cable pin(A).

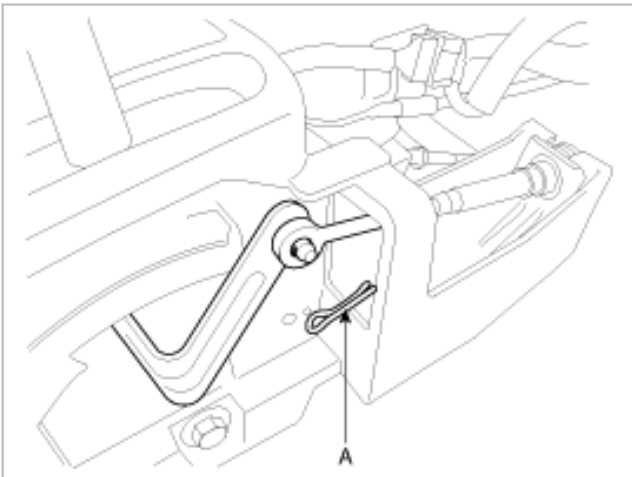

4. Remove the clip(A) of the control cable(B) by pressing it with the driver.

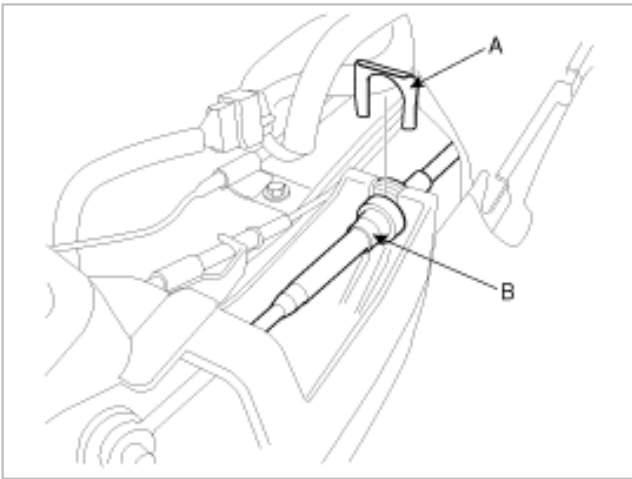

5. Separate the shift lock cable(A) from the P-lock cam(B).

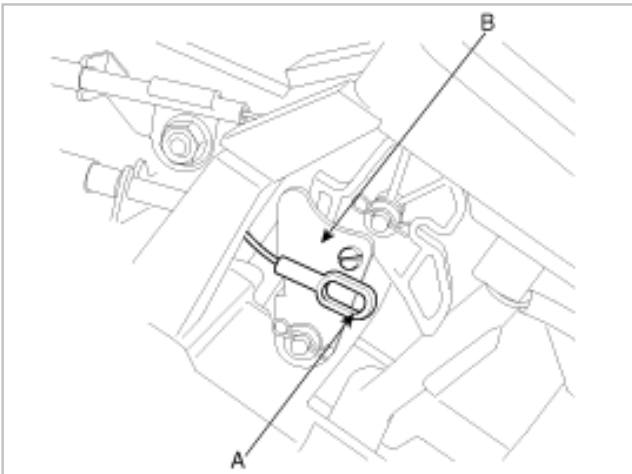

6. Remove the shift lock cable(A) mounting nut(B).

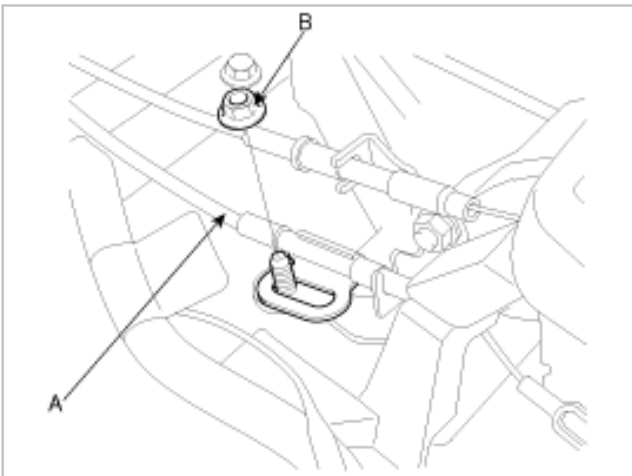

7. Remove the inter lock cable(A) from the key-lock cam(B).

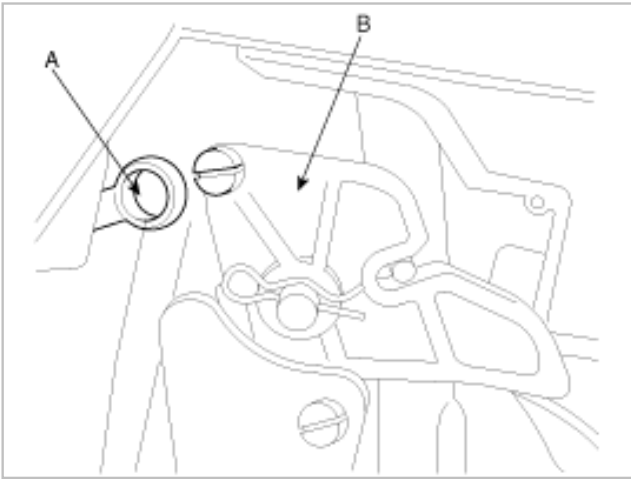

8. Remove the inter lock cable mounting bolt(A).

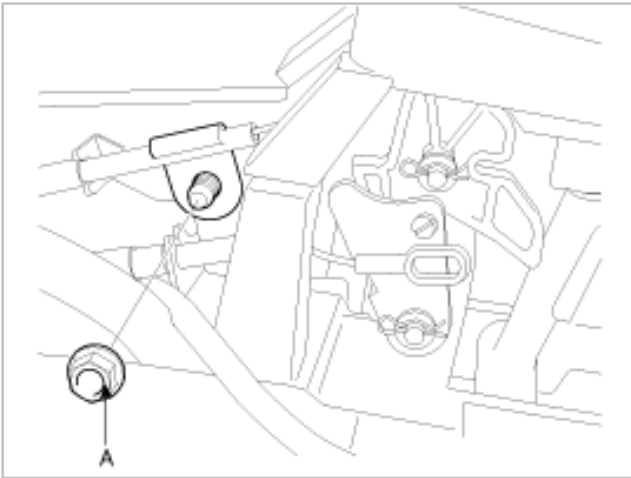

9. Remove the mounting bolts(A) of the cable of the lower dashboard side to remove the cable.



10. Remove the indicator connector(A).

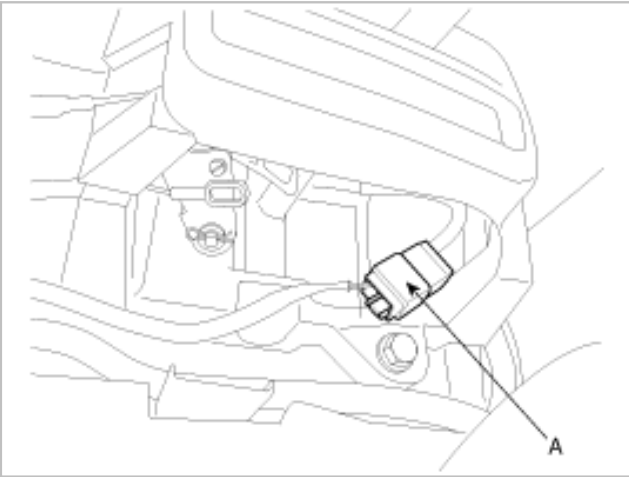

11. Remove the shift lever mounting bracket (Bolts : 4EA(A)).

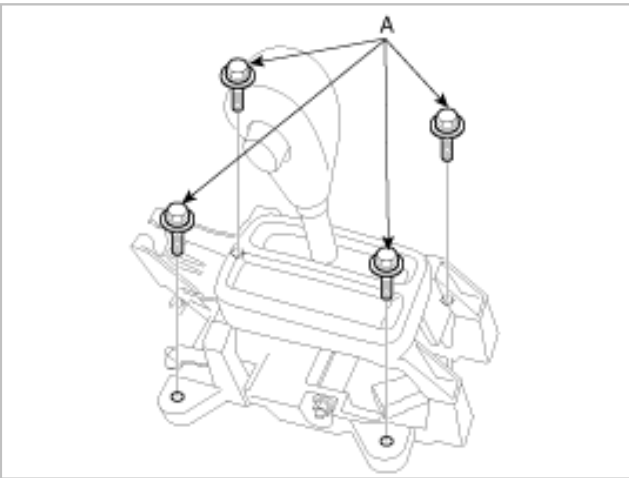

INSTALLATION

NOTE

When servicing the shift lock device, follow the service instructions and procedures described below to ensure proper operation.

1. Procedure to install the lock cam

- (1) Move the P-lock cam to direction "A" and hold it by hand (Refer to figure 1).
- (2) Check that the key lock cam is located at "B" by detent pin (Refer to figure 1,2).

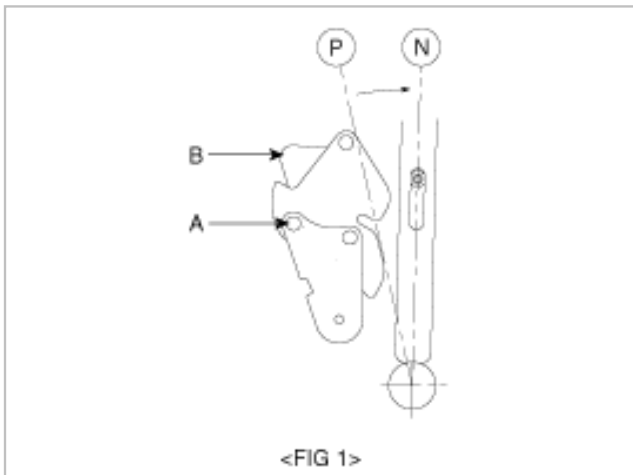

2. Procedure for adjusting the shift lock and key lock cable

- (1) Check that each lock cam is located in position as shown in figure 2.

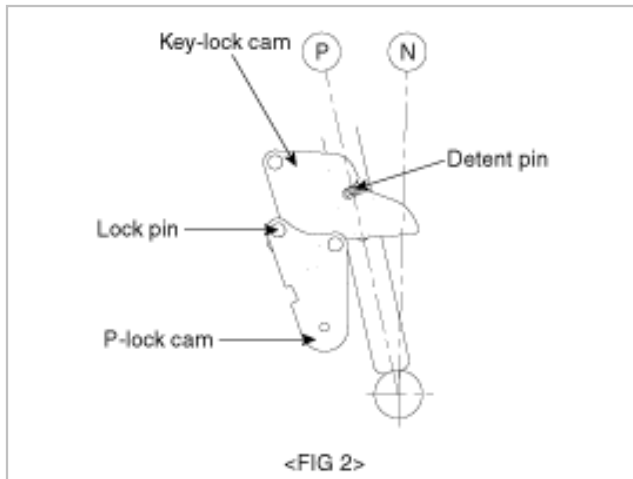

- (2) Install the shift lock cable and key lock cable in position. In this case, the key lock cable must be fixed to the key cylinder and the shift lock cable must be fixed to the brake pedal in position.
- (3) Temporarily install each cable to the A/T lever assembly as shown in figure 3. Securely insert the cable into the fixing pin of each cam.

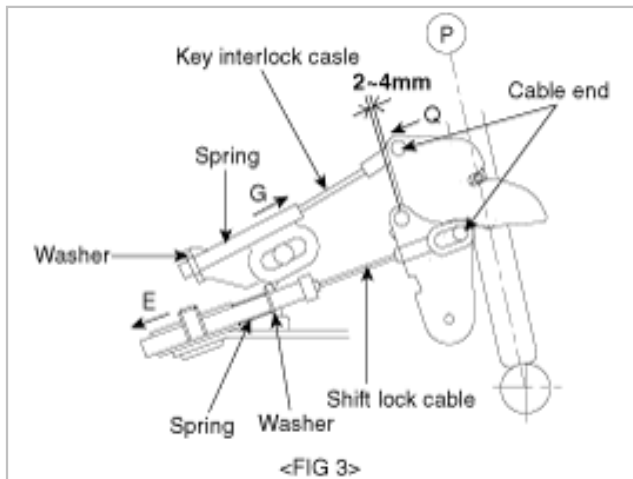

- (4) Keep a gap of 2~4mm between the key lock cam and the P-lock cam to eliminate cable slack by pulling the shift lock cable slightly in the direction of "E" (Refer to figure 3).

CAUTION

If the gap is not maintained between 2 and 4mm, the brake pedal will have to be depressed more than required when operating the push button of the shift lever.

- (5) After checking that a portion of the cable end touches cable fixing pin of the P-lock cam, fix the shift lock cable to the A/T lever with the nut and fix the shift lock cable end with the washer and snap pin.
- (6) Slightly push the key lock cam in the direction of "Q".
- (7) Performing the work of 6, slightly pull the key lock cable in the direction of "G" to stretch the cable tight and then fix it with a nut (Refer to figure 3,4).

- (8) Be sure to check whether the key lock cable is inserted into the fixing pin of the key lock cam, and then fix it with the washer and snap pin. At this time, check if the P-lock cam is fixed to the shift lock cable as shown in the figure 4.

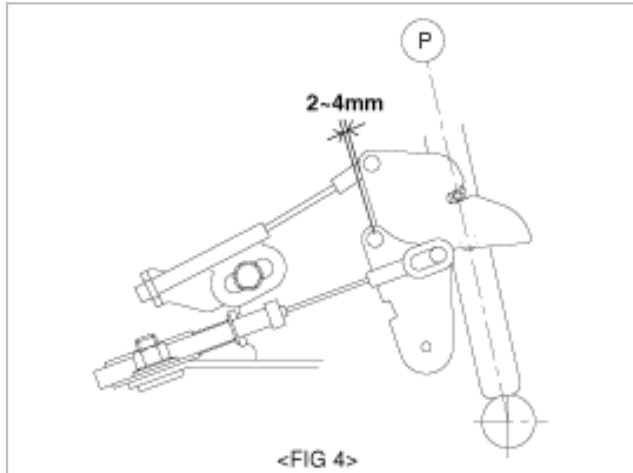

3. Procedure for checking for correct shift lock installation

- (1) When the brake pedal is not depressed, the push button of the shift lever in the "P" position cannot operate (shift lever cannot shift to other positions from "P"). Push button can be operated at other positions except "P".
- (2) When the brake pedal stroke is 15~25mm (with shift lever in the "P" position), push button should operate without catching and the shift lever can shift smoothly out of "P".
- (3) When the brake pedal is not depressed, the shift lever should be shift smoothly to the "P" position from other positions.
Brake pedal must operate smoothly without catching in all positions.
- (4) When the ignition key is at the "LOCK" position, although brake pedal is depressed, the push button should operate.
- (5) Ignition key must not turn to the "LOCK" position, except when in "P" position.
- (6) If the shift lever is shifted to the "P" position, the ignition key must be able to turn to the "LOCK" position smoothly.

4. Caution in service

- (1) Keep the gap of 2~4MM between the key lock cam and P-lock cam by pulling the shift lock cable in the direction of "E" slightly, and then fix the cable with a nut. After this, be sure to check that the gap is within 2~4mm.

NOTE

If the gap is not maintained between 2 and 4mm, the brake pedal will have to be depressed more than required in order to shift the lever from "P" to other position.

- (2) Be sure that the key lock cable slack is eliminated.

NOTE

If slack in the key lock cable is not eliminated, the ignition key can not be removed from the key cylinder and the shift lever will be able to shift from "P" to other positions, although the key is in the "LOCK" position.

(3) Before and after the relating work, the key lock cam and P-lock cam should not be in the same condition as the figure 5 and 6.

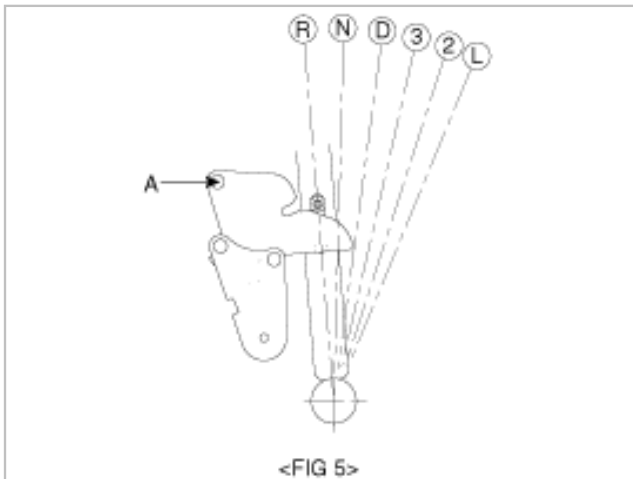

NOTE

When the key lock cam and P-lock cam are in the same condition as the figure 5, shifting the shift lever from D, 2, L positions to P, R, N by force may cause a malfunction of related parts. Under the condition in figure 5, shift the shift lever from D, 2, L to P, R, N after rotating the P-lock cam in the direction of "A". Under the condition in figure 6, shift the shift lever from D, 2, L to P, R, N after rotating the P-lock cam in the direction of "A" the depressing the brake pedal.

KEY INTERLOCK DEVICE INSTALLATION

It is expected that the ignition key may not be removed from the key cylinder due to misassembly of the key interlock cable. To prevent this problem, apply the following installation instructions when servicing.

1. Assembly of key interlock cable and ignition lock

- (1) The ignition lock assembled to the steering column. Set the ignition lock to the lock position.
- (2) Assemble the key interlock cable and the ignition lock with the set screw.

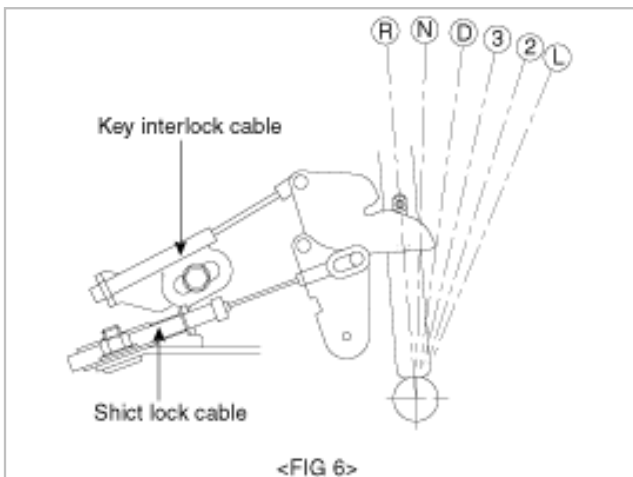

2. Assembly of key interlock cable and shift lever

- (1) Set the shift lever to the "P" position.
- (2) After setting the key interlock cable as shown in the figure 7, temporarily assemble the key interlock cable with a M8 nut just enough to move the key interlock cable plate by its spring force.

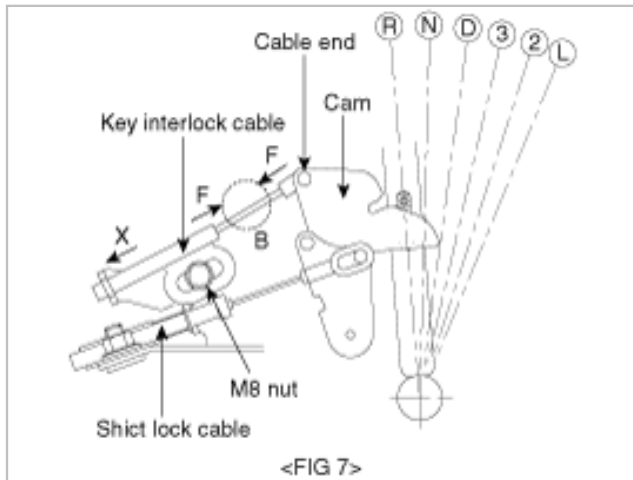

- (3) Holding the cable and the key interlock cable plate, push them into the direction of "F" so as not to create any bending or slack on the "B" point of the key interlock cable.

NOTE

Do not pull the cable in the direction of "X" to remove the slack. This may cause key not to remove from the key cylinder.

- (4) Tighten the key interlock cable with a M8 nut.

INSPECTION

- Check the detent for wear.
- Check the bushing for wear or damage.
- Check the spring for damage or deterioration.
- Check the pin at the end of the rod assembly for wear.