

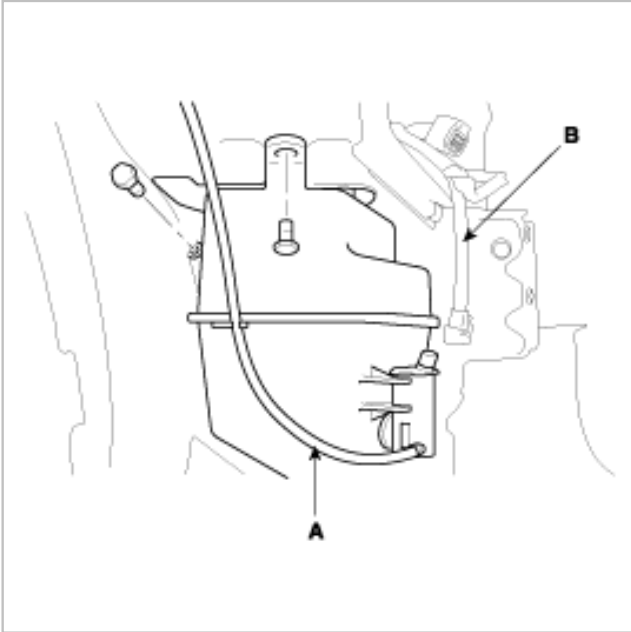

## REMOVAL

1. Disconnect the negative(-) battery terminal.
2. Remove the front bumper cover. (Refer to BD group)
3. Remove the washer hose(A) and the washer motor connector(B).
4. Remove the washer reservoir after removing 2 bolts.



5. Installation is the reverse of removal.

## INSPECTION

1. With the washer motor connected to the reservoir tank, fill the reservoir tank with water.
2. Connect positive (+) and negative (-) battery cables to terminals 1 and 2 respectively to see that the washer motor runs and water sprays from the front nozzles.
3. Check that the motor operates normally.

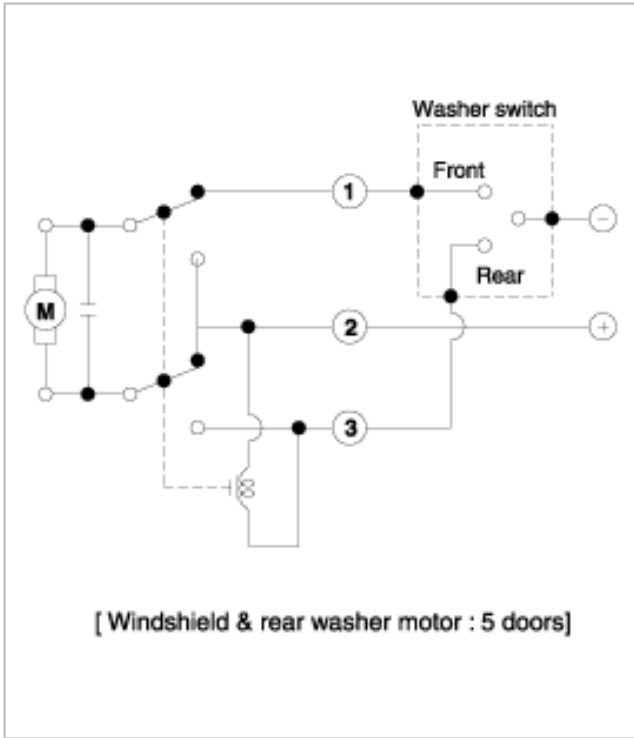
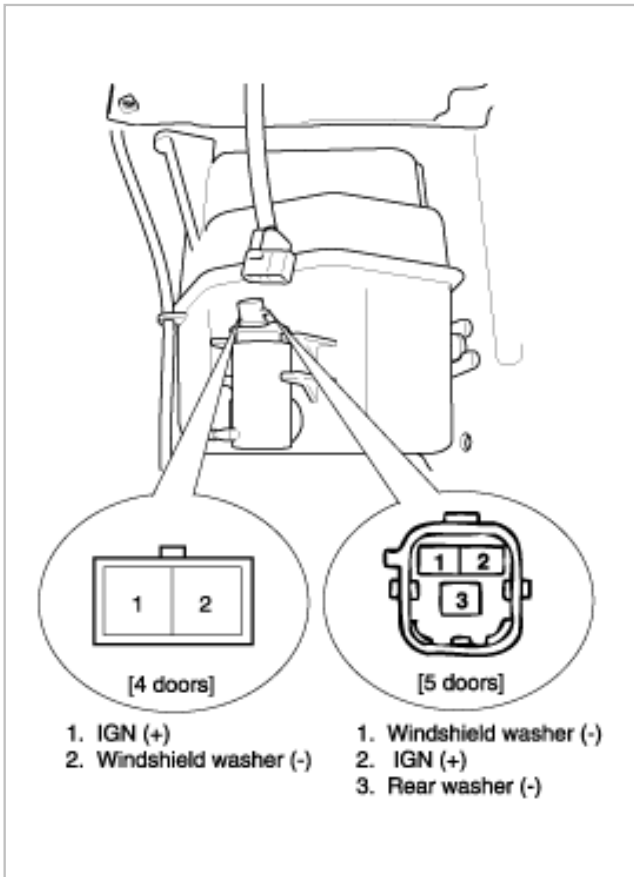

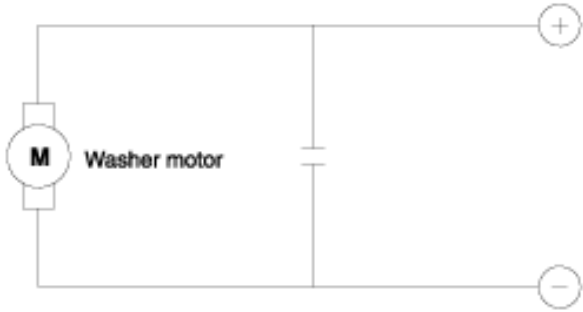

[ Windshield washer motor : 4 doors ]