



INSPECTION

CAUTION

Frequent inhalation of brake pad dust, regardless of material composition, could be hazardous to your health.

- Avoid breathing dust particles.
- Never use an air hose or brush to clean brake assemblies.

NOTE

- Contaminated brake linings or drums reduce stopping ability.
- Block the front wheels before jacking up the rear of the vehicle.

1. Raise the rear of the vehicle, and make sure it is securely supported.
2. Release the parking brake, and remove the rear brake drum (see page BR-39).
3. Check the wheel cylinder (A) for leakage.

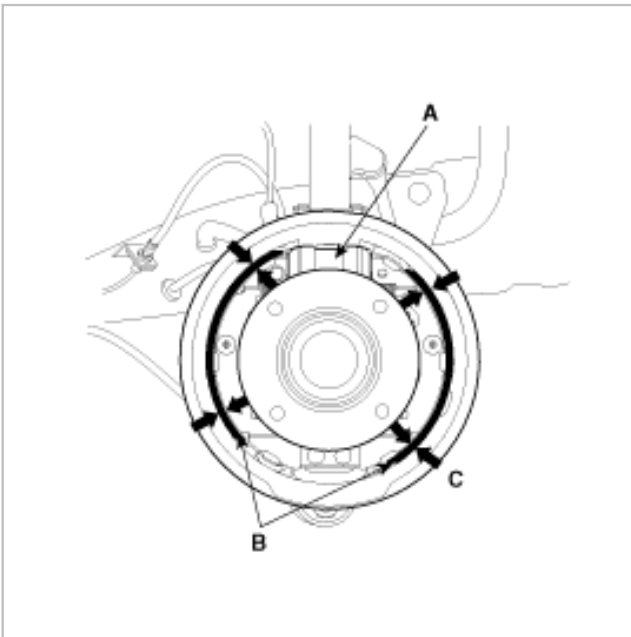

4. Check the brake linings (B) for cracking, glazing, wear, and contamination.
5. Measure the brake lining thickness (C).
Measurement does not include brake shoe thickness.

Brake lining thickness:

4.5 mm (0.177 in.)

1.0 mm (0.039 in.)

6. If the brake lining thickness is less than the service limit, replace the brake shoes as a set.
7. Check the bearings in the hub unit for smooth operation. If it requires servicing, replace it.

8. Measure the inside diameter of the brake drum with inside vernier calipers. Drum inside diameter:

Drum inside diameter:

203.2 mm (8 in.)

205.2 mm (8.079 in.)

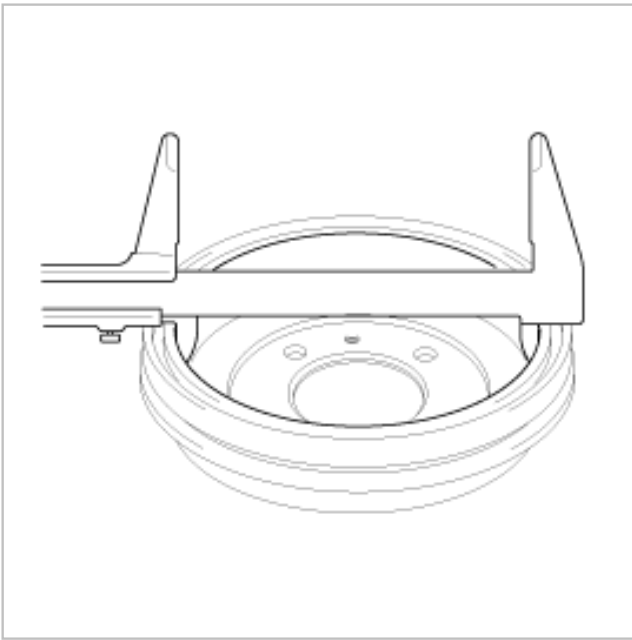

9. If the inside diameter of the brake drum is more than the service limit, replace the brake drum.

10. Check the brake drum for scoring, grooves, and cracks.

REPLACEMENT

Rear brake shoes

CAUTION

Frequent inhalation of brake pad dust, regardless of material composition, could be hazardous to your health.

- Avoid breathing dust particles
- Never use an air hose or brush to clean brake assemblies.

1. Disengage the upper return spring (A).

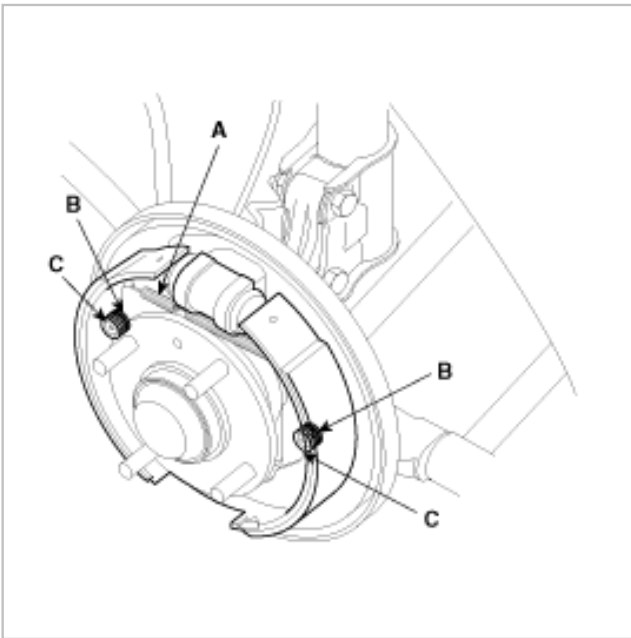

2. Remove the shoe hole down pins (B) by pushing the shoe hole down washer (C) and turning them.
3. Lower the brake shoe assembly (A), and remove the lower return spring (B). Make sure not to damage the dust cover on the wheel cylinder.

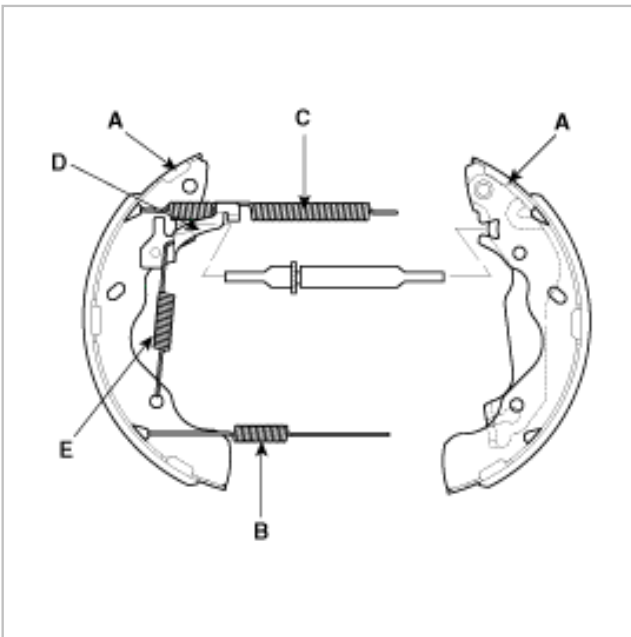

4. Disconnect the parking brake cable from the parking brake lever.
5. Remove the brake shoe assembly.
6. Remove the upper return spring (C), self-adjuster lever (D) and self-adjuster spring (E), and separate the brake shoes.
7. Connect the parking brake cable to the parking brake lever.

8. Clean the threaded portions of adjuster sleeve (A) and push rod female (B). Coat the threads of the adjuster assembly with grease (Castrol grease K764).

To shorten the clevises, turn the adjuster bolt (C).

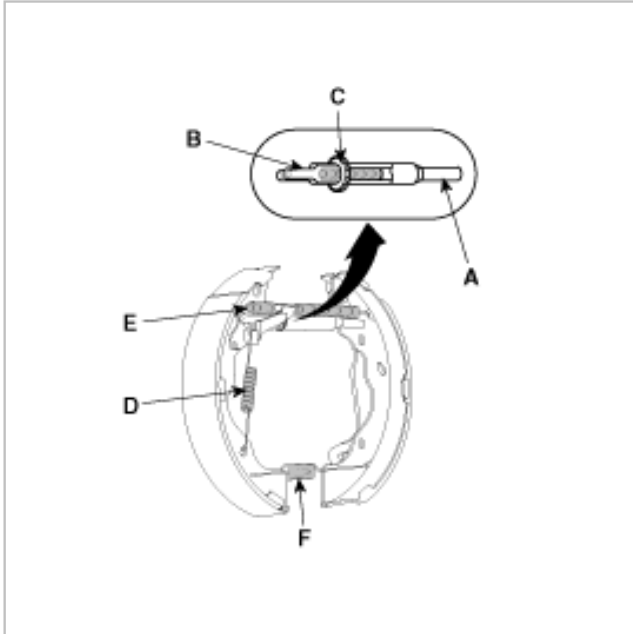

9. Hook the self-adjuster spring (D) to the adjuster lever first, then to the brake shoe.

10. Install the adjuster assembly and upper return spring (E), noting the installation direction. Be careful not to damage the wheel cylinder dust covers.

11. Install the lower return spring (F).

12. Apply brake cylinder grease or equivalent rubber grease to the sliding surfaces shown. Wipe off any excess, Don't get grease on the brake linings.

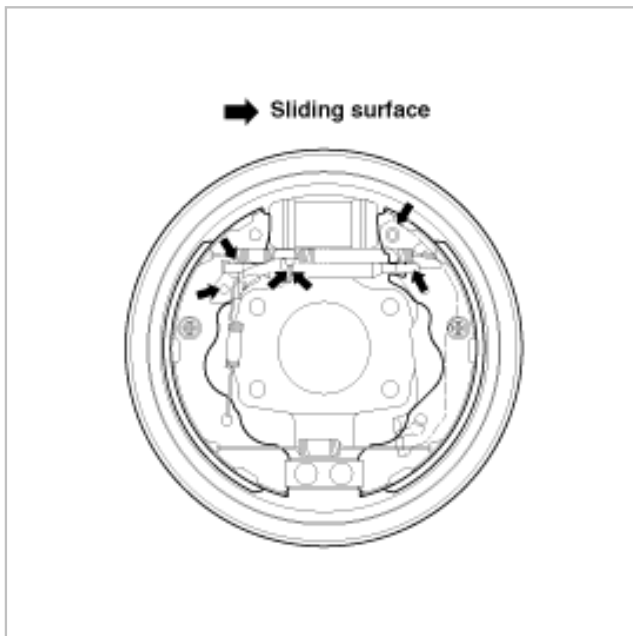

13. Apply Nyogel 744MS to the brake shoe ends and opposite edges of the shoes shown. Wipe off any excess. Don't get grease on the brake linings.

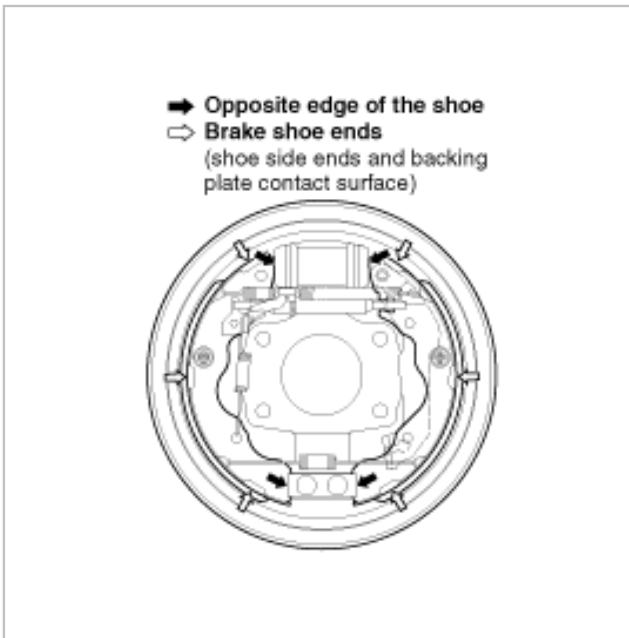

14. Install the brake shoes (A) onto the backing plate. Be careful not to damage the wheel cylinder dust covers.

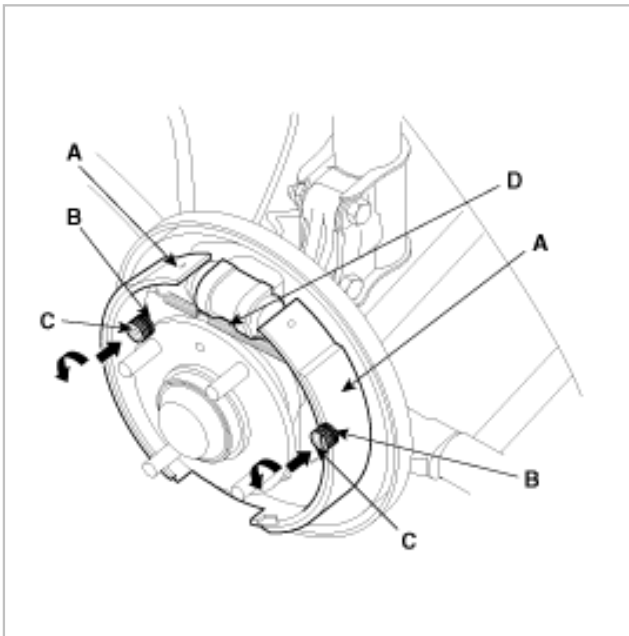

15. Install the shoe hole down pins (B) and the shoe hole down washers (C).
16. Hook the upper return spring (D).
17. Install the brake drum.
18. If the wheel cylinder has been removed, bleed the brake system (see page BR-12).
19. Depress the brake pedal several times to set the self-adjusting brake.
20. Adjust the parking brake (see page BR-11).

Rear wheel cylinder

NOTE

- Do not spill brake fluid on the vehicle: it may damage the paint; if brake fluid does contact the paint. Wash it off immediately with water.
- To prevent spills, cover the hose joints with rags or shop towels.
- Use only a genuine wheel cylinder special bolt.

1. Remove the brake shoes (see page BR-39).
2. Disconnect the brake line (A) from the wheel cylinder (B).

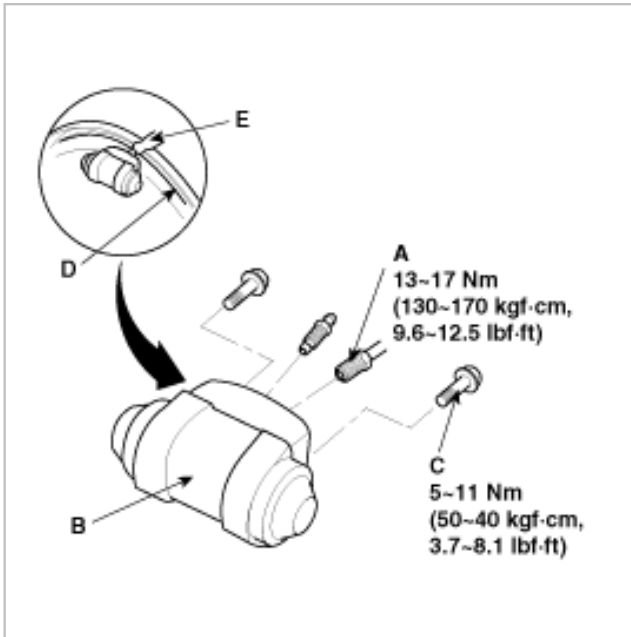

3. Remove the bolt (C) and the wheel cylinder from the backing plate.
4. Apply sealant (E) between the wheel cylinder (B) and backing plate (D), and install the wheel cylinder.
5. Install the removed parts in the reverse order of removal.
6. Fill the brake reservoir up and, bleed the brake system (see page BR-12)
7. After installation, check for a leak at the line joint, and retighten if necessary.