

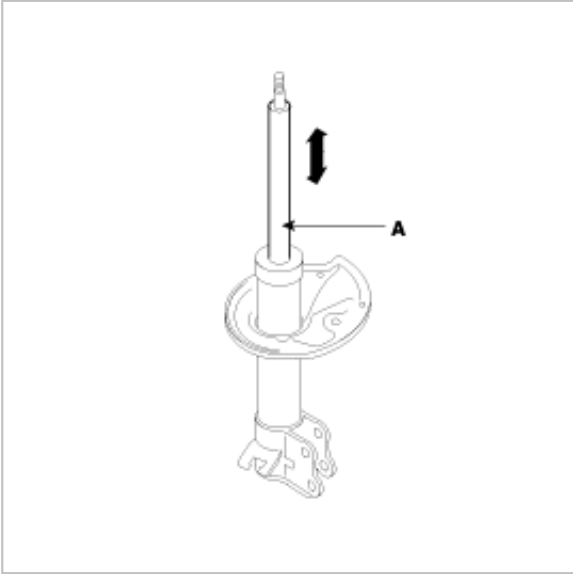

## INSPECTION

1. Check the strut insulator for wear or damage.
2. Check rubber parts for damage or deterioration.
3. Check the coil spring and strut assembly for sagging and deformation.
4. Compress and extend the piston rod(A) and check that there is no abnormal resistance or unusual sound during operating.



## DISASSEMBLY

1. Using the Special Tools (J38402, A-20 and A-50), compress the coil spring(A) until there is only a little tension on the strut (B).

### CAUTION

Do not use an impact gun.

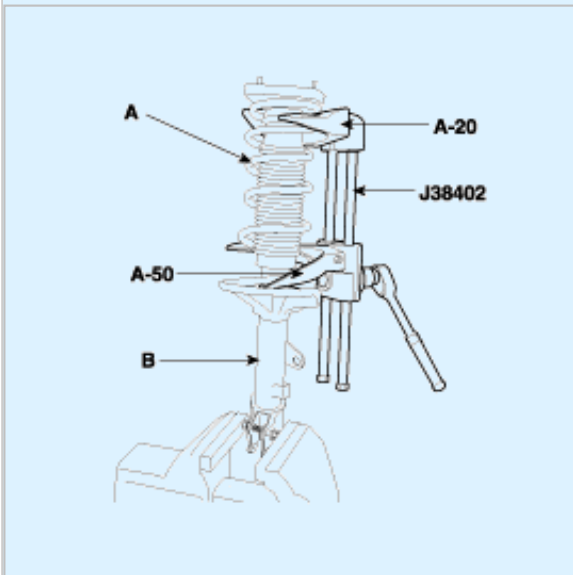

2. Open the insulator dust cover and then remove the self-locking nut at the top end of the upper strut.
3. Remove the spring upper seat, coil spring, spring lower pad, rubber bumper and dust cover.

## REASSEMBLY

1. Install the spring lower pad(D) so that the protrusions(A) fit in the holes(C) in the spring lower seat(B).

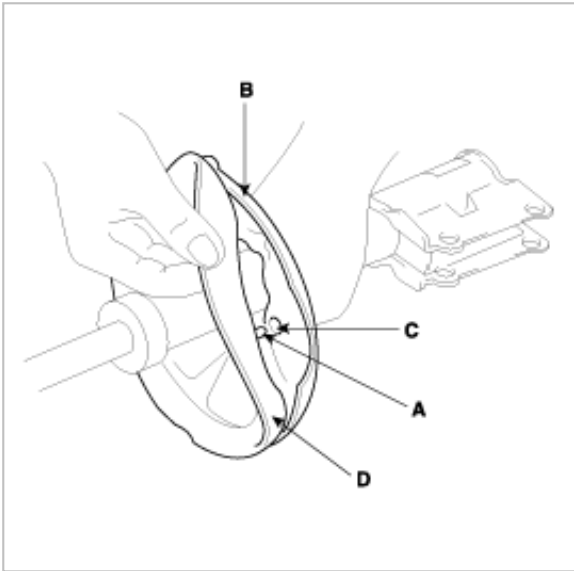

2. Install the dust cover and rubber bump at the strut.
3. Using the Special Tools (J38402, A - 20 and A - 50), compress the coil spring(A).

**CAUTION**

Do not use an impact gun.

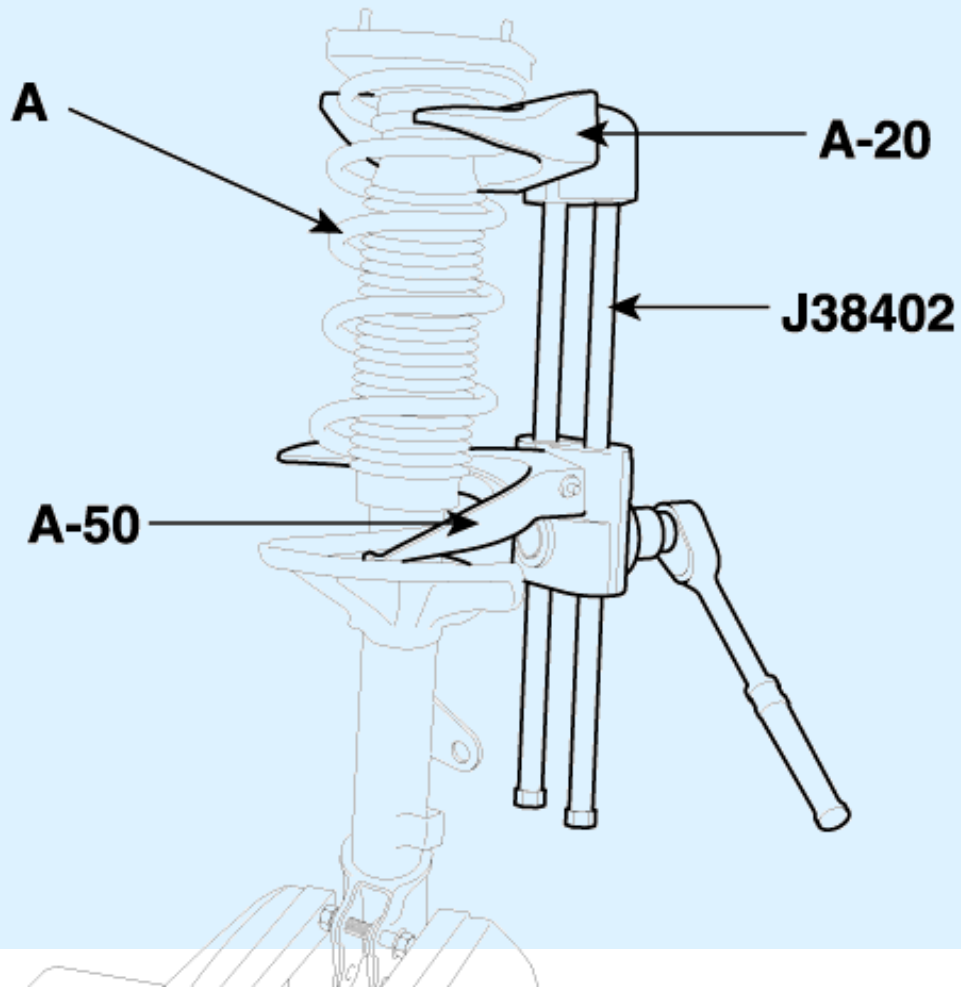



4. After extending the piston rod fully, install the compressed coil spring.
5. After seating the upper and lower ends of the coil spring in the upper and lower spring seat grooves correctly, tighten the new self-locking nut temporarily.

#### CAUTION

Replace the self-locking nut with new ones after removal.

6. After aligning the hole(A) of the lower spring seat with projection part(B) of the rear insulator, assemble them.

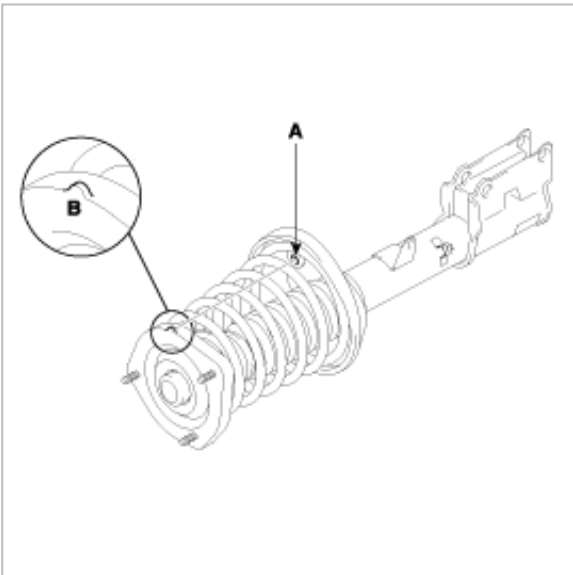

#### NOTE

The spring identification color mark should face down.

7. Remove the Special tool (J38402, A-20 and A-50).
8. Tighten the self-locking nut to the specified torque.

#### Tightening torque

40~55 Nm (400~550 kgf.cm, 29.6~40.7 lbf.ft)

## REMOVAL

1. Remove the rear seat (See BD group - rear seat).
  - (1) Raise the rear cushion.
  - (2) Remove the mounting bolts between rear cushion and rear seatback.
  - (3) Remove the mounting bolts to both end part of rear seatback.

2. Remove the rear strut upper mounting nuts(A).

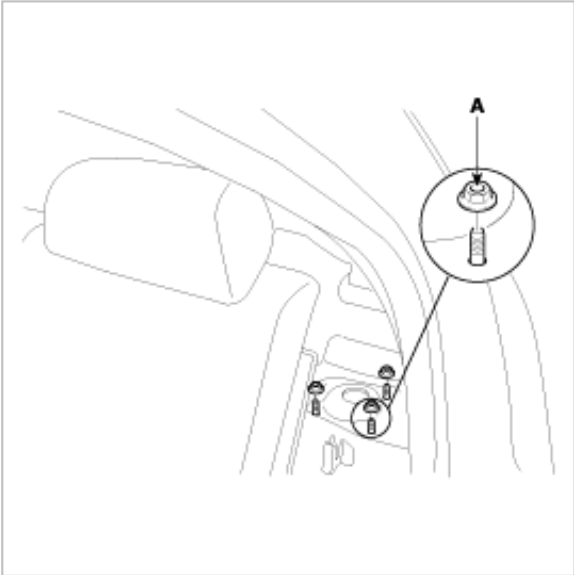

3. Remove the rear wheel and tire.

4. Disconnect the brake hose(B) and wheel speed sensor wiring(C) from the rear strut(A).

(1) Disconnect the brake hose(B) by removing the clip(D)

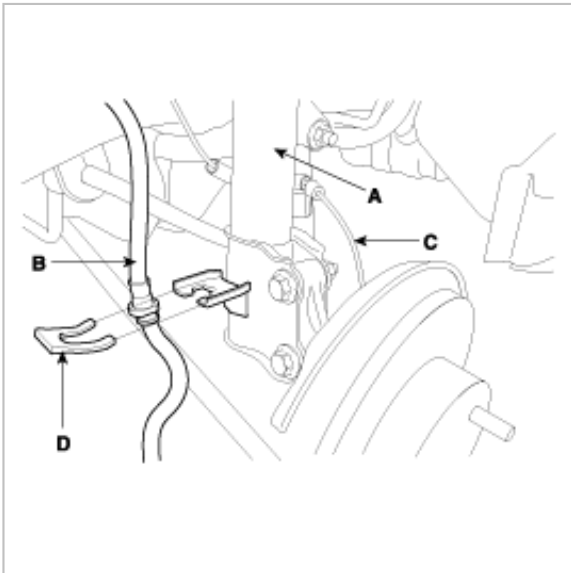

(2) Disconnect the wheel speed sensor wiring(A).

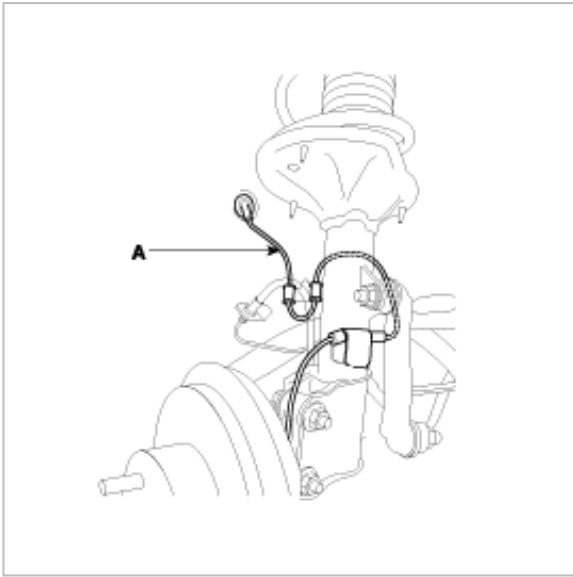

5. After unfastening stabilizer bar link nut(C), remove the stabilizer bar link(B) from the strut(A).

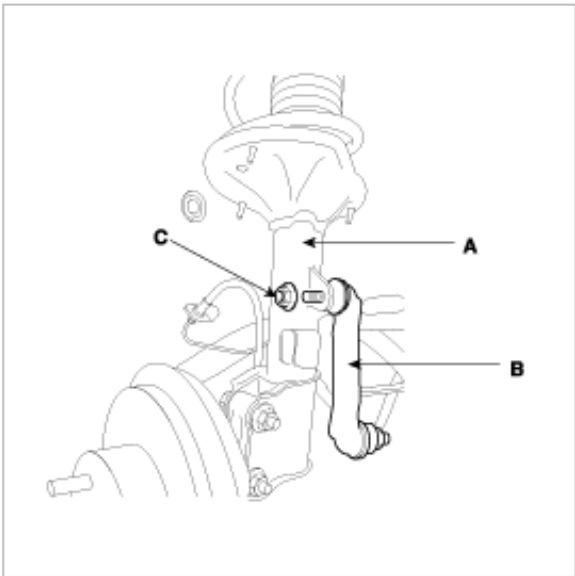

6. Remove the lower strut mounting bolts(A).

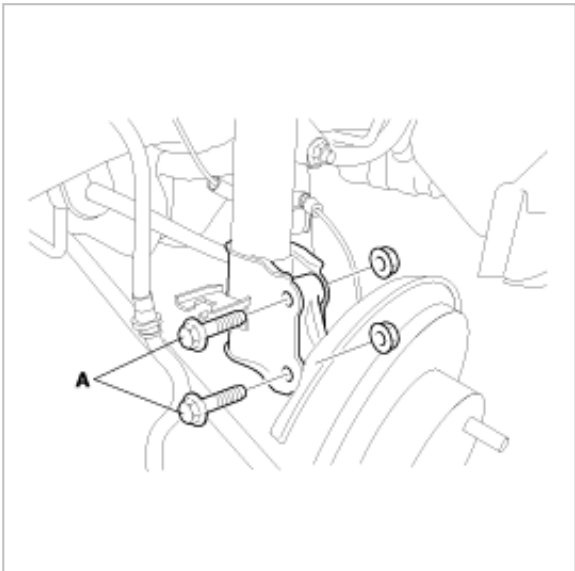

**CAUTION**

Be careful not to drop the rear strut.

7. Remove the rear strut assembly.